

1100	ABUT. BRG. ELEV. = 1089.30	CL PIER 1 ELEV. = 1088.75	CL PIER 2 ELEV. = 1088.04	ABUT. BRG. ELEV. = 1087.49	1100
1090	LOW STEP ELEV. = 1084.52	LOW STEP ELEV. = 1082.72	LOW STEP ELEV. = 1082.01	LOW STEP ELEV. = 1082.71	1090
1080					1080
1070	BOTT. OF FOOTING ELEV. = 1081.02			BOTT. OF FOOTING ELEV. = 1079.21	1070
1060	BERM ELEV. = 1083.02	BOTT. OF CAP ELEV. = 1078.72	STREAM BED ELEV. = 1066.76	BOTT. OF CAP ELEV. = 1078.01	1060
1050	ELEV. = 1072.00		DESIGN HIGH WATER ELEV. = 1078.26	ELEV. = 1072.00	1050

BENCH MARK NO.: CUT "X" TOP CONC. BARRIER RAIL @ N.W. CORNER HWY. #3 BRIDGE OVER MAQUOKETA RIVER.

PROPOSED PROFILE

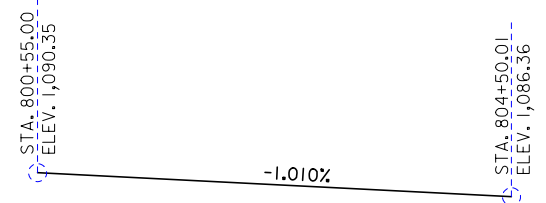

LONGITUDINAL SECTION ALONG CL BRIDGE

- 1 REGULATORY LOW SUPERSTRUCTURE ELEV. = 1084.15
- 2 OPERATIONAL LOW SUPERSTRUCTURE ELEV. = 1082.98

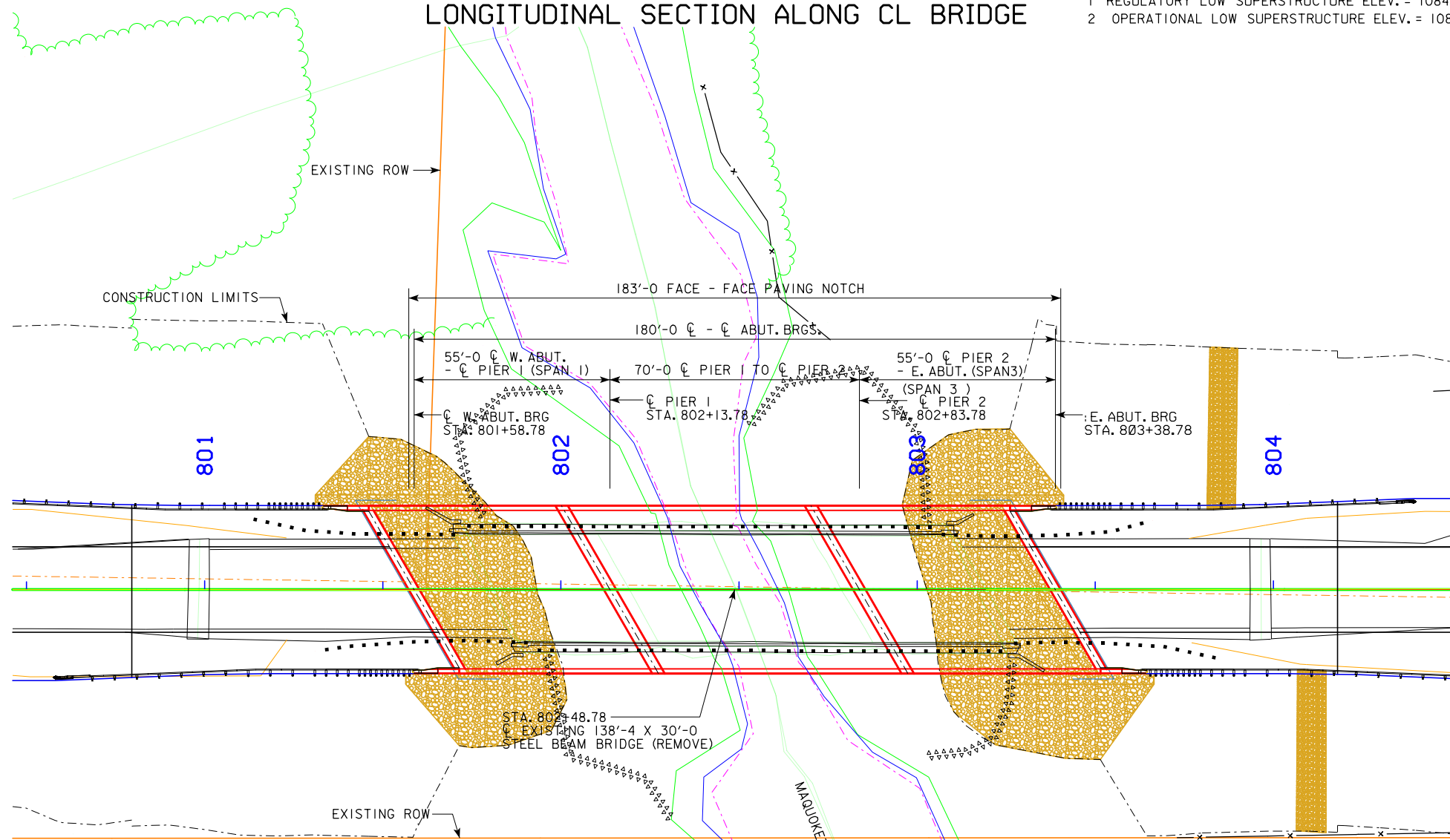

HYDRAULIC DATA

DRAINAGE AREA = 18.1 SQ. MI.
 STREAM SLOPE = 9.31 FT./MI.
 AVG. LOW WATER STAGE = 1068.56

Q₂₅ = 4,210 CFS
 STAGE = 1076.63

Q₉₀ = 5,170 CFS
 STAGE = 1077.34
 BACKWATER = 0.88 FT.
 AVG. BRIDGE VELOCITY = 8.50 FPS

Q₁₀₀ = 6,110 CFS
 STAGE = 1078.22
 BACKWATER = 1.19 FT.
 AVG. BRIDGE VELOCITY = 9.26 FPS

Q₂₀₀ = 7,910 CFS
 STAGE = 1079.61

Q₅₀₀ = 8,660 CFS
 STAGE = 1080.14

LOCATION

IA 3 OVER MAQUOKETA RIVER
 T-91N R-07W
 SECTION 13/24
 WATERLOO TOWNSHIP
 FAYETTE COUNTY
 FHWA NO. 024550
 BRIDGE MAINT. NO. 3368.2S003
 LATITUDE 42.6876263°
 LONGITUDE -091.6119258°

TYPICAL APPROACH SECTION

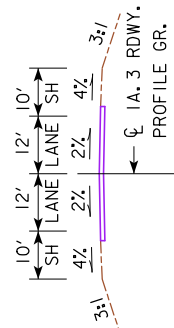

TRAFFIC ESTIMATE

2020 DHV 2,150 V.P.D.
 TRUCKS 22 %



SITUATION PLAN

DESIGN FOR 30° SKEW (R.A.)
**180'-0" x 44'-0" PRETENSIONED
 PRESTRESSED CONC. BEAM BRIDGE**
 55'-0" END SPANS 70'-0" INTERIOR SPAN

SITUATION PLAN
 STA. 802+48.78 JULY, 2022
FAYETTE COUNTY
 IOWA DEPARTMENT OF TRANSPORTATION
 DESIGN SHEET NO. 2 OF 4 FILE NO. ? DESIGN NO. 325

NOTES
 CLASS 'E' REVELTMENT IS EMBEDDED
 ALL DIMENSIONS ARE HORIZONTAL UNLESS OTHERWISE NOTED.
 ALL UNITS ARE IN FEET UNLESS NOTED OTHERWISE.

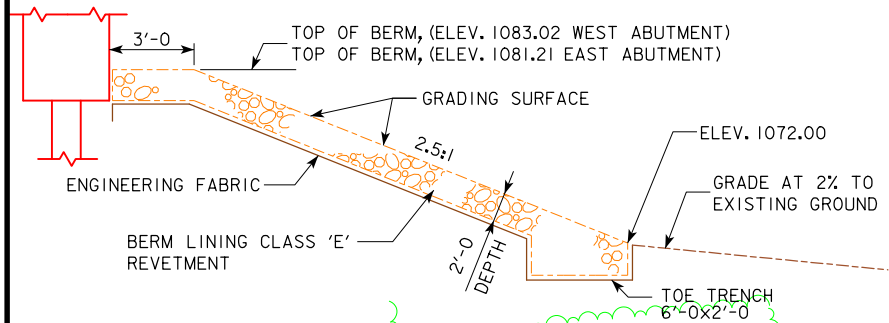

TYP. EMBEDDED RIPRAP AT ABUTMENT/CHANNEL

BERM SLOPE LOCATION TABLE			
POINTS	WEST ABUTMENT		
	STATION	OFFSET	ELEV.
A1	801+76.80	26.58 LT	1072.00
A2	802+01.03	26.58 RT	1072.00
B1	801+47.93	26.58 LT	1083.02
B2	801+78.62	26.58 RT	1083.02
W1	801+31.08	26.58 LT	
W2	801+56.48	26.58 RT	

BERM SLOPE LOCATION TABLE			
POINTS	EAST ABUTMENT		
	STATION	OFFSET	ELEV.
A1	802+96.51	26.58 LT	1072.00
A2	803+07.09	26.58 RT	1072.00
B1	803+18.47	26.58 LT	1081.21
B2	803+49.16	26.58 RT	1081.21
W1	803+41.07	26.58 LT	
W2	803+66.48	26.58 RT	

GRADING/REVTMENT LIMITS						
POINTS	SOUTH ABUTMENT			NORTH ABUTMENT		
	STATION	OFFSET	ELEV.	STATION	OFFSET	ELEV.
G1	801+33.08	74.69 LT	1073.60	803+33.08	76.12 LT	1072.69
G2	801+46.09	43.00 LT	1081.33	801+46.09	45.11 LT	1078.48
G3	801+71.49	43.86 RT	1081.04	801+71.49	47.72 RT	1078.43
G4	801+58.48	69.54 RT	1075.06	801+58.48	69.20 RT	1073.07

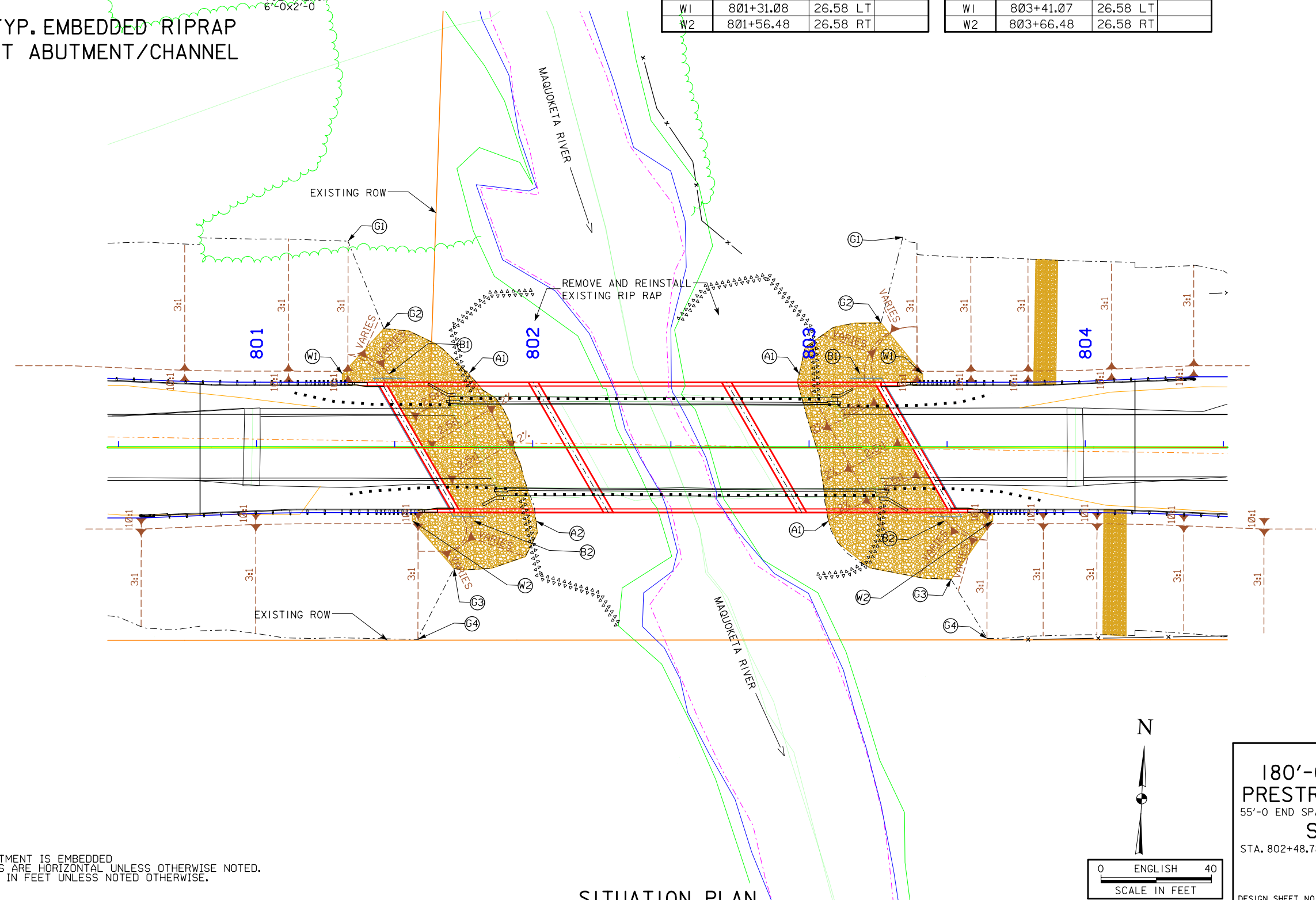

SITUATION PLAN

NOTES
 CLASS 'E' REVETMENT IS EMBEDDED
 ALL DIMENSIONS ARE HORIZONTAL UNLESS OTHERWISE NOTED.
 ALL UNITS ARE IN FEET UNLESS NOTED OTHERWISE.

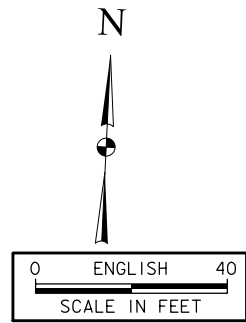

DESIGN FOR 30° SKEW (R.A.)
**180'-0" x 44'-0" PRETENSIONED
 PRESTRESSED CONC. BEAM BRIDGE**
 55'-0" END SPANS 70'-0" INTERIOR SPAN
SITUATION SITE PLAN
 STA. 802+48.78 JULY, 2022
FAYETTE COUNTY
 IOWA DEPARTMENT OF TRANSPORTATION
 DESIGN SHEET NO. 3 OF 4 FILE NO. ? DESIGN NO. 325

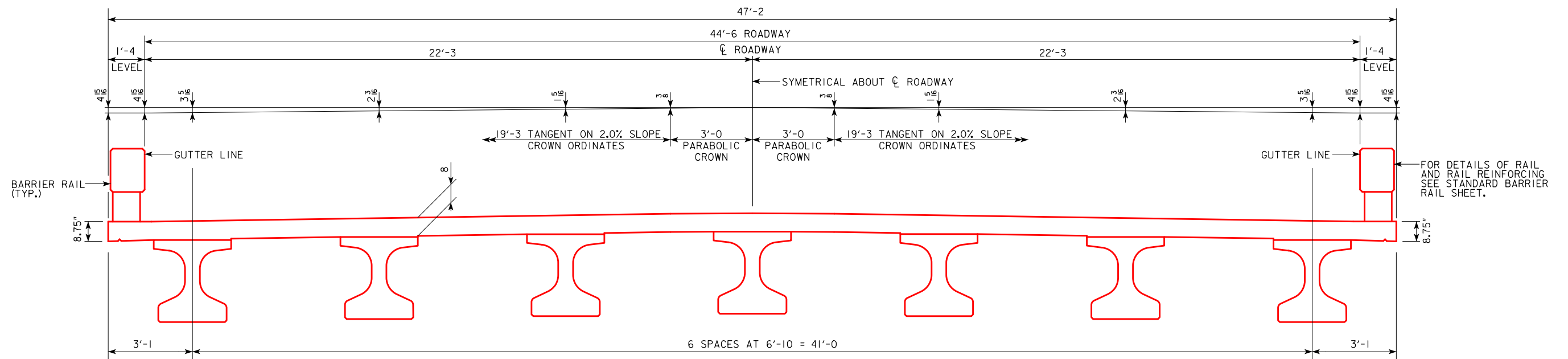

NEW SECTION NEAR ABUTMENT

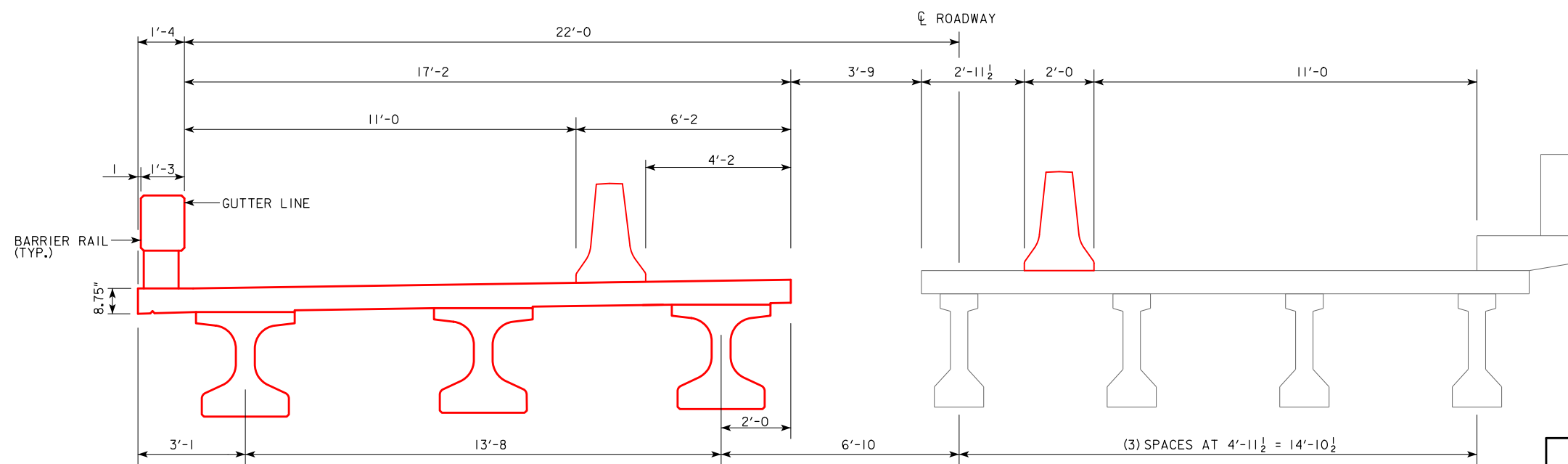

STAGING SECTION NEAR ABUTMENT

DESIGN FOR 30° SKEW (R.A.)
**180'-0" x 44'-0" PRETENSIONED
 PRESTRESSED CONC. BEAM BRIDGE**
 55'-0" END SPANS 70'-0" INTERIOR SPAN
TRANSVERSE SECTION
 STA. 802+48.78 JULY, 2022
FAYETTE COUNTY
 IOWA DEPARTMENT OF TRANSPORTATION
 DESIGN SHEET NO. 4 OF 4 FILE NO. ? DESIGN NO. 325

Paved Shoulder at Guardrail

PCC Shoulder Jointing:
 Longitudinal joint: BT-1 or BT-5
 Transverse joints: C at mainline spacing
 HMA Shoulder Jointing:
 Longitudinal joint: B

2_P_Guard_04-21-20		
STATION TO STATION	(P)	Feet
800+25.00	800+32.77	13.57
800+32.77	800+83.64	Varies
800+83.64	801+46.08	11.58
803+26.08	803+79.35	11.58
803+79.35	804+39.38	Varies
804+39.38	804+59.38	13.57

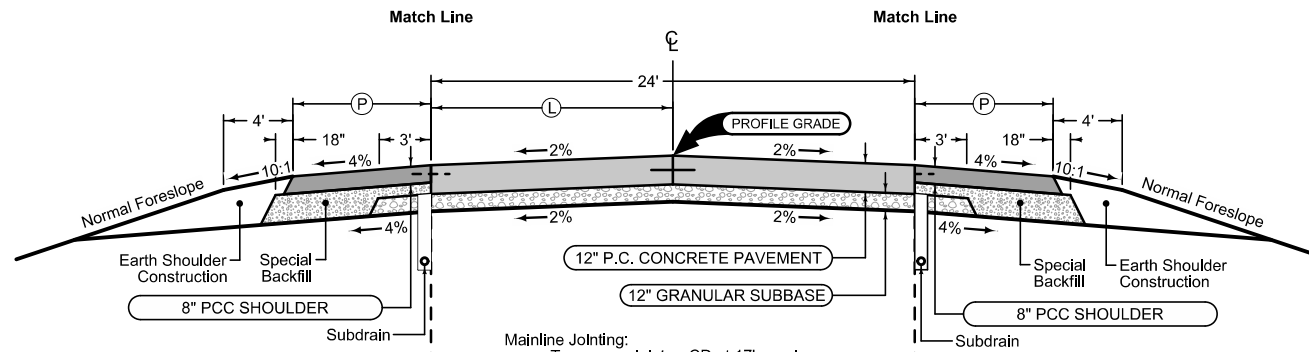

Mainline Jointing:
 Transverse joints: CD at 17' spacing
 Longitudinal joint: L-2

2P_04-21-20			
STATION TO STATION	(L)	(R)	Feet
800+25.00	801+58.78	12	12
803+38.78	804+70.00	12	12

Paved Shoulder at Guardrail

PCC Shoulder Jointing:
 Longitudinal joint: BT-1 or BT-5
 Transverse joints: C at mainline spacing
 HMA Shoulder Jointing:
 Longitudinal joint: B

2_P_Guard_04-21-20		
STATION TO STATION	(P)	Feet
800+38.18	800+58.18	13.57
800+58.18	801+18.21	Varies
801+18.21	801+71.48	11.58
803+51.48	804+04.25	11.58
804+04.25	804+64.79	Varies
804+64.79	804+70.00	13.57

Combination Shoulder

Shoulder Jointing:
 Longitudinal joint: B

2_C_04-21-20			
STATION TO STATION	(P)	(G)	Feet
804+59.38	804+70.00	4	4

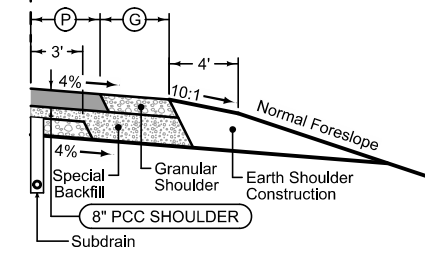
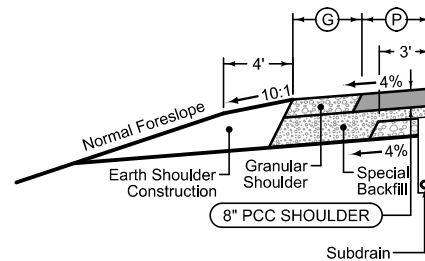

Combination Shoulder

Shoulder Jointing:
 Longitudinal joint: B

2_C_04-21-20			
STATION TO STATION	(P)	(G)	Feet
800+25.00	800+38.18	4	4

Paved Shoulder at Guardrail

PCC Shoulder Jointing:
 Longitudinal joint: BT-1 or BT-5
 Transverse joints: C at mainline spacing
 HMA Shoulder Jointing:
 Longitudinal joint: B

2_P_Guard_04-21-20		
STATION TO STATION	(P)	Feet
800+12.77	800+25.00	13.57

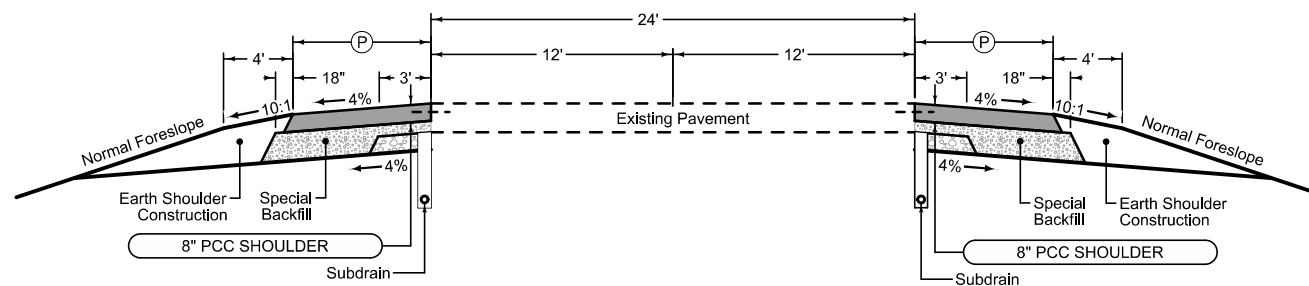

Paved Shoulder at Guardrail

PCC Shoulder Jointing:
 Longitudinal joint: BT-1 or BT-5
 Transverse joints: C at mainline spacing
 HMA Shoulder Jointing:
 Longitudinal joint: B

2_P_Guard_04-21-20		
STATION TO STATION	(P)	Feet
804+70.00	804+84.79	13.57

SURVEY SYMBOLS

- | | | | |
|--|-----------------------------------|--|------------------------------|
| | Interstate Highway Symbol | | Septic Tank |
| | U.S. Highway Symbol | | Cistern |
| | Iowa Highway Symbol | | L.P. Gas Tank (No Footing) |
| | County Road Highway Symbol | | Underground Storage Tank |
| | Evergreen Tree | | Latrine |
| | Deciduous Tree | | Satellite TV Dish |
| | Fruit Tree | | Water Hook Up |
| | Shrub (Bushes) | | Radio Tower |
| | Timber | | Tower Anchor |
| | Hedge | | Guardrail (Beam or Cable) |
| | Stump | | Guard Post (one or two) |
| | Swamp | | Guard Post (over two) |
| | Rock Outcrop | | Filler Pipe |
| | Broken Concrete | | Gas Valve |
| | Revetment (Rip Rap) | | Water Valve |
| | Cemetery | | Speed Limit Sign |
| | Grave | | Mile Marker Post |
| | Cave | | Sign |
| | Sink Hole | | Traffic Signal Control Box |
| | Board Fence | | Rail Road Signal Control Box |
| | Chain Link or Security Fence | | Telephone Switch Box |
| | Wire Fence | | Electric Box |
| | Terrace | | |
| | Earth Dam or Dike (Existing) | | |
| | Tile Outlet | | |
| | Edge of Water | | |
| | Existing Drainage | | |
| | Right of Way Rail or Lot Corner | | |
| | Concrete Monument | | |
| | Well | | |
| | Windmill | | |
| | Beehive Intake | | |
| | Existing Intake | | |
| | Existing Utility Access (Manhole) | | |
| | Fire Hydrant | | |
| | Water Hydrant (Rural) | | |

UTILITY LEGEND

PLAN VIEW COLOR LEGEND OF PLAN AND PROFILE SHEETS

LINEWORK		Design Color No.	
Green	(2)		Existing Topographic Features and Labels
Blue	(1)		Proposed Alignment, Stationing, Tic Marks, and Alignment Annotation
Magenta	(5)		Existing Utilities
SHADING		Design Color No.	
Lavender	(9)		Temporary Pavement Shading
Yellow	(4)		Proposed Pavement Shading
Orange	(6)		Proposed Granular Shading
Orange	(70)		Proposed Shoulder Granular Shading
Yellow	(68)		Proposed Shoulder Paved Full Depth Shading
Yellow	(132)		Proposed Shoulder Paved Partial Depth Shading
Gray, Dark	(112)		Proposed Grade and Pave Shading "In conjunction with a paving project"
Brown, Light	(236)		Grading Shading
Orange, Light	(134)		Proposed Granular Entrance Shading
Yellow	(220)		Proposed Paved Entrance Shading
Tan	(8)		Proposed Sidewalk Shading
Blue, Light	(230)		Proposed Sidewalk Landing Shading
Pink	(11)		Proposed Sidewalk Ramp Shading
Green, Light	(225)		Existing Pavement Shading
Red	(3)		Proposed Structure Shading

PROFILE VIEW COLOR LEGEND OF PLAN AND PROFILE SHEETS

LINEWORK		Design Color No.	
Green	(2)		Existing Ground Line Profile
Blue	(1)		Proposed Profile and Annotation
Magenta	(5)		Existing Utilities
Blue, Light	(230)		Proposed Ditch Grades, Left
Black	(0)		Proposed Ditch Grades, Median
Rust	(14)		Proposed Ditch Grades, Right

- | | | | |
|--|-----------------------------|--|--------------------------|
| | Reference Point | | Survey Line |
| | Station | | Section Corner |
| | Ground Line Intercept | | Saw Cut |
| | Guardrail | | Trench Drain |
| | HighTension Cable Guardrail | | Sheet Pile |
| | Pavement Removal | | Clearing & Grubbing Area |

- ### RIGHT-OF-WAY LEGEND
- -
 -
 -
 -
 -
 -
 -

PLAN AND PROFILE LEGEND AND SYMBOL INFORMATION SHEET

(COVERS SHEET SERIES D, E, F, & K)

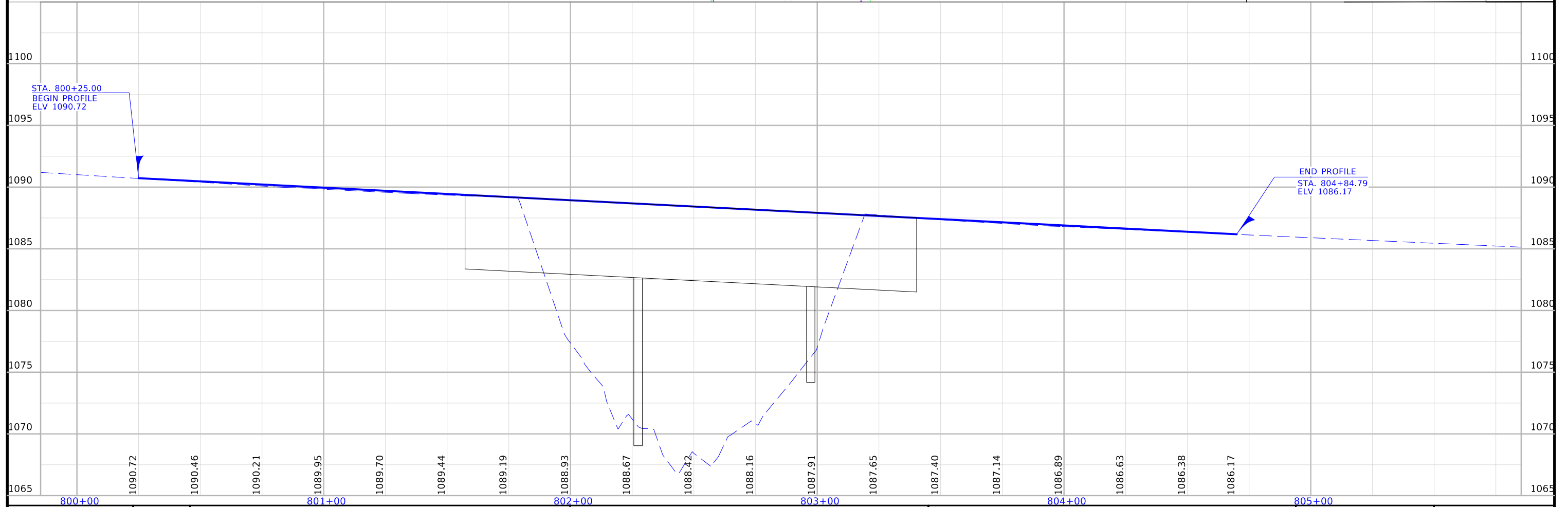
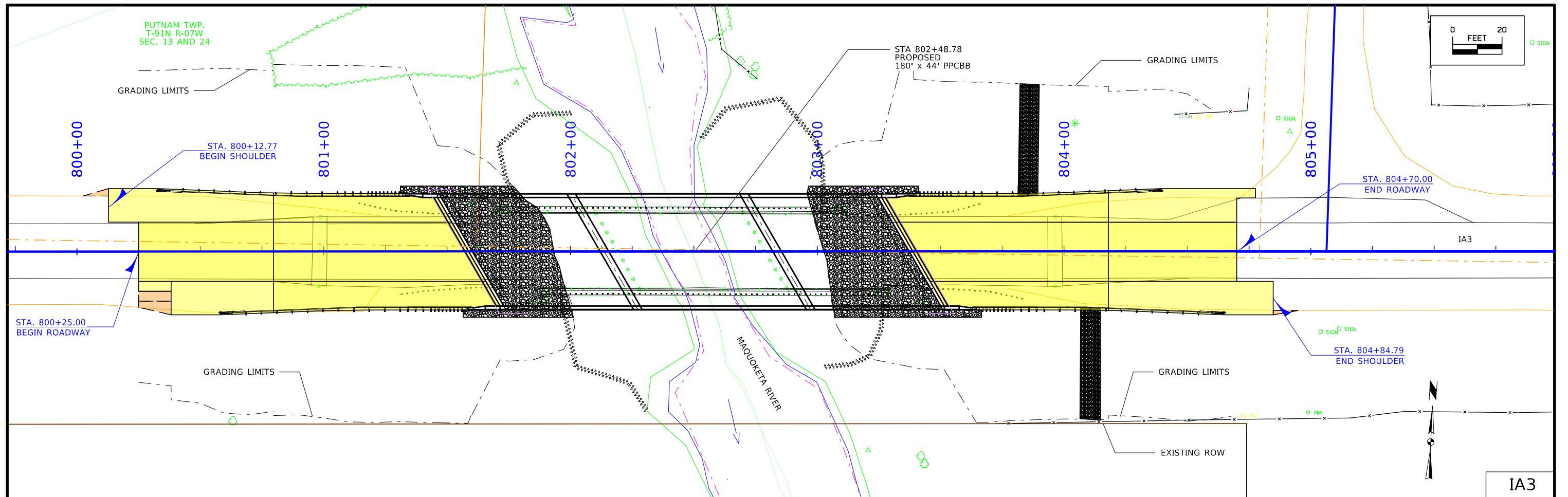

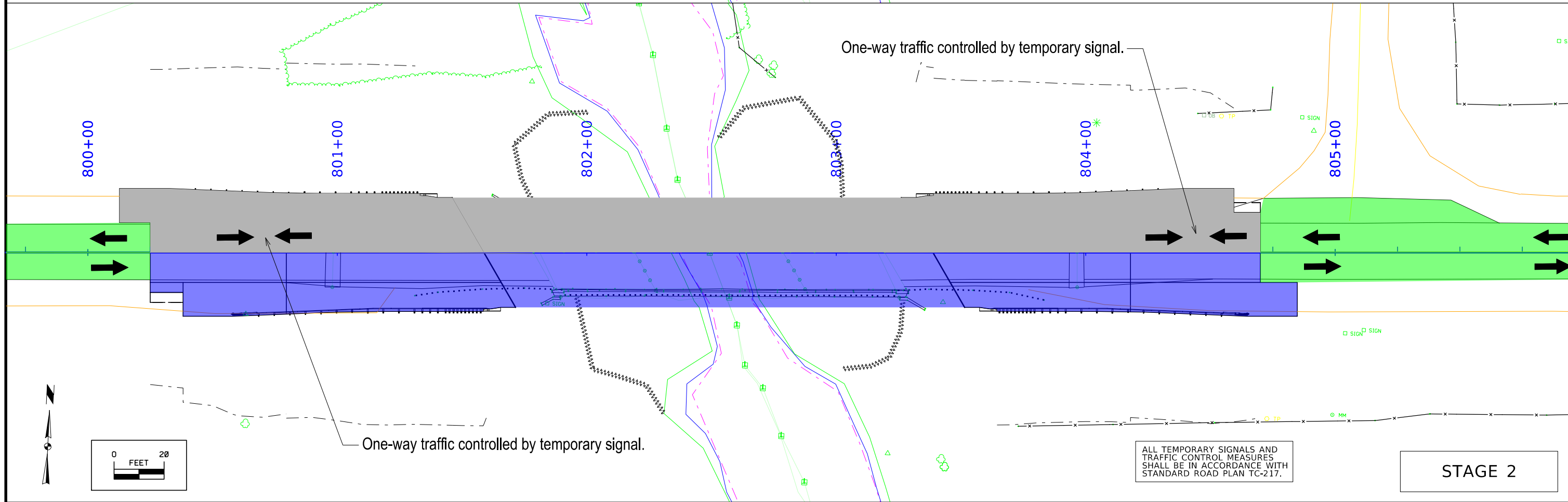
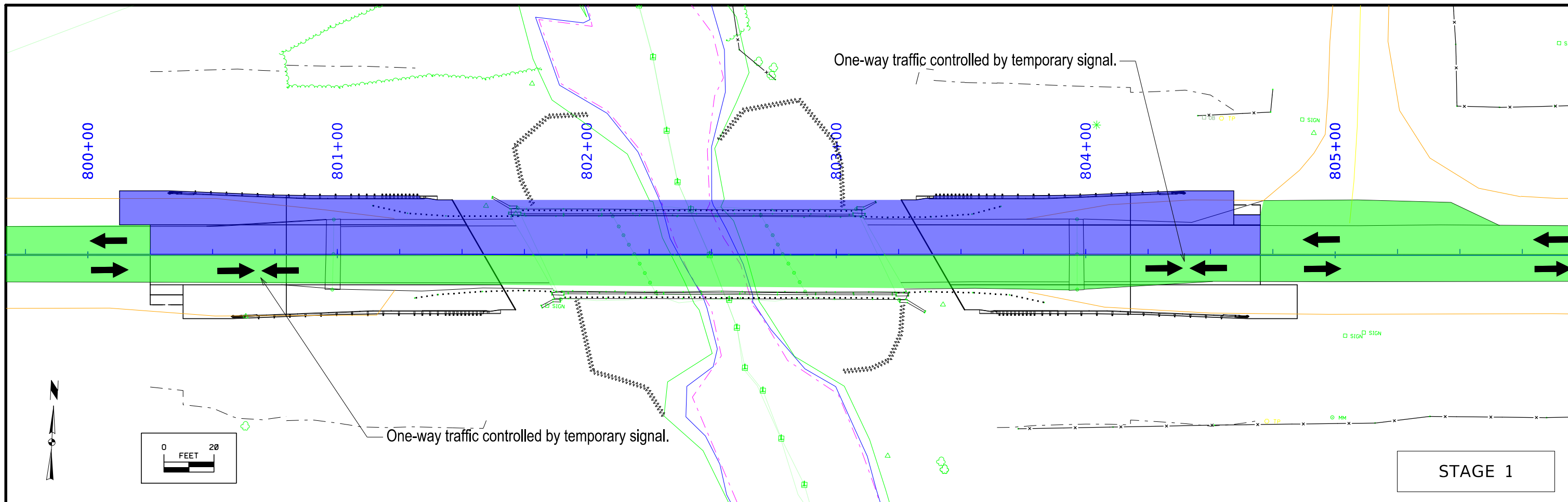

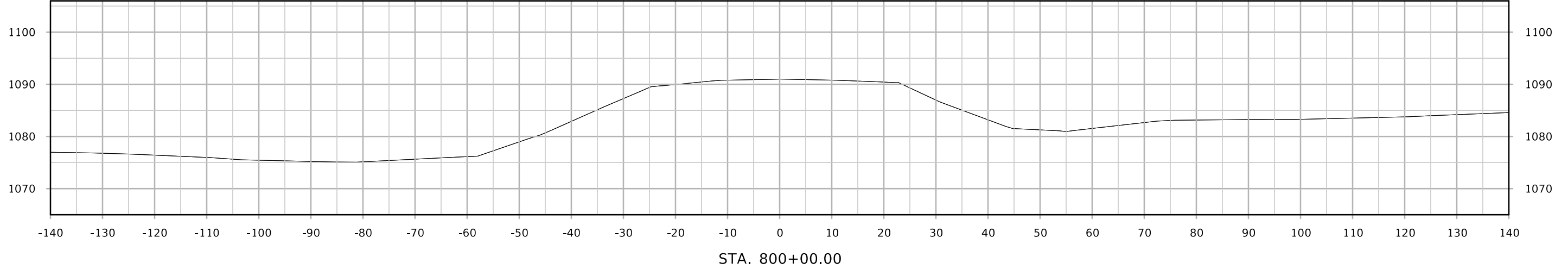
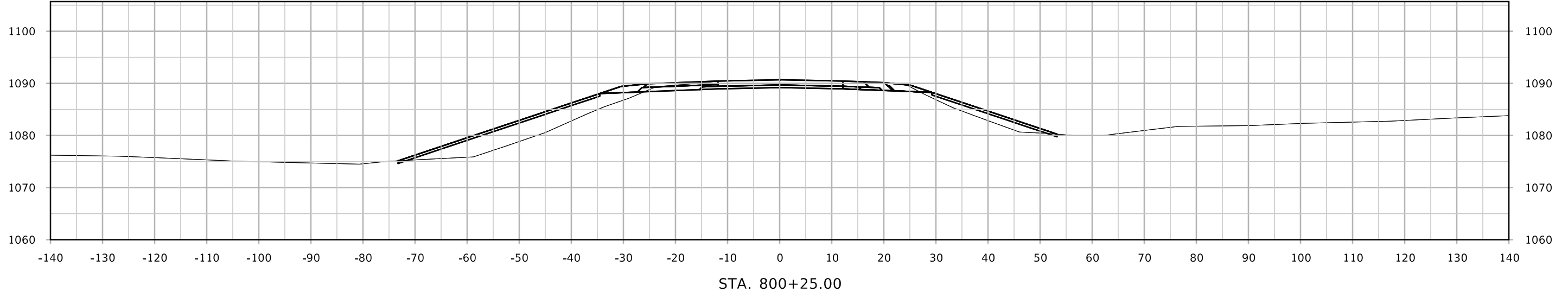
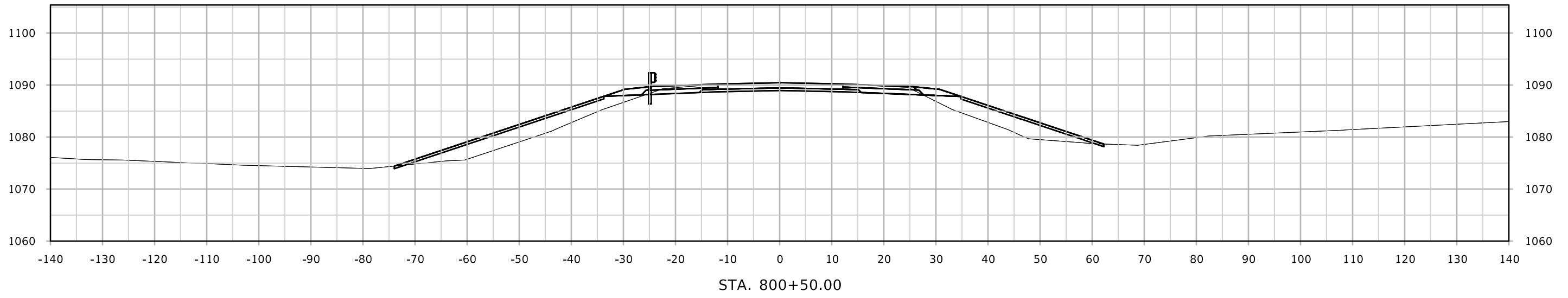

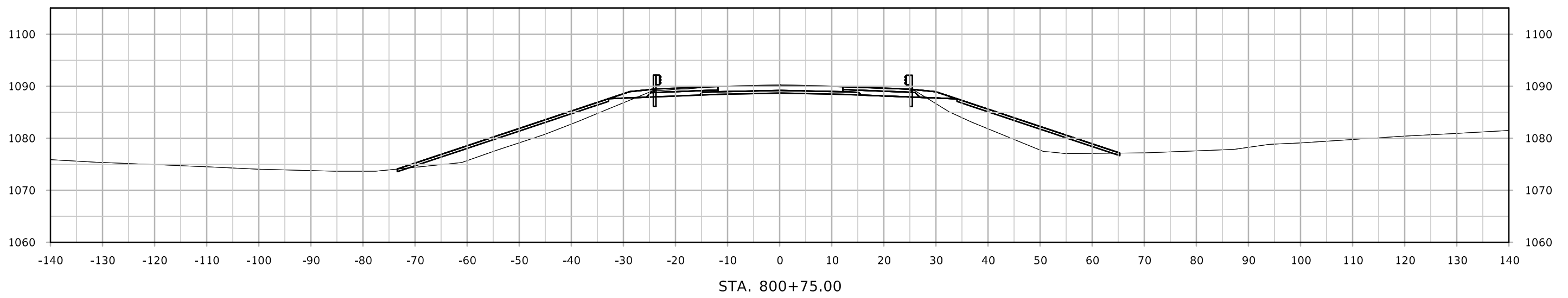
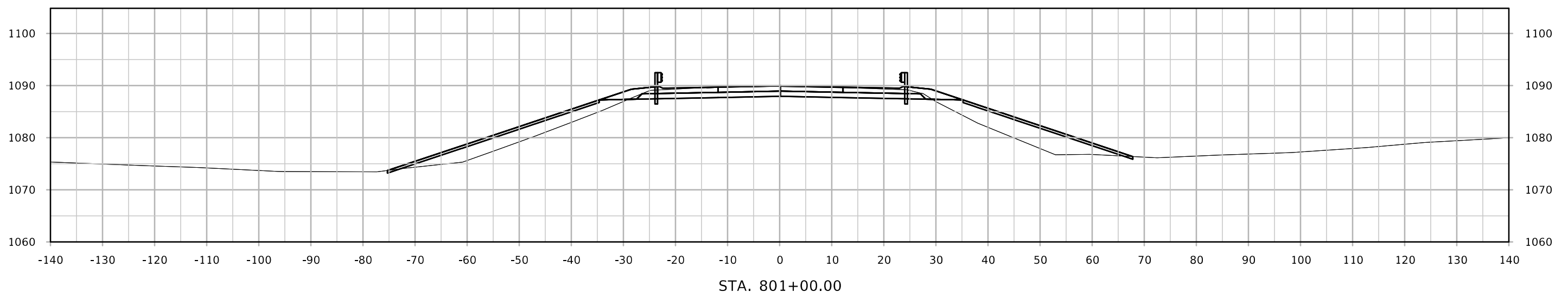
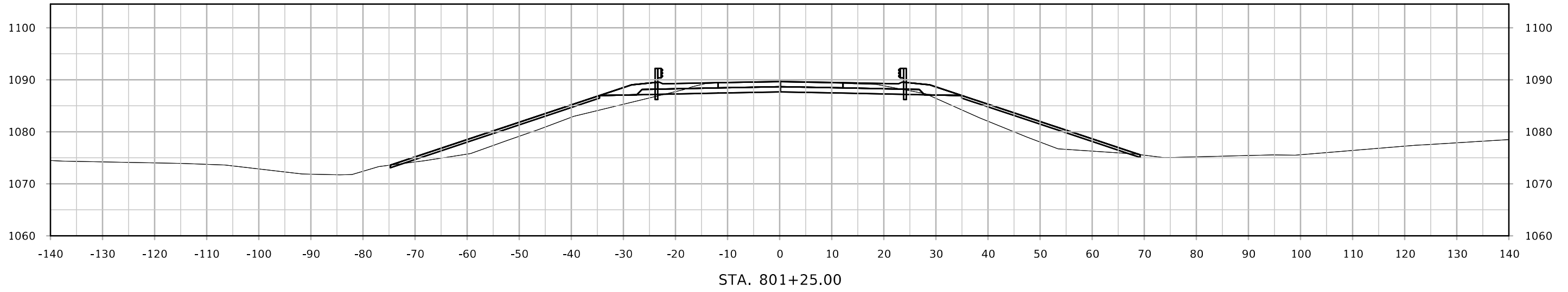

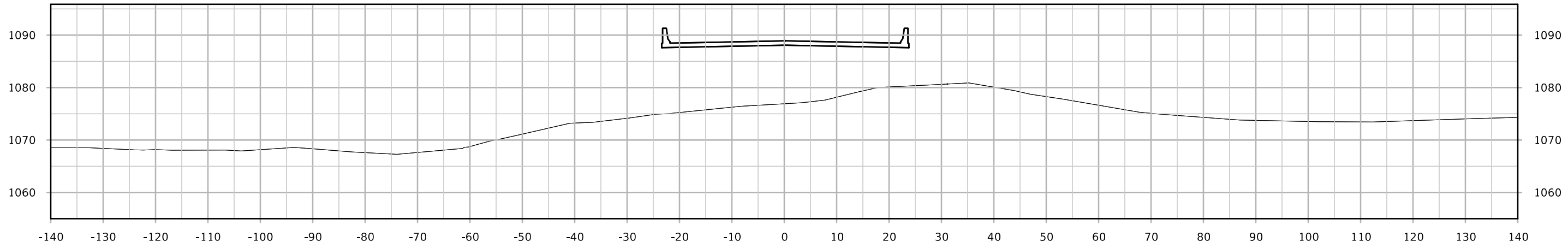

STA. 802+00.00

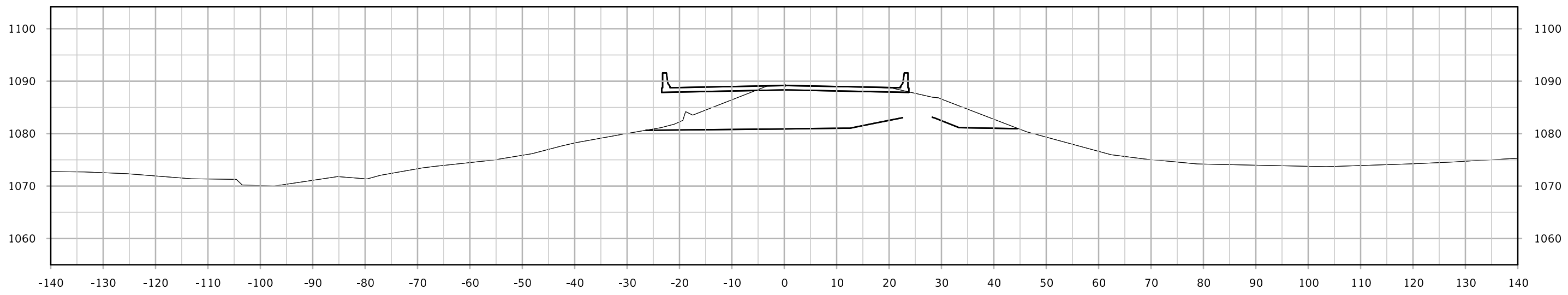

STA. 801+75.00

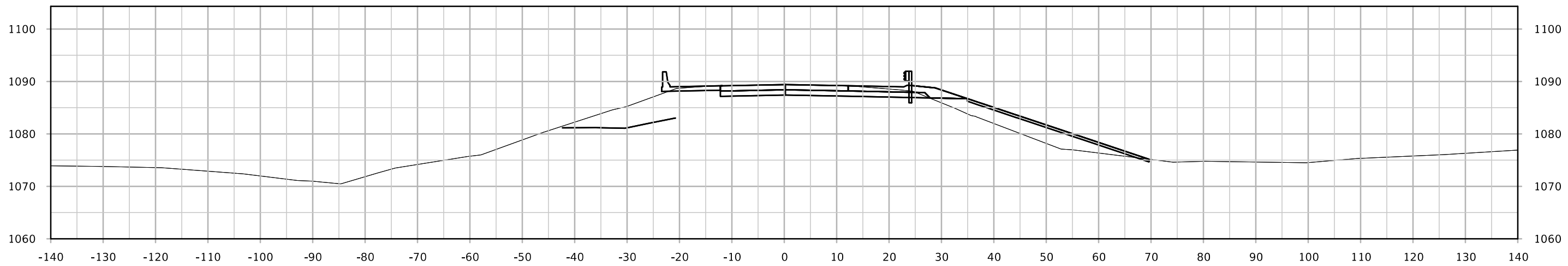

STA. 801+50.00

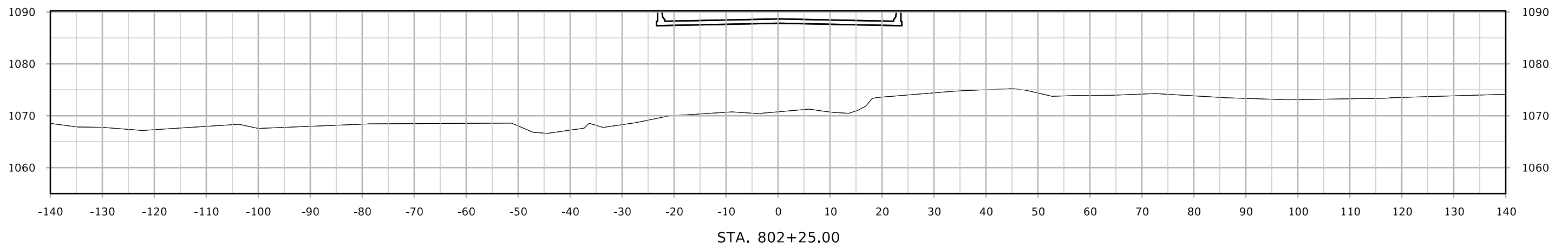
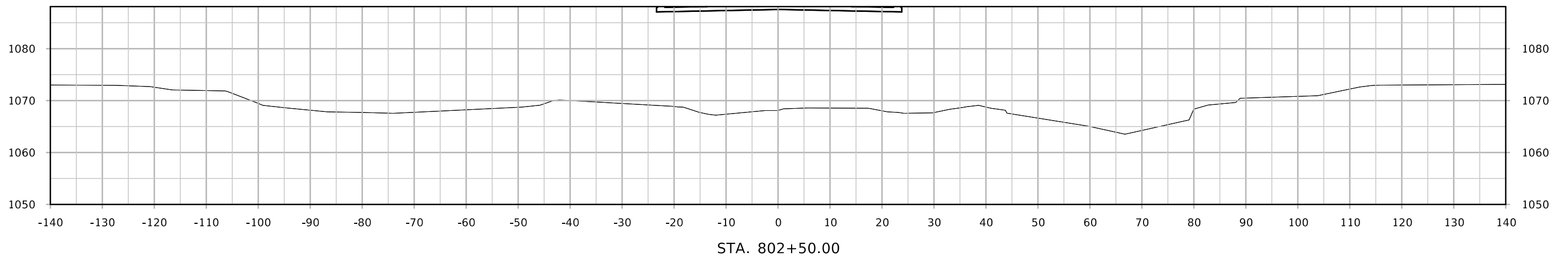
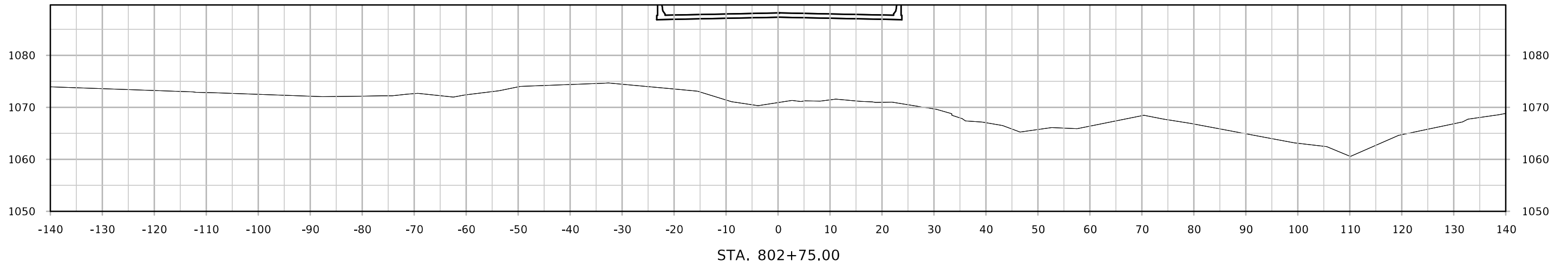

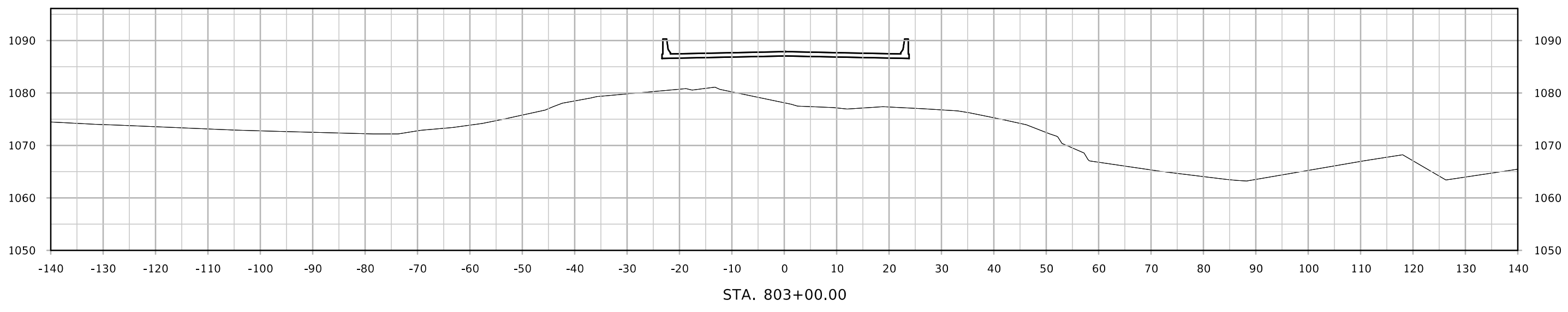
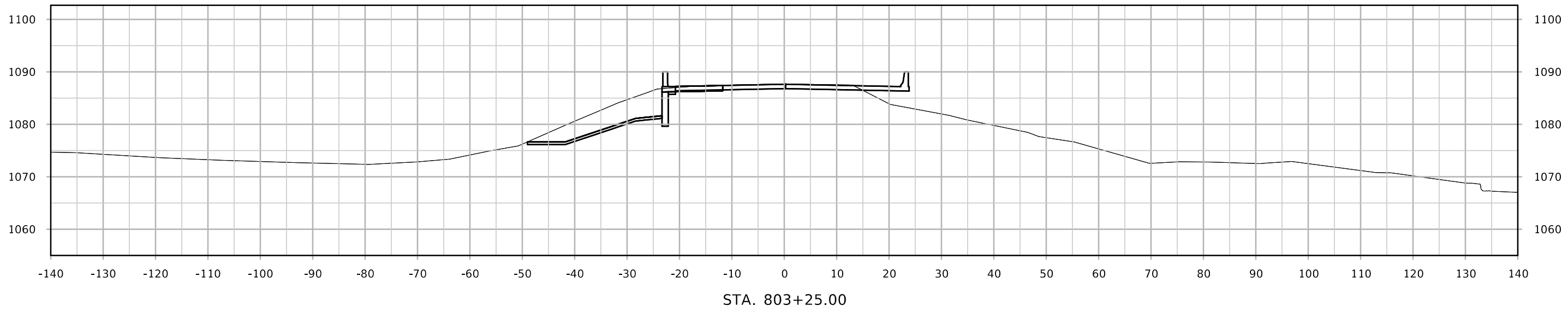

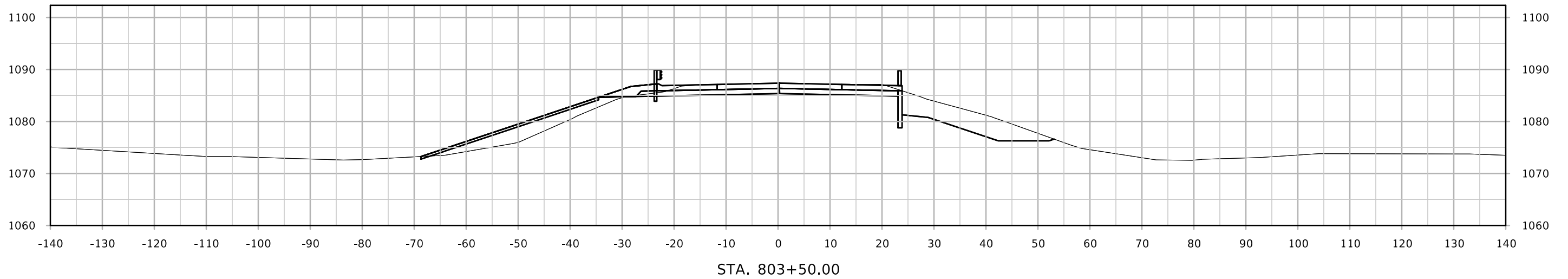
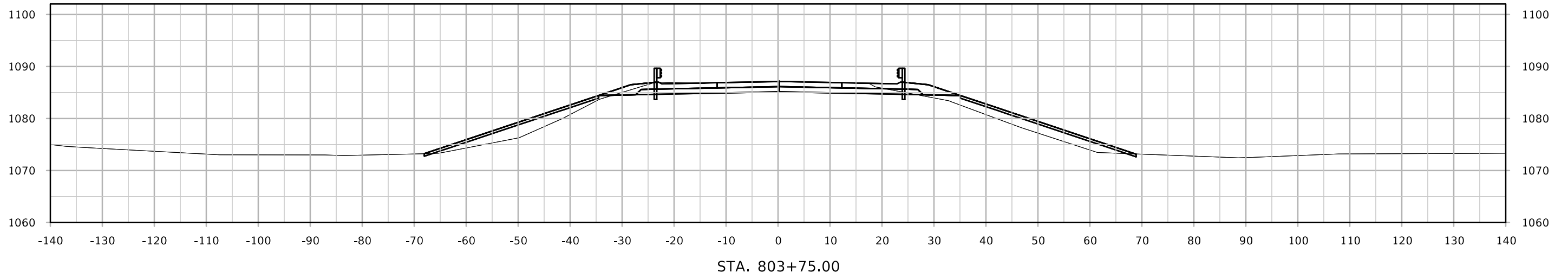
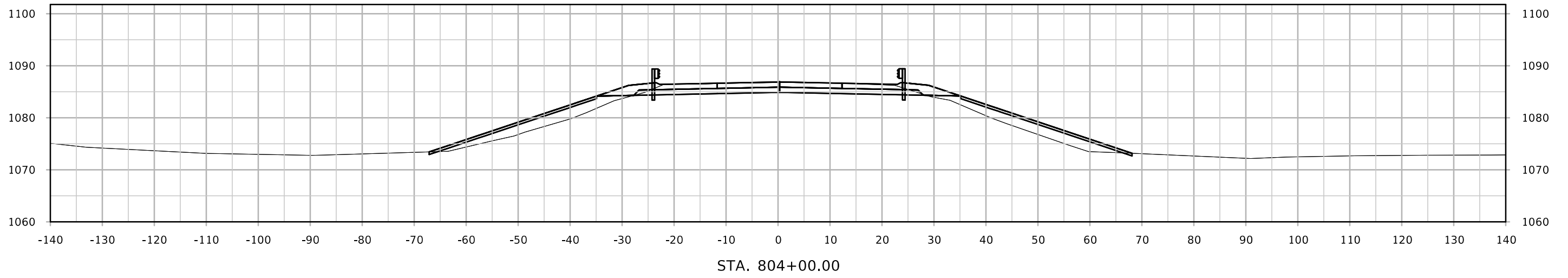

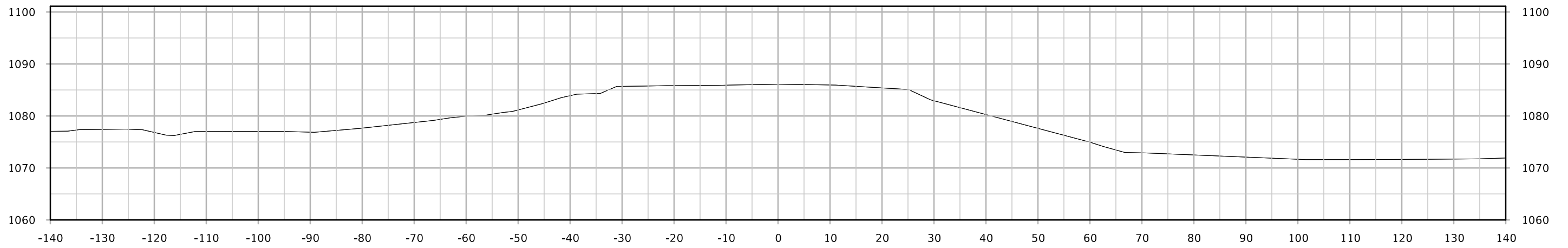

STA. 804+75.00

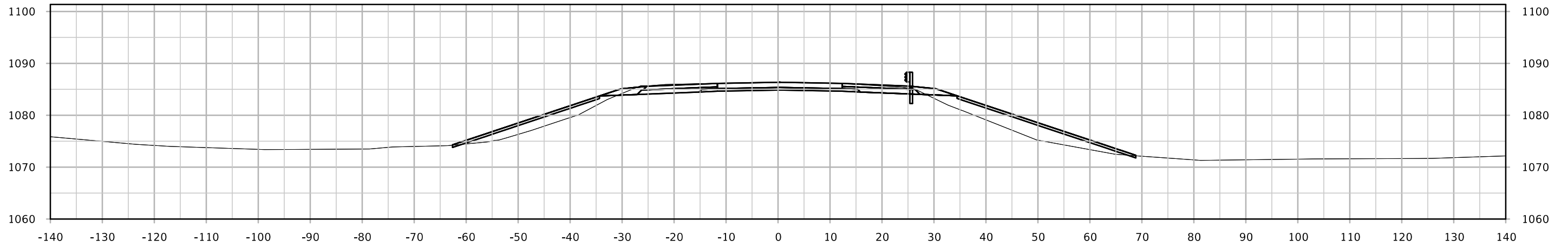

STA. 804+50.00

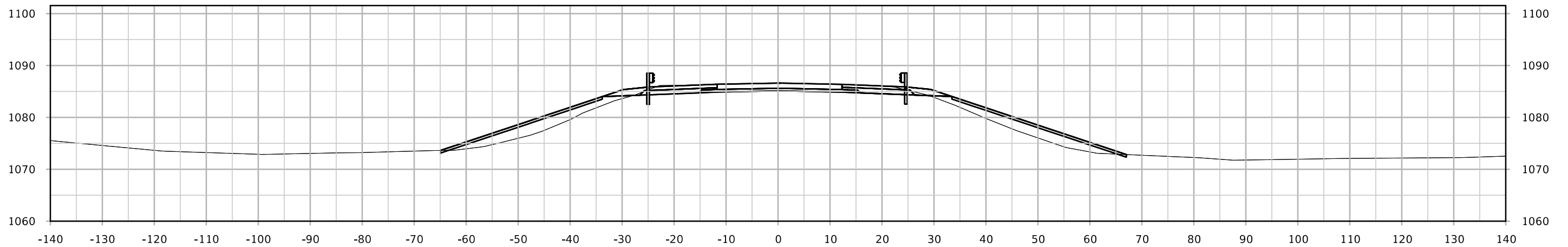

STA. 804+25.00

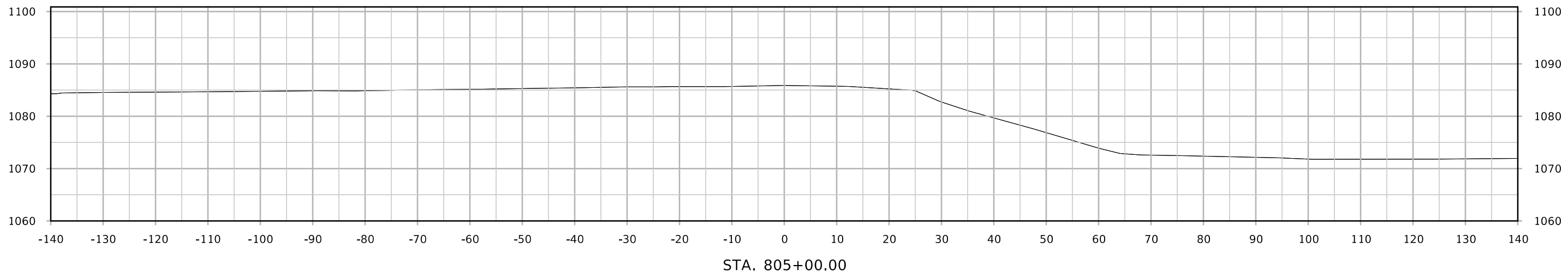

STA. 805+00.00