



APPLICATION AND AGREEMENT FOR USE OF HIGHWAY RIGHT-OF-WAY FOR UTILITIES ACCOMMODATION

Permit Number 504-2016-007 Highway Number US 63 County Laspeur  
 DOT Project Number NHSX-65-4(77)-34-07 Expiration/Completion Date

First Name \_\_\_\_\_ Middle \_\_\_\_\_ Last Name \_\_\_\_\_ Phone Number \_\_\_\_\_ Ext. \_\_\_\_\_  
 Company Name \_\_\_\_\_ Phone Number \_\_\_\_\_ Ext. \_\_\_\_\_  
 Street Address \_\_\_\_\_ City/Town \_\_\_\_\_ State \_\_\_\_\_ ZIP Code \_\_\_\_\_  
 1300 Main Street Houston TX 77002

**INSTALLATION TO BE ACCOMMODATED**  
 Approval is hereby requested to enter within the state highway right-of-way for the accommodation of a utility installation as detailed on the attachments.

The installation shall consist of:  
 The pipeline is a 30 inch Crude Oil line that is to be installed, operated and maintained by Dakota Access, LLC. The pipeline installation (road crossing) will be performed via a horizontal directional drill (HDD). The HDD method is a technically advanced process involving specialized equipment and skilled operators. The method involves placing a drill rig/unit on one side of the road (outside of road right of way). After a pilot hole has been completed, specialized reaming tools are used to enlarge the pilot hole in order to accommodate the diameter of the pipeline. Once the properly sized hole is established, the pipe section is pulled through the hole by the drilling rig.  
*No temporary Accesses*

and shall be located as shown on the detailed plan attached hereto. (See current Iowa Department of Transportation Utility Accommodation Policy for submittal of detailed plan requirements.)

**WORK SITE LOCATION**  
 The proposed work as described above is located in Section 31, Twp. 81 North, Range 21 West, on Highway No. 65 generally located 0.09 (miles) ~~Northeast~~ *Southwest* (direction) from N 75th Avenue W (city, county line, or other land line). Work proposed is more specifically located as being from ~~96.92~~ *96.92* (Milepost #) and *56+60* (Highway Station) to ~~96.92~~ *96.92* (Milepost #) and *56+60* (Highway Station) on the \_\_\_\_\_ side of highway.

I have read this Agreement, understand its provisions, and agree to abide by it and the utility accommodation policy of the Iowa Department of Transportation

Applicant Signature and Agreement  
 Name of Agent (Print or Type) Agent/Owner (Signature) Title \_\_\_\_\_  
 Clint M Wren *Clint Wren* Sr. Permitting Agent  
 Name of Owner (Print or Type) \_\_\_\_\_ Date 3/2/15  
 Dakota Access, LLC

**CITY ACTION (IF PROPOSED WORK IS WITHIN AN INCORPORATED CITY, CITY ACTION IS REQUIRED)**  
 "The undersigned city joins in the grants embodied in the above permit executed by the Iowa Department of Transportation on condition that all of the covenants and undertakings therein running to the Iowa Department of Transportation shall inure to the benefit of the undersigned city and recommends action on said permit application as noted below by the delegated city official".

Recommend Approval  Do Not Recommend Approval  None Required  
 Handwritten Signature \_\_\_\_\_ Title \_\_\_\_\_ Date \_\_\_\_\_  
 Type or Print Name \_\_\_\_\_ Authorized Official for the City of \_\_\_\_\_

**COUNTY ACTION (IF PROPOSED WORK CROSSES COUNTY RIGHT-OF-WAY, COUNTY ACTION IS REQUIRED)**  
 "The undersigned county joins in the grants embodied in the above permit executed by the Iowa Department of Transportation on condition that all of the covenants and undertakings therein running to the Iowa Department of Transportation shall inure to the benefit of the undersigned county and recommends action on said permit application as noted below by the delegated county official".

Recommend Approval  Do Not Recommend Approval  None Required  
 Handwritten Signature \_\_\_\_\_ Title \_\_\_\_\_ Date \_\_\_\_\_  
 Type or Print Name \_\_\_\_\_ Authorized Official for the County of \_\_\_\_\_

**FOR DEPARTMENT USE ONLY**

Special Requirements - in addition to the stipulations below, the following special requirements shall apply to this permit:

*See Attachment*

**FEDERAL HIGHWAY ADMINISTRATION ACTION (WHEN REQUIRED)**

Recommend Approval     Do Not Recommend Approval     None Required

Authorized FHWA Representative Signature

Date

**DEPARTMENT OF TRANSPORTATION FINAL ACTION**

Application Approved     Application Denied    Permit Number:

Authorized Highway District Representative

Signature

Date

*Mike Grayson*    *John Kraybill*

Notice of intention to start construction or maintenance activities on the highway right-of-way shall be made 10:

Local DOT Contact Person (Type or Print Name)

Phone Number

Street Address

City/Town

State ZIP Code

IA

**AGREEMENTS**

The utility company, corporation, applicant, permit holder or licensee, (hereinafter referred to as the Permit Holder) agrees with the Iowa Department (hereafter referred to as Department) that the following stipulations and those special requirements as listed on this page shall govern under this permit.

**A. General**

1. The installation shall meet the requirements of local municipal, county, state, and federal Iowa franchise rules and regulations, regulations and directives of the Iowa State Commerce Commission; the Department of Natural Resources, all rules and regulations of the Department and any other laws or regulations applicable.
2. The Permit Holder shall be fully responsible for any future adjustments of the facilities within the established highway right-of-way caused by highway construction or maintenance operations.
3. Non-compliance with any of the terms of the Department's policy, permit or agreement, may be considered cause for shut-down of utility construction operations or withholding of relocation reimbursement until compliance is assured, or revocation of the permit. The cost of any work caused to be performed by the State in removal of non-complying construction will be assessed against the Permit Holder.
4. The work described in this permit shall be completed as proposed in compliance with the stipulations and special requirements within one year from the date Department approval is received for said request. Failure on the part of the Permit Holder to abide by the stipulations or in constructing the work described as stipulated and within the time frame stated shall render this agreement and request null and void. The Permit Holder also agrees to save the State of Iowa and the Department harmless of any damages or losses that may be sustained by any person, or persons, on account of the conditions and requirements of this agreement.

**B. Construction and Maintenance**

1. The location, construction and maintenance of the utility installation covered by this application shall be in accordance with the current Department's Utility Accommodation Policy.
2. Before beginning any work in the highway right-of-way, it is the responsibility of the Permit Holder to obtain an easement from the drainage district if necessary. The Department assumes no responsibility for advising the Permit Holder of each location of a drainage district crossing. It is the Permit Holder's responsibility to locate these crossings and obtain any necessary easements or permission from the drainage district. See Code of Iowa, Chapter 468 for additional information.
3. A copy of the approved permit shall be available on the job site at all times for examination by Department officials.
4. All traffic control including sign placement and flagging are the responsibility of the Permit Holder. The original placement of signs and their removal upon completion of the work shall be accomplished by the Permit Holder.
5. Operations in the construction and maintenance of said utility installation shall be carried on in such a manner as to cause minimum interference to or distraction of traffic on said highway.
6. After November 24, 2008, all personnel in the highway right-of-way shall wear ANSI 107 Class 2 apparel at all times when exposed to traffic or construction equipment.

**C. Liability**

1. The Permit Holder shall indemnify and save harmless the State of Iowa, its agencies and employees, from any and all causes of action, suits at law or in equity, for losses, damages, claims or demands, and from any and all liability and expense of whatsoever nature, arising out of or in connection with the Permit Holder's use or occupancy of the public highway.
2. The state of Iowa and the Department assume no responsibility for damages to the Permit Holder's property occasioned by any construction or maintenance operations on said highway if Permit Holder has been notified in accordance with stipulation number D.3. or if the facilities are not located in accordance with this permit.
3. The State of Iowa, its agencies or employees, will be liable for expense incurred by the Permit Holder in its use and occupancy of the highway right-of-way only when negligence of the State, its agencies or employees, is the sole proximate cause of such expense. Whether in contract, tort or otherwise, the liability of the State, its agencies and employees, is limited to the reasonable, direct expense to repair damaged utilities, and in no event will such liability extend to loss of profits or business, indirect, special, consequential or incidental damages.

**D. Notification**

1. The Permit Holder is responsible for contacting Iowa One-Call (1-800-292-8989) and request the location of any underground utilities forty-eight (48) hours before excavation. Before beginning work in the highway right-of-way, the Permit Holder shall also contact any other known utility located in the area of the proposed work.
2. The Permit Holder agrees to give the Department forty-eight hours notice of its intention to start construction or to perform routine maintenance on the highway right-of-way. Said notice shall be made to the contact person whose name is shown on this page.
3. The Department shall give the Permit Holder at least forty-eight hours notice of any proposed construction or maintenance work, on either existing or newly acquired right-of-way when the proposed work will be ten feet of a utility location as previously approved by the Department by permit or written agreement. The Permit Holder shall be responsible within this time frame to arrange to protect its facilities.

Disclaimer Statement: The information furnished on this form will be used by the Department of Transportation to determine approval or denial of the application. Failure to provide all information will result in denial of the application. Information furnished is public information and copies may be provided to the public upon request.

## **Special Requirements**

Minimum depth/cover to be 5 feet of cover within the ditches as measured from the top of pipe.

No open cuts will be allowed within the right of way.

Only clean material shall be used in the right of way.

Proper drainage shall be maintained at all times. All erosion control that is placed within the right of way shall be maintained. Vegetation shall be restored after completion and it will be the contractor's responsibility to remove any obstructions in the right of way placed by the contractor.

All disturbed areas shall be restored to the IDOT's requirements and satisfaction.

No equipment or material shall be stored in the right of way during non-working hours.

No parking shall be allowed on the shoulders of the roadway.

All access to the work site shall be from approved designated areas by the IDOT.

All crossings shall be constructed as approved by the IDOT.

Crossings of the highway shall be during daylight hours when visibility is clear.

Proper Traffic Control is to be done t all times in accordance to the MUTCD.

Applicant is responsible to notify 511 in advance of highway crossings.

The highway surface shall be kept clean and free of debris at all times.

Applicant is responsible for all highway crossing damages that may occur, repairs shall be done under the direction and satisfaction of the IDOT in a timely manner.

# JASPER COUNTY, IOWA

SECTION 31, TOWNSHIP 81 NORTH, RANGE 21 WEST

☉ N 75TH AVENUE W

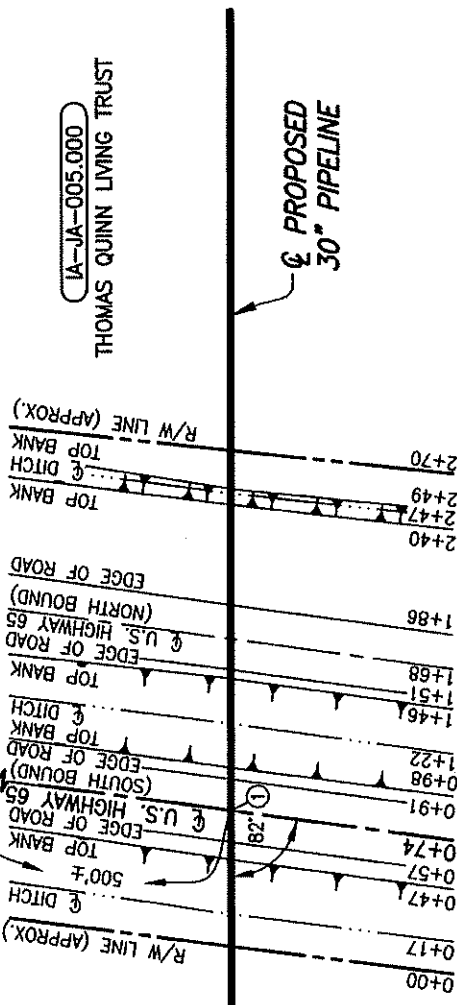

IA-JA-004.001  
IOWA DEPARTMENT  
OF TRANSPORTATION

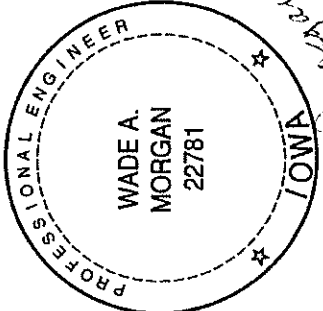

PLAN  
SCALE: 1"=100'

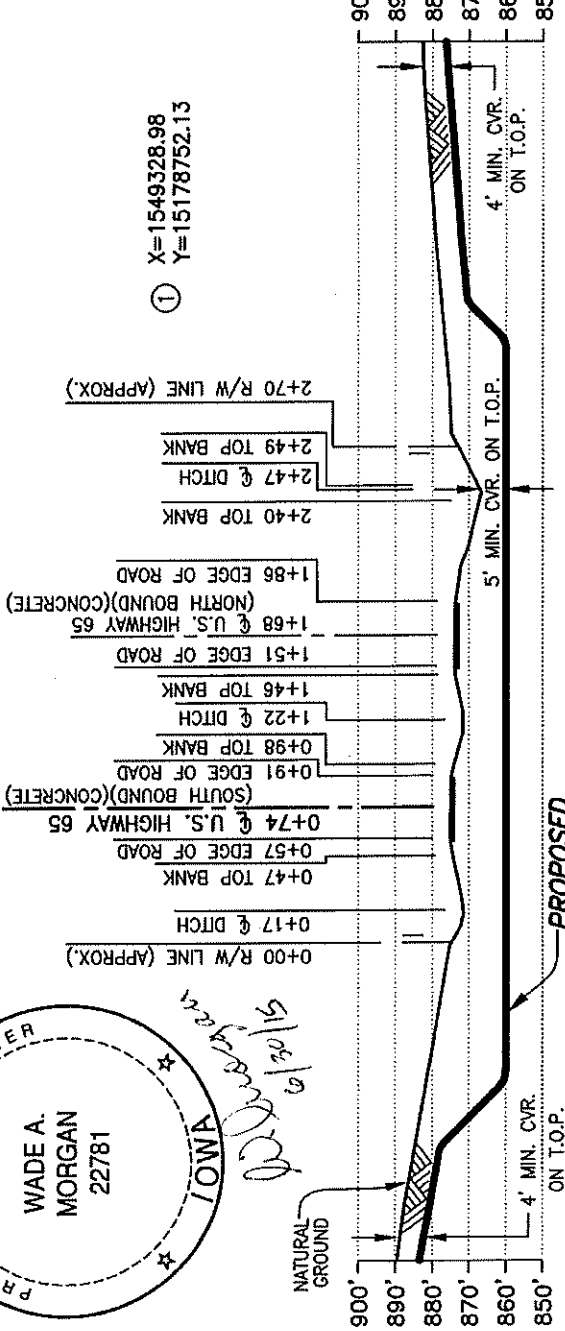

HIGHWAY STATION NO.  
56+60

**PIPE SPECIFICATIONS**  
PIPE 30" O.D. x 0.625" W.T.  
API 5LX-70 DSAW  
COATING: FBE W/ARO  
SERVICE: CRUDE OIL  
INSTALLATION: BORE  
MIN TEST PRESSURE: 1,800 PSIG  
MOP: 1,440 PSIG  
MIN. YIELD STRENGTH: 70,000 PSI

**PROFILE**  
SCALE: 1"=100' HORIZ.  
1"=50' VERT.

**NOTES:**  
CVR. = COVER  
T.O.P. = TOP OF PIPE

**DATUM:**  
ALL ELEVATIONS DERIVED FROM GPS  
OBSERVATIONS (GEOID 2012, NAVD 88)  
BEARINGS BASED ON UTM ZONE 15  
NORTH AMERICAN DATUM 1983.  
U.S. SURVEY FEET  
T.B.M.: ☉ U.S. HIGHWAY 65 (SOUTH BOUND)  
AT STA. 0+74, ELEV. 874.89'

REV.	DATE	BY	DESCRIPTION	CHK.
D	06/30/15	MP	ISSUED FOR USE/PERMIT	AJC
C	03/30/15	MP	ISSUED FOR USE/PERMIT	AJC
B	03/12/15	MP	ISSUED FOR USE/PERMIT	AJC
A	02/03/15	JN	ISSUED FOR REVIEW	AJC

PROJECT NO. 10395700



DAKOTA ACCESS, LLC

PROPOSED 30" DAPL PIPELINE CROSSING  
U.S. HIGHWAY 65 (SOUTH BOUND)

JASPER COUNTY IOWA

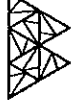

WOOD GROUP MUSTANG, INC.

DRAWN BY: JN	DATE: 01/08/15	DWG. NO.	REV.
CHECKED BY: AJC	DATE: 01/27/15	IA-JA-004.910	D
SCALE: AS SHOWN	APP.: WAM		

Table 2601.03-1: Rural Stabilizing Crop Seeding Rates and Schedule

March 1 through October 31	
Oat Grain rye Canada wildrye ( <i>Elymus canadensis</i> )	50 lbs. per acre (56 kg/ha) 50 lbs. per acre (56 kg/ha) 5 lbs PLS. per acre (6 kg/ha)
November 1 through February 28 (or 29)	
Oat Grain rye Canada wildrye ( <i>Elymus canadensis</i> )	62 lbs. per acre (69 kg/ha) 62 lbs. per acre (69 kg/ha) 7 lbs. PLS. per acre (8 kg/ha)
For stabilizing crop only, Canada wildrye ( <i>Elymus canadensis</i> ) seed will not be required to be certified as Source Identified Class (Yellow Tag) Source GO-Iowa.	
Canada wildrye ( <i>Elymus canadensis</i> ) seed shall be debearded or equal to facilitate application of seed.	

Table 2601.03-2: Urban Stabilizing Crop Seeding Rates

Bluegrass, Kentucky	122 lbs. per acre (137 kg/ha)
Ryegrass, Perennial (fineleaf variety)	35 lbs. per acre (39 kg/ha)
Fescue, Creeping Red	18 lbs. per acre (20 kg/ha)

Table 2601.03-3: Permanent Seed Rates, Rural Areas

Fescue, Tall (Fawn)	100 lbs. per acre (112 kg/ha)
Ryegrass, Perennial (Linn)	75 lbs. per acre (84 kg/ha)
Bluegrass, Kentucky	20 lbs. per acre (22 kg/ha)

Table 2601.03-4: Permanent Seed Rates, Urban Areas

Bluegrass, Kentucky	122 lbs. per acre (137 kg/ha)
Ryegrass, Perennial (fineleaf variety)	35 lbs. per acre (39 kg/ha)
Fescue, Creeping Red	18 lbs. per acre (20 kg/ha)

# Tile Line Repair Guideline

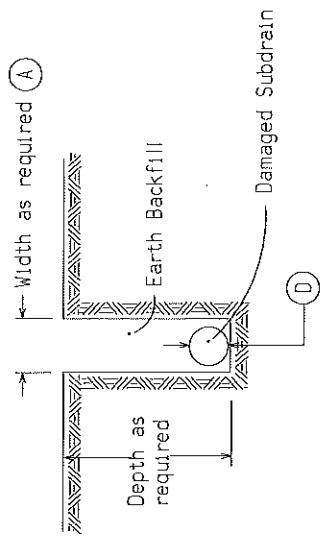
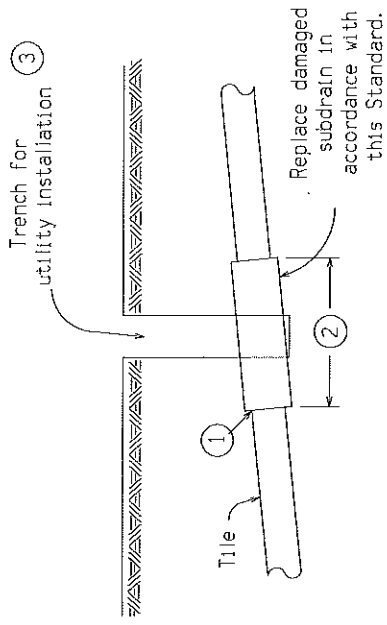

Note:  
Replacement of drainage tile shall be accomplished so as to cause the minimum of disturbance to existing field tile. The repaired drainage tile shall be left in a functional condition with special emphasis placed on maintaining existing flow line elevations.

(A) = A minimum of 24" shall be excavated outside the normal utility trench wall or such greater width as may be required to expose a minimum of 12" of undamaged drain tile.

REPLACEMENT SCHEDULE - CASE 'A'										
Existing Tile ①	4	6	8	10	12	15	18	21	24	>24
Proposed Subdrain Size										
Concrete Pipe	-	12	15	15	18	21	24	30	D+6"	
Coated C.M.P.	10	12	15	18	21	24	30	36	36	*

\* Replacement sizes provide equivalent capacity based on 6" settlement assuming a 0.20% slope with  $n = 0.013$  for concrete pipe and  $n = 0.025$  for corrugated pipe (Manning Formula)

## NOTES:

① Tile lines disturbed within the right-of-way (outside the Roadway Embankment Area \*) limits shall be repaired as follows:

May be repaired with schedule 40 PVC pipe of compatible size or in accordance with the replacement schedule-case 'A' as listed above. Replacement with schedule 40 PVC pipe shall require using a connecting device of a Femco plain and plain flexible pipe coupling or equal.

② Tile lines disturbed within the "Roadway Embankment Area" shall be replaced in accordance with the replacement schedule - case 'A' stated above and as follows:

③ Concrete collar to be placed around joint where existing tile line and corrugated aluminized metal pipe connect.

② Minimum length of corrugated metal pipe shall be 4 feet. Minimum length of 2 feet on each side of the tile line break location.

③ Trench shall be backfilled with 8 inches loose material, compacted to 6 inches with a minimum of 95% compaction of natural density.

A. Backfill and compact area around drain tile to be completed by hand until new tile is completely covered. Remainder of the trench shall be backfilled by acceptable methods.

B. Area shall require inspection by the Iowa Department of Transportation inspectors or their designated personnel prior to backfilling of trench.

\* "Roadway Embankment Area" is defined as the area lying between the foreslopes of a two-lane roadway and from near foreslope to far foreslope of a four lane roadway.

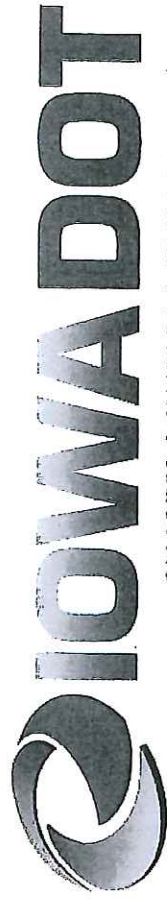

SMARTER | SIMPLER | CUSTOMER DRIVEN

[www.iowadot.gov](http://www.iowadot.gov)

Office of Traffic and Safety  
800 Lincoln Way Ames, Iowa 50010  
Phone: 515-239-1014  
Email: [bryan.bradley@dot.iowa.gov](mailto:bryan.bradley@dot.iowa.gov)

## Notification of width or height restrictions on Iowa primary highways – Utility Requirements

**To:** Utility companies

**Subject:** Notification of width or height restrictions on Iowa primary highways

**Date:** February 17, 2014

In accordance with the stipulations on all Utility Accommodation permits, utilities may not obstruct or close primary highways without prior consent of the Iowa DOT, except in emergency situations. The permit holder must notify the DOT 48 hours in advance of its intention to start construction or perform routine maintenance on the highway right-of-way. The purpose of this note is to remind you of these requirements and provide guidance on how to give proper notice and information to the Iowa DOT.

Even short term partial closures can have a significant impact on the operation of highway system. The Iowa DOT is working hard to improve the accuracy of the information provided by the Iowa 511 traveler information system, (<http://511ia.org/>) but we need your help. Besides providing real-time information to the traveling public, this system is also used by the Iowa DOT to route oversize loads. Having accurate information on the location, extent and duration of lane restrictions is critical for their routing processes.

Before setting up a lane closure or any vertical/horizontal restriction on a primary highway, call your local Iowa DOT maintenance garage, as shown on the Iowa DOT Districts web page, (<http://www.iowadot.gov/districtshome.html>) to discuss timing and date of the closure/restriction. Once the maintenance garage concurs with the timing and date, it is your responsibility to call the Iowa DOT Traffic Operations Center (TOC) at (515-239-1440). The TOC will add the information to the 511

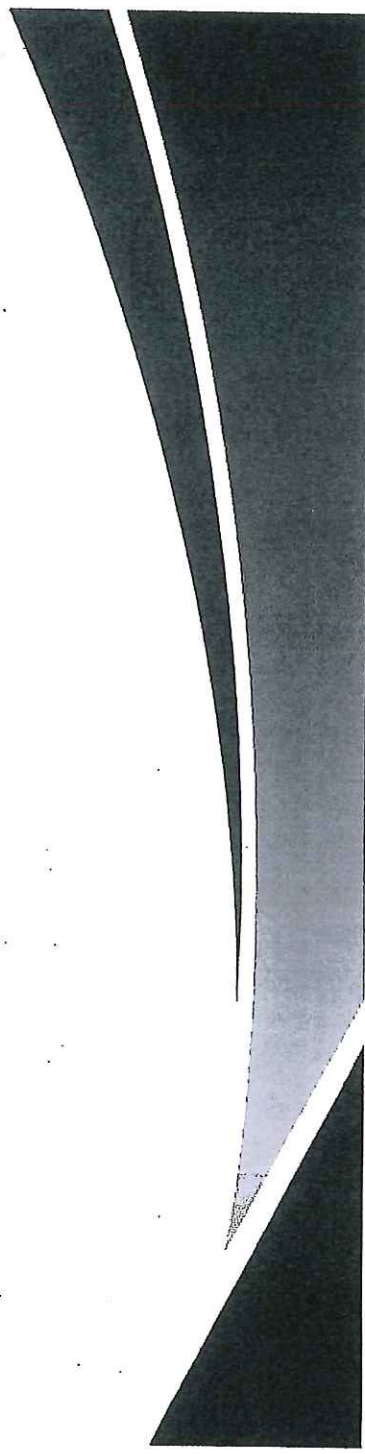

system, which generates an automatic message to Iowa DOT Motor Carrier Services (MCS) and the District office.

**This notification does not replace the need for a permit application. Permits are required for utility accommodation and for any and all work on right of way, except emergency work.**

Except in emergency situations, 48 hour advance notice is the minimum required. The preference is for a 10 day notice as permits for oversize loads are issued up to 10 days in advance. If a 10 day notice is not possible, MCS will have to check for permitted loads on those routes for possible conflicts and work with the permit holders and DOT Maintenance office to resolve the conflicts. In emergency situations, notification should be provided as soon as possible.

When providing notice to the Iowa DOT, you will need to supply detailed information about the restriction. It is advised you have this information (last 2 pages) when you call the TOC. The same detailed information to be provided is also listed at:

[http://www.iowadot.gov/local\\_systems/mailling/2014/january/511\\_information\\_form.pdf](http://www.iowadot.gov/local_systems/mailling/2014/january/511_information_form.pdf).

If you have any questions, **please do not reply to this note**. Instead, you may contact either your local Iowa DOT maintenance garage or the TOC.

Thank you in advance for your cooperation.

Sincerely,

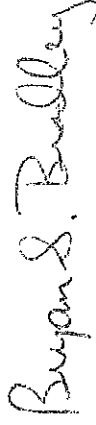

Bryan Bradley  
State Utility Engineer

515-239-1014

[bryan.bradley@iowa.gov](mailto:bryan.bradley@iowa.gov)

Iowa Department of Transportation



## 511 Information Required

Before setting up a lane closure or a vertical/horizontal restriction of any kind on a primary highway extension, call your local Iowa DOT maintenance garage to discuss timing and date of the closure/restriction. Once the maintenance garage concurs with the timing and date, call the Iowa DOT Traffic Operations Center (TOC) at **515-239-1440**. The TOC will put the information in the 511 system, which generates an automatic message to Iowa DOT Motor Carrier Services (MCS) and the District office.

The following information is required to enter a maintenance/construction event into the Iowa DOT 511 system.

Requestor: \_\_\_\_\_ Contact number: \_\_\_\_\_

Route(s) affected: \_\_\_\_\_

Project description: \_\_\_\_\_  
\_\_\_\_\_  
\_\_\_\_\_

Project begin location (detailed description including cross streets and mile markers):  
\_\_\_\_\_  
\_\_\_\_\_

Project end location (detailed description including cross streets and mile markers):  
\_\_\_\_\_  
\_\_\_\_\_

County/Countries: \_\_\_\_\_

24 hour project contact: \_\_\_\_\_

Name \_\_\_\_\_ Phone \_\_\_\_\_

Describe the impact on traffic:

- |  |  |
|--|--|
| <input type="checkbox"/> Closed                    | <input type="checkbox"/> Right lane closed     |
| <input type="checkbox"/> Closed intermittently     | <input type="checkbox"/> Left lane closed      |
| <input type="checkbox"/> Intermittent lane closure | <input type="checkbox"/> Center lane closed    |
| <input type="checkbox"/> Alternating lane closures | <input type="checkbox"/> Right shoulder closed |
| <input type="checkbox"/> Reduced to one lane       | <input type="checkbox"/> Left Shoulder closed  |
| <input type="checkbox"/> Reduced to two lanes      | <input type="checkbox"/> Exit ramp closed      |
| <input type="checkbox"/> Reduced to three lanes    | <input type="checkbox"/> Entrance ramp closed  |

- Two center lanes are closed
- Left exit ramp closed
- Shoulder closed
- Bridge closed
- Intersecting road closed
- Local road closures in area
- Left lane of exit ramp closed
- Road construction
- Work in the median
- Opposing traffic
- Single lane traffic alternating directions

Additional project information (pilot car, flagger, etc.):

---



---

Will there be temporary overhead signals? (15' standard height restriction)

- Yes
- No

If yes, please provide the location of the temporary overhead signals in the space provided.

---



---

Are there any other width or height restrictions:

- Yes
- No

If yes, please describe:

---



---

Additional public website comments:

---



---

Project beginning date and time:

---

Project ending date and time:

---

**Times of closure**

- Continuous
- Weekdays (Monday – Friday)
- Nights

Times of closure:

---

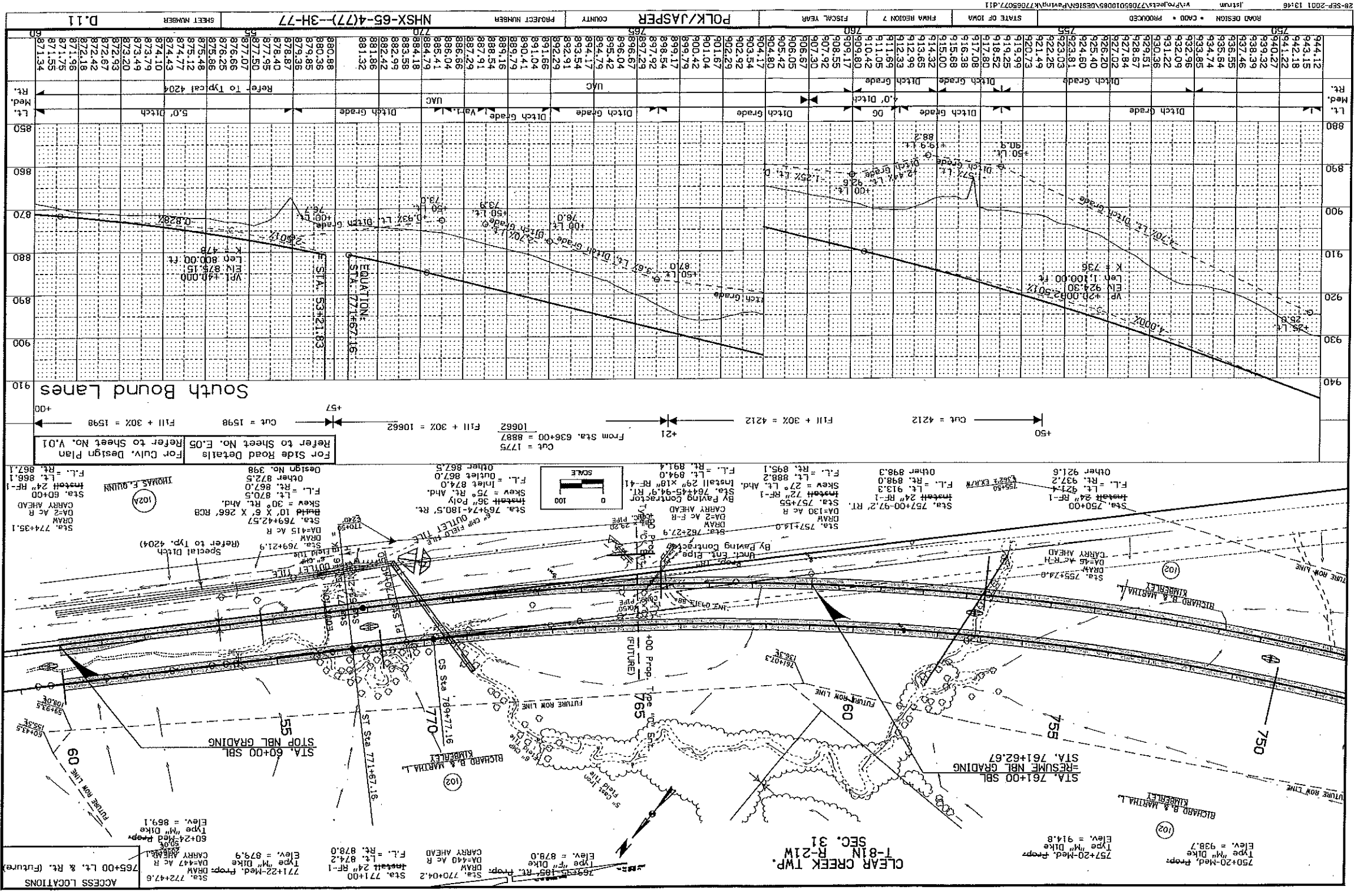

**ACCESS LOCATIONS**

Sta. 772+47.6	Type "M" Dike	Elev. = 891.1
Sta. 771+00	Type "M" Dike	Elev. = 878.0
Sta. 770+04.2	Type "M" Dike	Elev. = 879.0
Sta. 769+35.1	Type "M" Dike	Elev. = 879.9
Sta. 765+00 Lt. & Rt. (Future)	Type "M" Dike	Elev. = 878.0

**750+20-Med. Prop.**  
Type "M" Dike  
Elev. = 914.8

**757+20-Med. Prop.**  
Type "M" Dike  
Elev. = 938.7

**761+00 SBL**  
Type "M" Dike  
Elev. = 938.7

**761+62.67**  
Type "M" Dike  
Elev. = 938.7

**755+74.0**  
Type "M" Dike  
Elev. = 938.7

**757+00-97.2' RT.**  
Type "M" Dike  
Elev. = 938.7

**757+00**  
Type "M" Dike  
Elev. = 938.7

**755+24" RT-1**  
Type "M" Dike  
Elev. = 938.7

**757+27.9**  
Type "M" Dike  
Elev. = 938.7

**761+33**  
Type "M" Dike  
Elev. = 938.7

**762+27.9**  
Type "M" Dike  
Elev. = 938.7

**762+27.9**  
Type "M" Dike  
Elev. = 938.7

**762+27.9**  
Type "M" Dike  
Elev. = 938.7

**762+27.9**  
Type "M" Dike  
Elev. = 938.7

**762+27.9**  
Type "M" Dike  
Elev. = 938.7

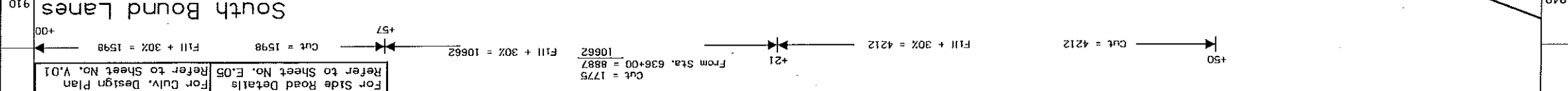

Station	Profile	Elevation	Grade	Notes
940	940.00	940.00		
930	930.00	930.00		
920	920.00	920.00		
910	910.00	910.00		
900	900.00	900.00		
890	890.00	890.00		
880	880.00	880.00		
870	870.00	870.00		
860	860.00	860.00		
850	850.00	850.00		
840	840.00	840.00		
830	830.00	830.00		
820	820.00	820.00		
810	810.00	810.00		
800	800.00	800.00		
790	790.00	790.00		
780	780.00	780.00		
770	770.00	770.00		
760	760.00	760.00		
750	750.00	750.00		
740	740.00	740.00		
730	730.00	730.00		
720	720.00	720.00		
710	710.00	710.00		
700	700.00	700.00		
690	690.00	690.00		
680	680.00	680.00		
670	670.00	670.00		
660	660.00	660.00		
650	650.00	650.00		
640	640.00	640.00		
630	630.00	630.00		
620	620.00	620.00		
610	610.00	610.00		
600	600.00	600.00		
590	590.00	590.00		
580	580.00	580.00		
570	570.00	570.00		
560	560.00	560.00		
550	550.00	550.00		
540	540.00	540.00		
530	530.00	530.00		
520	520.00	520.00		
510	510.00	510.00		
500	500.00	500.00		
490	490.00	490.00		
480	480.00	480.00		
470	470.00	470.00		
460	460.00	460.00		
450	450.00	450.00		
440	440.00	440.00		
430	430.00	430.00		
420	420.00	420.00		
410	410.00	410.00		
400	400.00	400.00		
390	390.00	390.00		
380	380.00	380.00		
370	370.00	370.00		
360	360.00	360.00		
350	350.00	350.00		
340	340.00	340.00		
330	330.00	330.00		
320	320.00	320.00		
310	310.00	310.00		
300	300.00	300.00		
290	290.00	290.00		
280	280.00	280.00		
270	270.00	270.00		
260	260.00	260.00		
250	250.00	250.00		
240	240.00	240.00		
230	230.00	230.00		
220	220.00	220.00		
210	210.00	210.00		
200	200.00	200.00		
190	190.00	190.00		
180	180.00	180.00		
170	170.00	170.00		
160	160.00	160.00		
150	150.00	150.00		
140	140.00	140.00		
130	130.00	130.00		
120	120.00	120.00		
110	110.00	110.00		
100	100.00	100.00		
90	90.00	90.00		
80	80.00	80.00		
70	70.00	70.00		
60	60.00	60.00		
50	50.00	50.00		
40	40.00	40.00		
30	30.00	30.00		
20	20.00	20.00		
10	10.00	10.00		
0	0.00	0.00		