

STA. 50+25, 0.00
 PROP. SANITARY MANHOLE
 TYPE SW-301
 TC = 972.19
 I.E. 48" = 959.00 (N)

PROP. 603 L.F.
 48" PVC SANITARY SEWER
 S = -0.21%

SAN. MH
 RIM = 973.05
 I.E. = 959.63

55+00.00

MATCH LINE

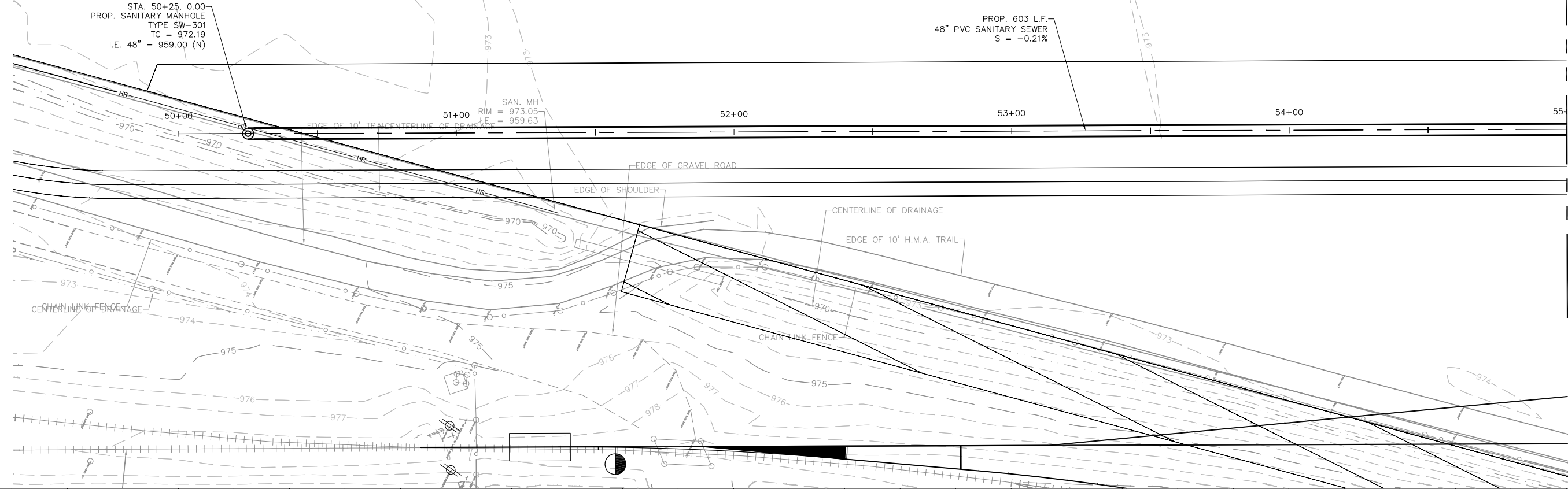

975																																		975
970																																		970
965																																		965
960																																		960
955																																		955
950																																		950
945																																		945

STA. 50+25, 0.00
 PROP. SANITARY MANHOLE
 TYPE SW-301
 TC = 972.19
 I.E. 48" = 959.00 (N)

PROP. 603 L.F.
 48" PVC SANITARY SEWER
 S = -0.21%

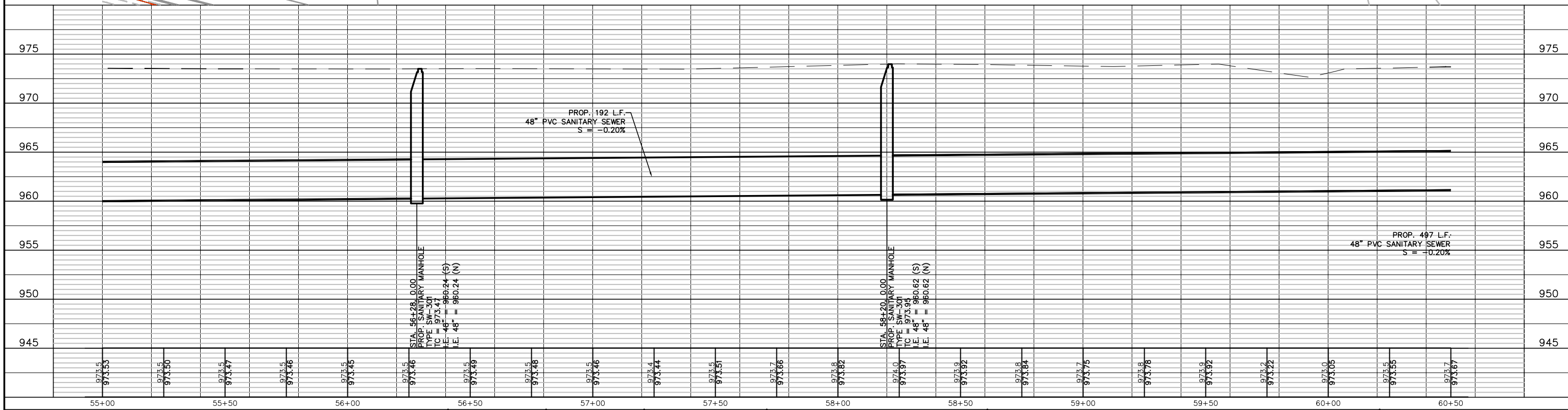
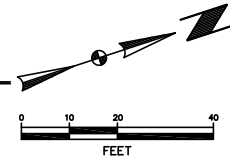
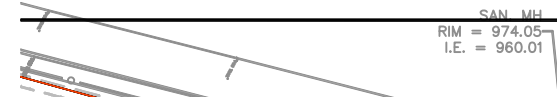
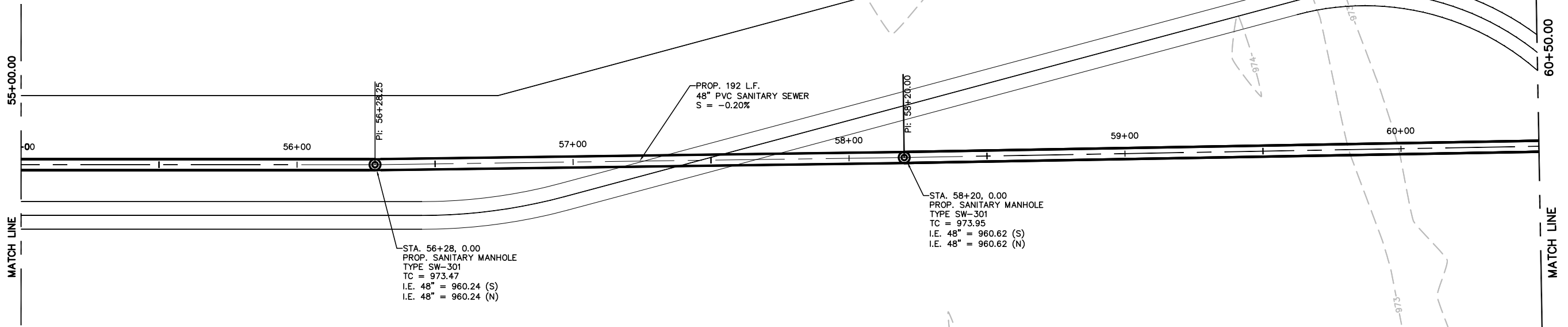

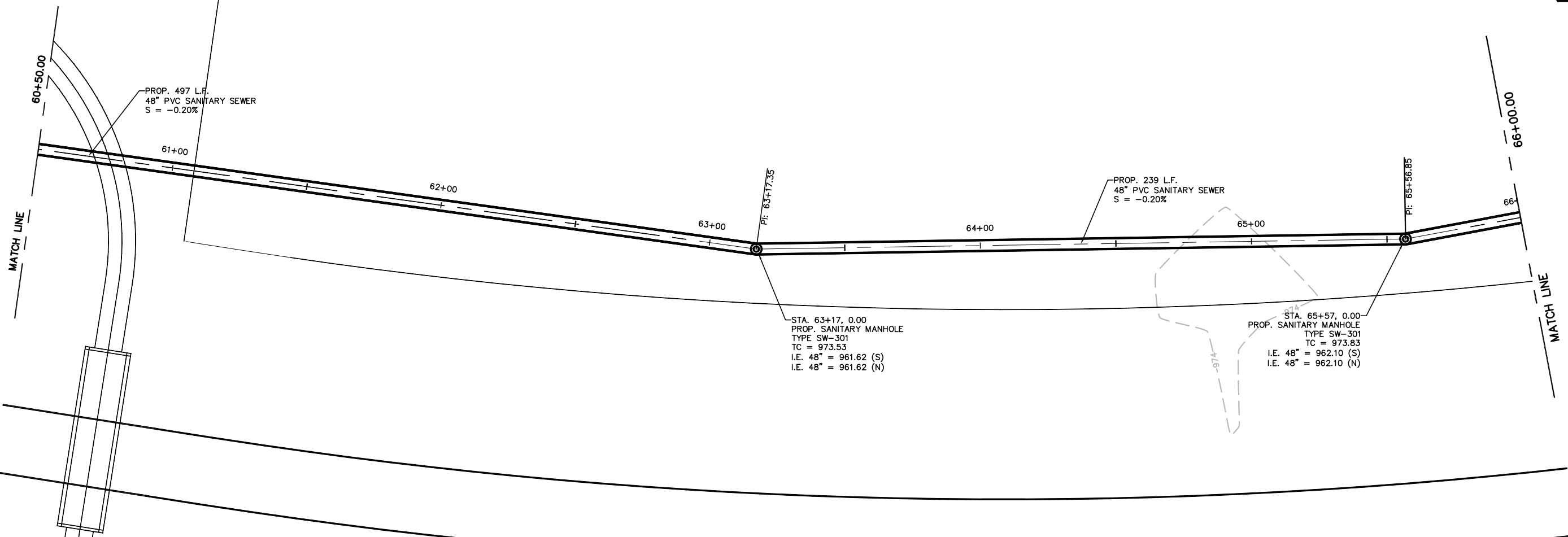
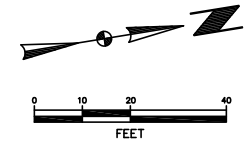

PROP. 497 L.F.
48" PVC SANITARY SEWER
S = -0.20%

PROP. 239 L.F.
48" PVC SANITARY SEWER
S = -0.20%

STA. 63+17, 0.00
PROP. SANITARY MANHOLE
TYPE SW-301
TC = 973.53
I.E. 48" = 961.62 (S)
I.E. 48" = 961.62 (N)

STA. 65+57, 0.00
PROP. SANITARY MANHOLE
TYPE SW-301
TC = 973.83
I.E. 48" = 962.10 (S)
I.E. 48" = 962.10 (N)

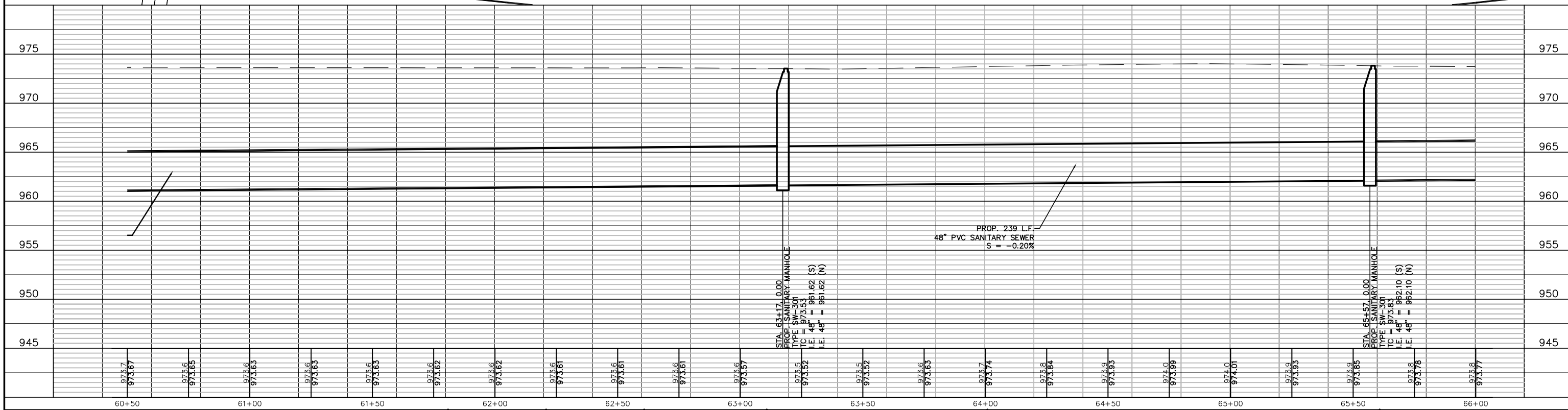

PROP. 239 L.F.
48" PVC SANITARY SEWER
S = -0.20%

STA. 63+17, 0.00
PROP. SANITARY MANHOLE
TYPE SW-301
TC = 973.53
I.E. 48" = 961.62 (S)
I.E. 48" = 961.62 (N)

STA. 65+57, 0.00
PROP. SANITARY MANHOLE
TYPE SW-301
TC = 973.83
I.E. 48" = 962.10 (S)
I.E. 48" = 962.10 (N)

974.7 973.67	974.6 973.65	973.6 973.63	973.6 973.63	973.6 973.63	973.6 973.62	973.6 973.62	973.6 973.61	973.6 973.61	973.6 973.61	973.6 973.57	973.5 973.52	973.5 973.52	973.6 973.63	973.7 973.74	973.8 973.84	973.9 973.93	974.0 974.01	973.9 973.93	973.85 973.85	973.8 973.78	973.8 973.77
60+50	61+00	61+50	62+00	62+50	63+00	63+50	64+00	64+50	65+00	65+50	66+00										

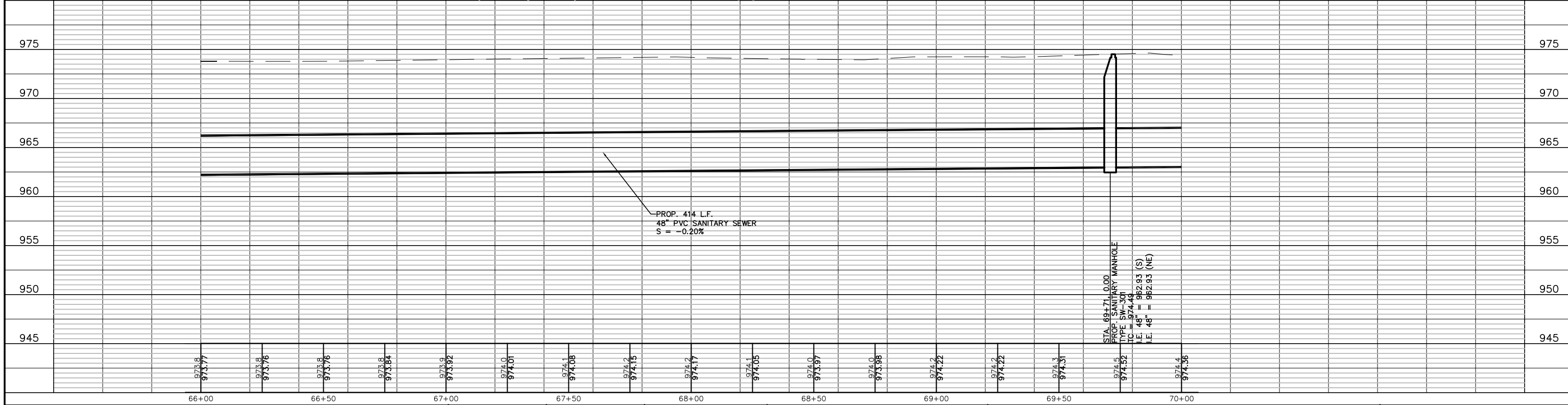
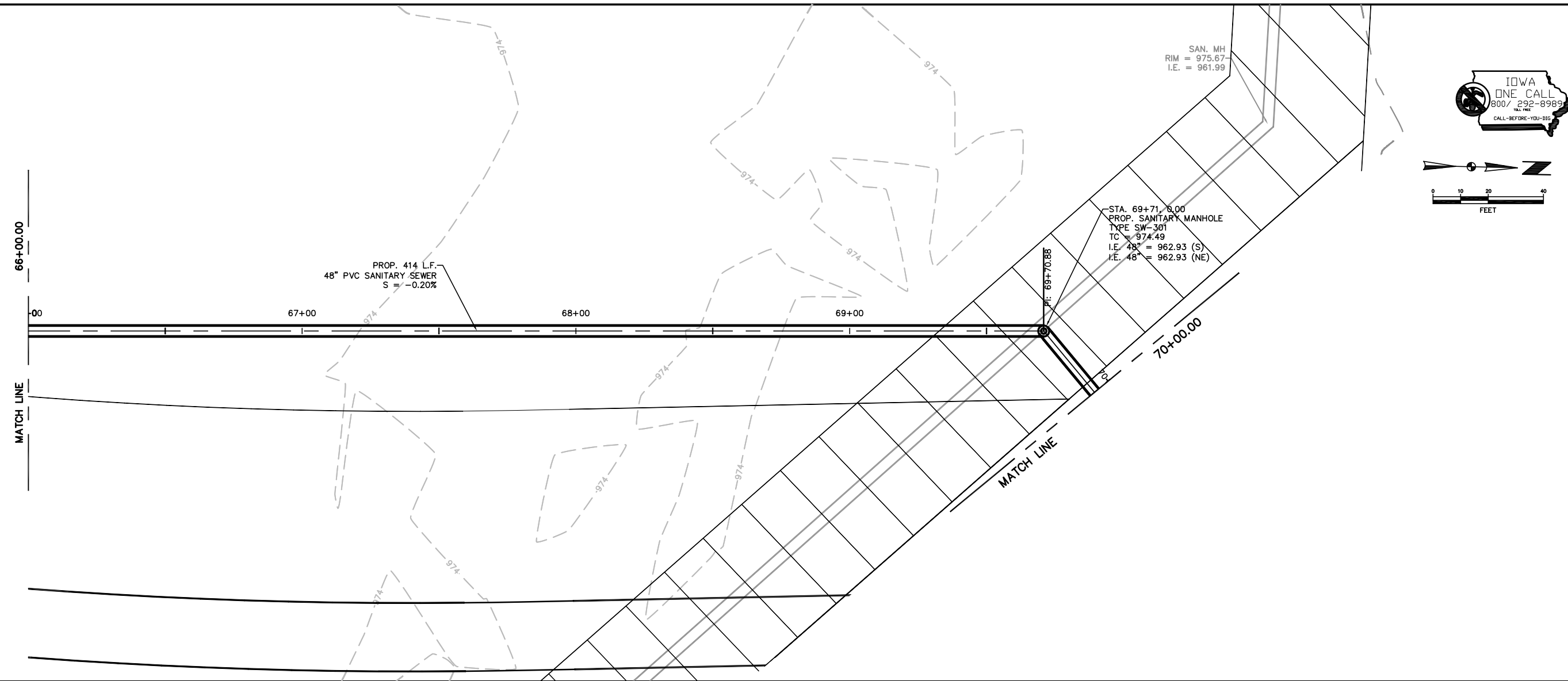
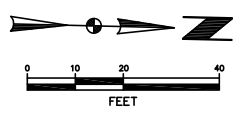

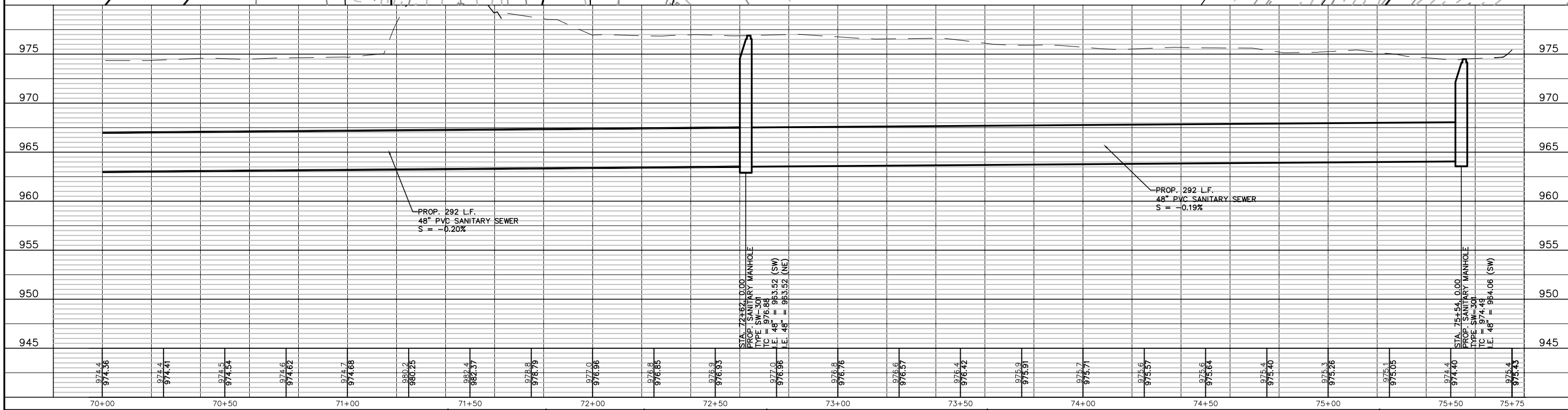
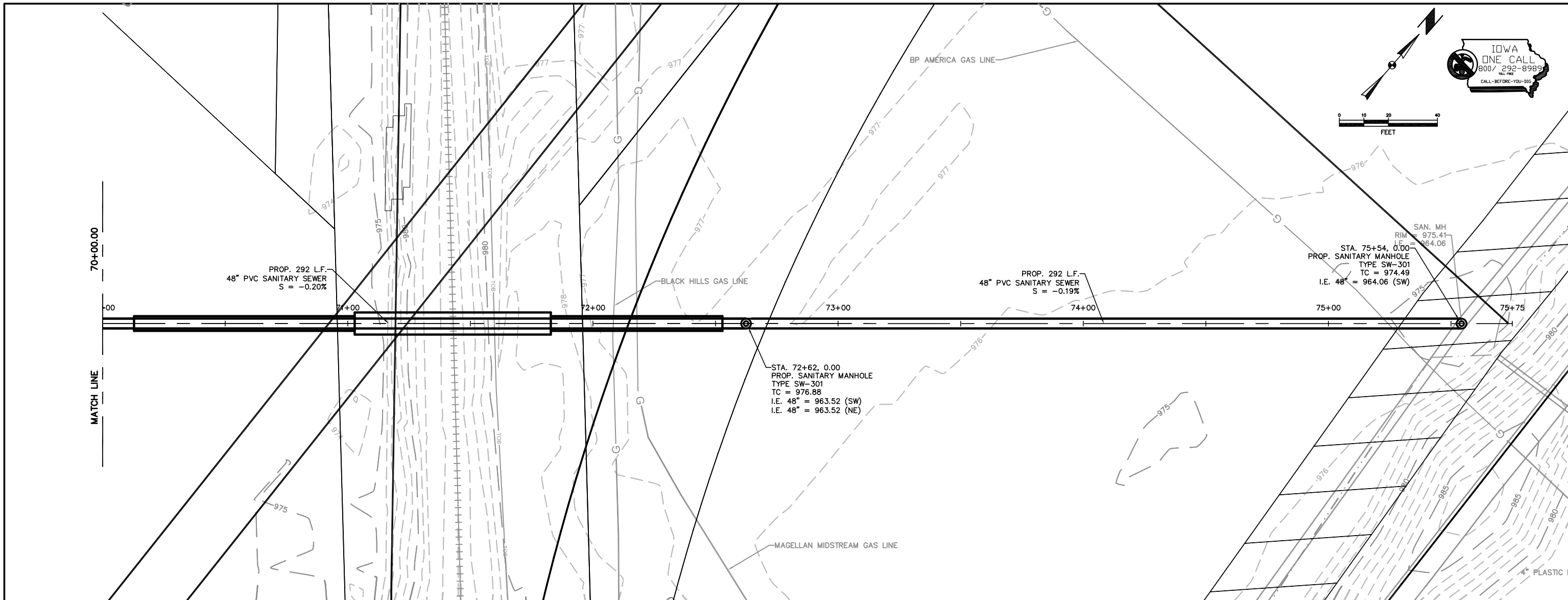
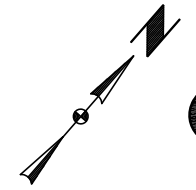

70+00.00
MATCH LINE

974.4	974.56	974.4	974.41	974.5	974.54	974.6	974.62	974.7	974.68	980.2	980.25	982.4	982.37	978.8	978.79	977.0	976.96	976.8	976.76	976.6	976.57	976.4	976.42	975.9	975.91	975.7	975.71	975.6	975.57	975.6	975.64	975.4	975.40	975.3	975.26	975.1	975.05	974.4	974.40	975.4	975.43	
70+00		70+50		71+00				71+50						72+00				72+50									74+00								75+00							75+75