

INDEX OF SHEETS	
No.	DESCRIPTION
<b>A Sheets</b>	<b>Title Sheets</b>
A.1	Title Sheet
A.2	Location Map Sheet
<b>J Sheets</b>	<b>Traffic Control and Staging Sheets</b>
J.1	Traffic Control Plan
<b>V Sheets</b>	<b>Bridge and Culvert Situation Plans</b>
V.1	Bridge and Culvert Situation Plans
	* Color Plan Sheets

H Sheets



PLANS OF PROPOSED IMPROVEMENT ON THE  
**PRIMARY ROAD SYSTEM**  
**JONES COUNTY**  
Revetment  
Kitty Creek 0.7 mi S of Co Rd X44

SCALES: As Noted

Refer to the Proposal Form for list of applicable specifications.

Value Engineering Saves. Refer to Article 1105.14 of the Specifications.



REVISIONS

TOTAL	
	4
PROJECT IDENTIFICATION NUMBER	
21-53-151-040	
PROJECT NUMBER	
NHSN-151-4(131)--2R-53	
R.O.W. PROJECT NUMBER	
NHSN-151-4(132)--2R-53	

**DESIGN DATA RURAL**

2019	AADT	12000	V.P.D.
20 --	AADT	--	V.P.D.
20 --	DHV	--	V.P.H.
	TRUCKS	12 %	
	Total		
	Design ESALs	--	

**INDEX OF SEALS**

SHEET NO.	NAME	TYPE
A.1	Paul W. Flattery	Primary Signature Block

PRELIMINARY PLANS

Subject to change by final design.

**D5 PLAN – Date: 02-15-2022**

R-3W

T-86N

T-85N

PROJECT LOCATION  
MP 62.3

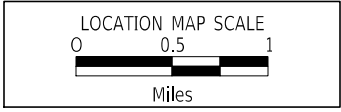
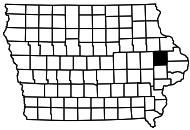
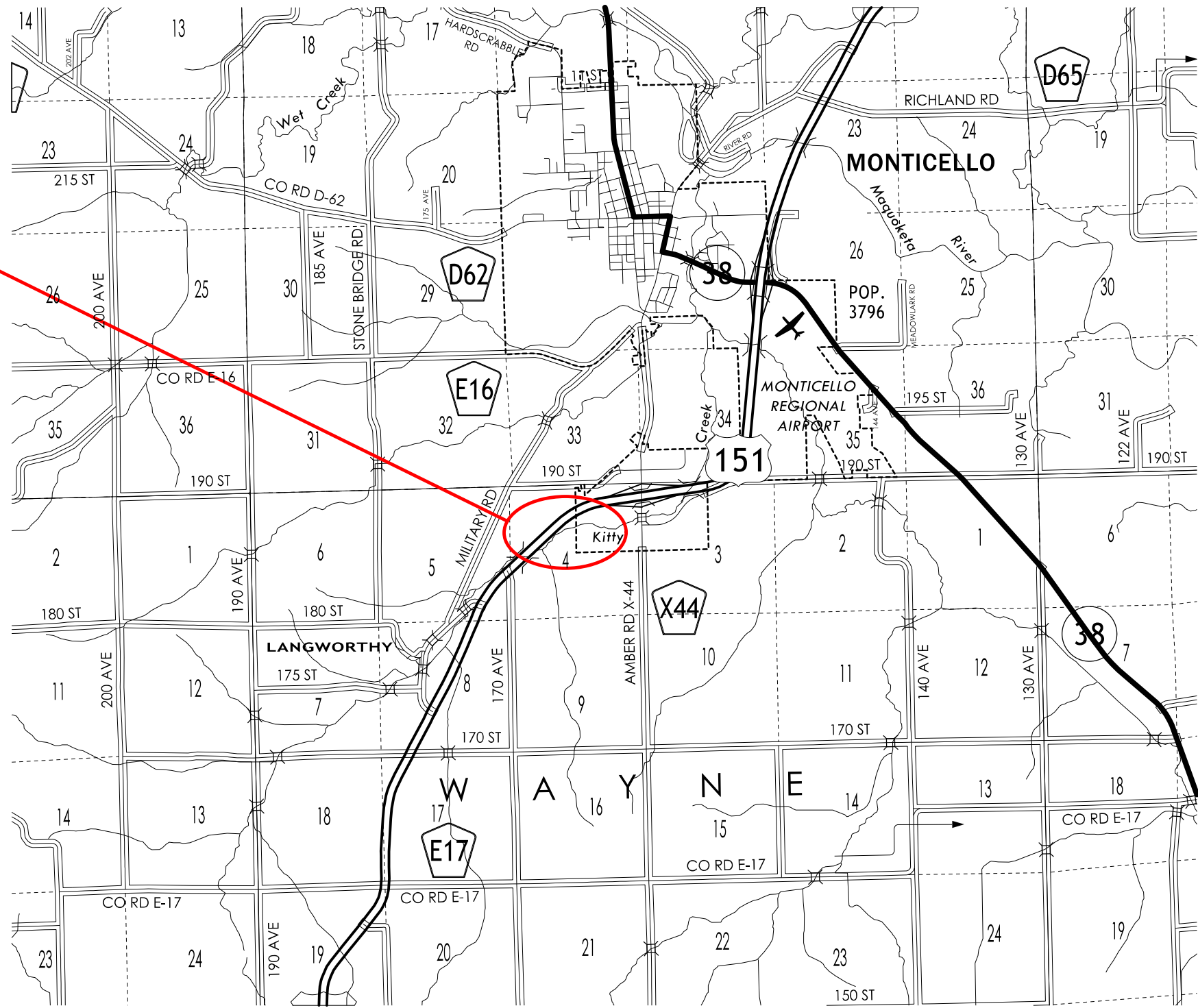

NO ACCESS RIGHTS ARE TO BE ACQUIRED ON THIS PROJECT.

ACCESS CONTROL PREVIOUSLY ACQUIRED.



TEMPORARY EASEMENT FOR ACCESS

KAREN A. DIRKS

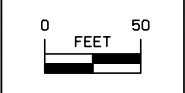

Right of Way Design Information	
THIS SHEET INCLUDED FOR INFORMATION ONLY	
ROW Team: CARMAN / CUVA	
ROW #: NHSN-151-4(132)--2R-53	
Plan Date: 03/18/2022	
Color Legend:	
	Property Lines
	Temporary Easement
	Permanent Acquisition





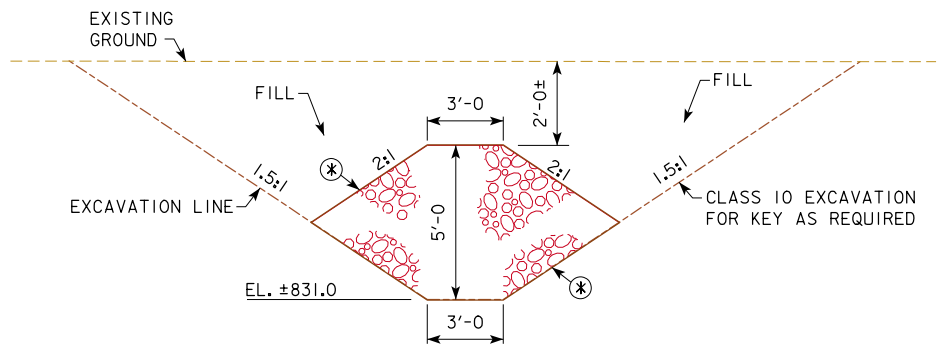

SECTION A - A  
KEY DETAIL

⊛ CLASS E REVET.  
OVERLAIN AND  
UNDERLAIN WITH  
ENGR. FABRIC

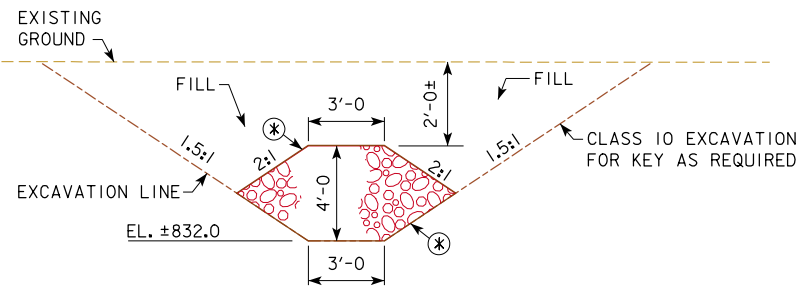

SECTION B - B  
KEY DETAIL

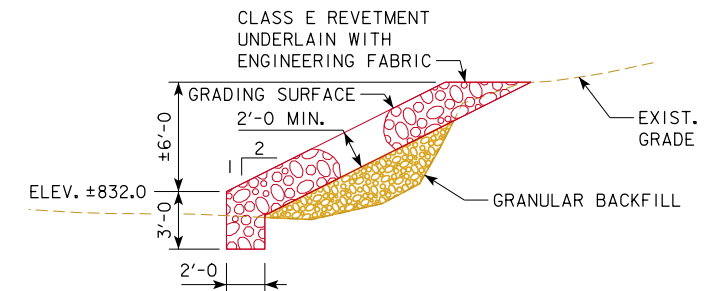

BANK PROTECTION DETAIL  
(NOT TO SCALE)

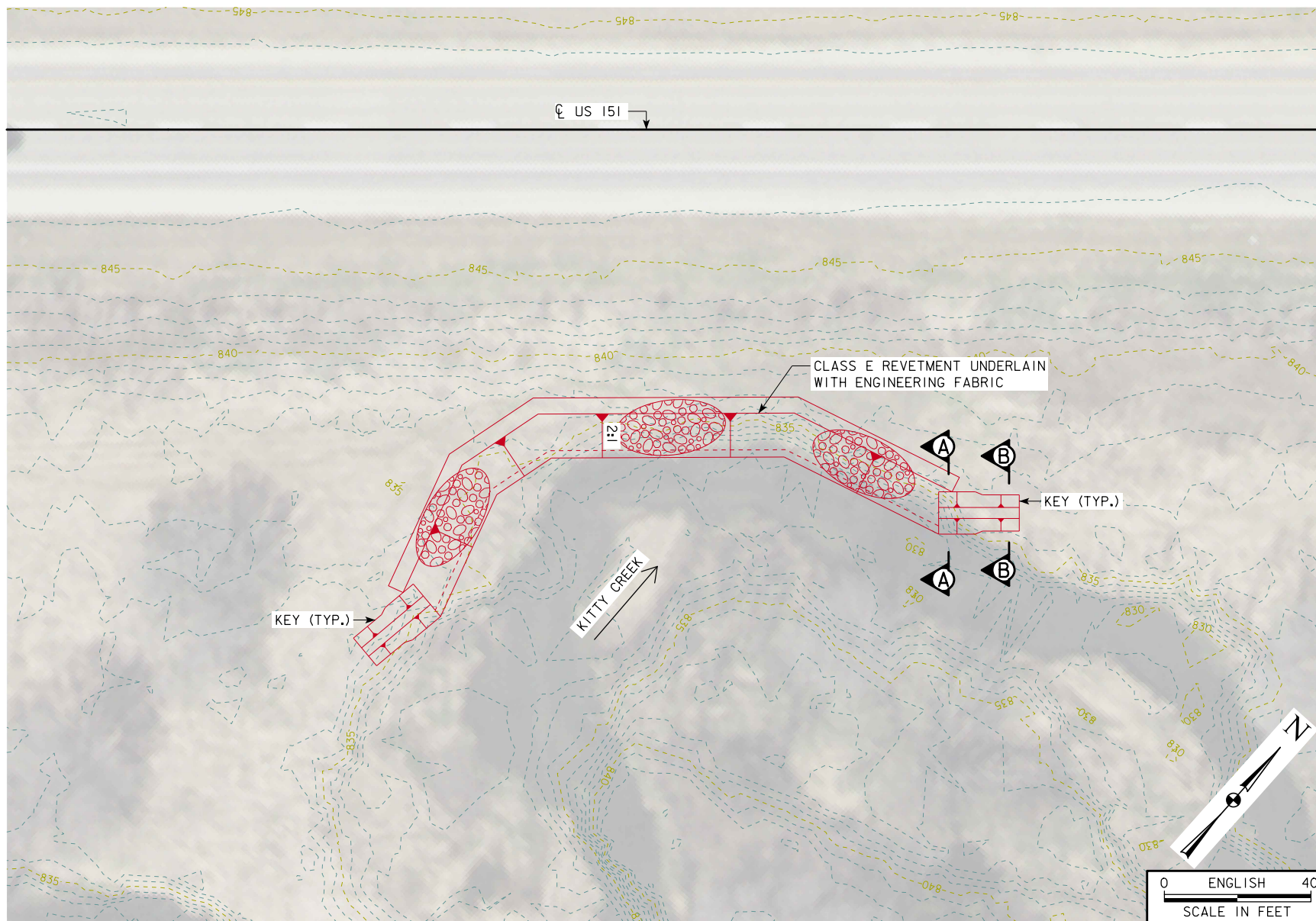

SITUATION PLAN

**LOCATION**

ON KITTY CREEK NEAR US 151  
T-85N R-3W  
SECTION 4  
WAYNE TOWNSHIP  
JONES COUNTY  
LATITUDE 42.203327°  
LONGITUDE 91.203078°

**UTILITIES LEGEND:**

UTILITY SURVEY NOT CONDUCTED

**HYDRAULIC DATA**

DRAINAGE AREA = 15.7 SQ. MI.  
Q<sub>50</sub> = 4,900 CFS  
Q<sub>100</sub> = 5,800 CFS

CONCEPT  
DESIGN FOR  
**KITTY CREEK NEAR US 151  
STREAMBANK STABILIZATION  
SITUATION PLAN**  
STATION 756+00.0 (☉ US 151) SEPTEMBER, 2019  
**JONES COUNTY**  
IOWA DEPARTMENT OF TRANSPORTATION - HIGHWAY DIVISION  
DESIGN SHEET NO. 1 OF 2 FILE NO. ? DESIGN NO. ?