

SLIDE REPAIR
 NHSN-218-2(151)--2R-44

LETTING DATE
 07-21-2020

HENRY CO.

INDEX OF SHEETS	
No.	DESCRIPTION
A Sheets	Title Sheets
A.1	Title Sheet
A.1	Location Map Sheet
CS Sheets	Soils Tabulations
CS.1	Soils Tabulations
J Sheets	Traffic Control and Staging Sheets
J.1	Traffic Control Plan
Q Sheets	Soils Sheets
Q.1	Soils Information Sheet
Q.2	US 218 Soils Sheet
W Sheets	Mainline Cross Sections
W.1	Cross Sections Legend & Symbol Information Sheet
W.1 - 8	US 218
	* Color Plan Sheets



Highway Division

PLANS OF PROPOSED IMPROVEMENT ON THE

PRIMARY ROAD SYSTEM

HENRY COUNTY

SLIDE REPAIR

0.97 mi N of Co Rd J20 (NB)

SCALES: As Noted

Refer to the Proposal Form for list of applicable specifications.

Value Engineering Saves. Refer to Article 1105.14 of the Specifications.



REVISIONS

TOTAL

13

PROJECT IDENTIFICATION NUMBER

19-44-218-010

PROJECT NUMBER

NHSN-218-2(151)--2R-44

R.O.W. PROJECT NUMBER

NHSN-218-2(153)--2R-44

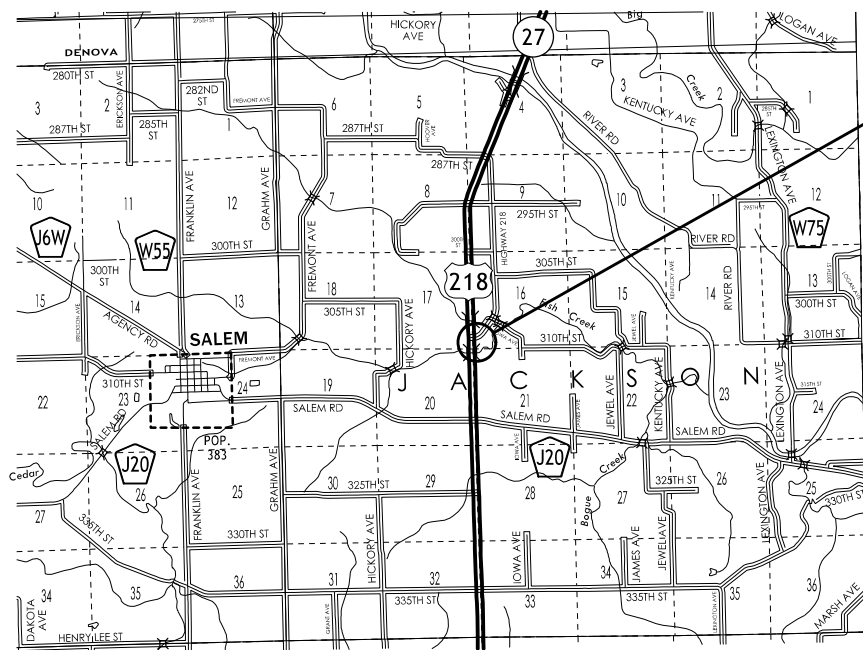

PROJECT LOCATION
 US 218 MM 34.4

DESIGN DATA RURAL

2017	AADT	9300	V.P.D.
20--	AADT	--	V.P.D.
20--	DHV	--	V.P.H.
	TRUCKS	21	%
	Total		
	Design ESALs	--	

INDEX OF SEALS

SHEET NO.	NAME	TYPE
A.1	Paul W. Flattery	Primary Signature Block
CS.1	Mark A. Dell	Geotechnical Design

PRELIMINARY PLANS

Subject to change by final design.

D5 PLAN - Date: 11-20-2019

FILE NO.

ENGLISH

DESIGN TEAM **Flattery \ Jack**

HENRY COUNTY

PROJECT NUMBER

NHSN-218-2(151)--2R-44

SHEET NUMBER

A.1

SLIDE REPAIR

Site No.	Location		Side	Boulders Cl. 12 Exc.	Class 10			Class "E" Revetment	Engineering Fabric	Erosion Stone	Gra. Material Blankets & Subdrain	Macadam Stone	Top Soil		Remarks
	Begin Sta.	End Sta.			Contractor Provided	Excavation & Waste	Roadway & Borrow						Furnish & Spread	Strip, Slavage & Spread	
1	494+75.00	498+10.00	Rt.			1385	1192							1098	

TOPSOIL STRIPPING AND PLACEMENT

Road Identification	Location		Topsoil Stripping Thickness	Topsoil Placement Thickness	Remarks	
	Dir. of Traffic	Begin Station				End Station
U.S. 218		494+75.00	498+10.00	12.0	8.0	

EMBANKMENT WITH MOISTURE CONTROL

Moisture Control is required for all Class 10 fill placed in all locations and depths. Stability berms placed outside the normal foreslope template and topsoil will not require Moisture Control.

SHRINKAGE DATA

Material	%	Remarks
Class 10	30%	
Topsoil	40%	
Boulders		2 CY

LONGITUDINAL SUBDRAIN SHOULDER AND BACKSLOPE

Refer to Soils Sheets

* Not a bid item. Bridge berm quantities assume a trench depth of 24 inches.

Line No.	Road or Lane Identification	Location		Side	Longitudinal Subdrain (DR-303)						Subdrain Outlet		Porous* Backfill	Class "A"* Crushed Stone	Remarks	
		Station to Station	Depth		Shoulder		Backslope		Bridge Berm (EW-203 or EW-204)		DR-303, DR-305 or DR-306					
					Size	Length	Size	Length	Standard Road Plan and Type	Size	Length	Station				Standard Road Plan and Type
1	NBL	495+25.00	498+00.00	LT	66.0			4.0	335.0			495+25.00	DR-306	41.4	Class "A"	place on new backslope surface bench at Elevation 635
												498+00.00	DR-306			
Total							0.0	335.0					DR-306 = 2	41.4	0.0	

	I hereby certify that this engineering document was prepared by me or under my direct personal supervision and that I am a duly licensed Professional Engineer under the laws of the State of Iowa.	
	Signature	Date
	Printed or Typed Name	
	My license renewal date is December 31, 2019	
Pages or sheets covered by this seal: CS.1, Q.1-2, W.1-8		

NO ACCESS RIGHTS ARE TO BE ACQUIRED ON THIS PROJECT.

ACCESS CONTROL PREVIOUSLY ACQUIRED.

US 218 (SB)

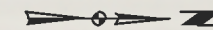

494+00

495+00

496+00

497+00

498+00

499+00

US 218 (NB)

Jackson Twp.
T-70N R-06W
SEC. 16

494+75
±207±Ex.R/W

MELVIN D. & DIANNA L. WILLIAMS

497+04
±248'

498+23±P
±248'

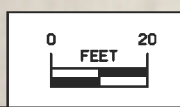

Right of Way Design Information	
THIS SHEET INCLUDED FOR INFORMATION ONLY	
ROW Team: CAGLE / LARSON	
ROW #: NHSN-218-2(153)--2R-44	
Plan Date: 12/10/2019	
Color Legend:	
	Property Lines
	Temporary Easement
	Permanent Acquisition

108-23A
08-01-08

TRAFFIC CONTROL PLAN

Traffic on US 218 shall be maintained at all times.

108-25
10-21-14

511 TRAVEL RESTRICTIONS

Route	Direction	County	Location Description	Feature Crossed	Object Type	Maint. Bridge No., Structure ID, or FHWA No.	Type of Restriction	Existing Measurement	Construction Measurement	Construction Measurement as Signed	Projected As Built Measurement	Remarks
			None Provided.									

111-01
04-17-12

COORDINATED OPERATIONS

Other work in progress during the same period of time will include the construction of the projects listed. Coordinate operations with those of other contractors working within the same area.

Project	Type of Work
NHSN-218-2(152)--2R-44	Slide Repair

Slide Repair - US 218

From approximate Station 494+75 to Station 498+10 on the east side of US 218, bench and rebuild the backslope as shown on W.1-8 using Class 10 cohesive material.

The top 12 inches of material on the backslope shall be considered topsoil and is to be stripped and stockpiled.

The rebuilt foreslope shall be covered with 8 inches of Topsoil.

The repair shall start at the toe of the existing backslope and then extend up-slope.

Excavated benches shall extend a minimum of 5 feet into the undisturbed backslope.

A relatively small amount of Clearing & Grubbing will be required.

Construct a permanent 10-foot wide backslope surface bench generally between Stations 495+25 and 498+00 at Elevation 635 feet.

Install a backslope drain on the permanent backslope surface bench.

Actual limits of the repair will depend on site conditions encountered at the time of construction.



U.S. 218
(151)

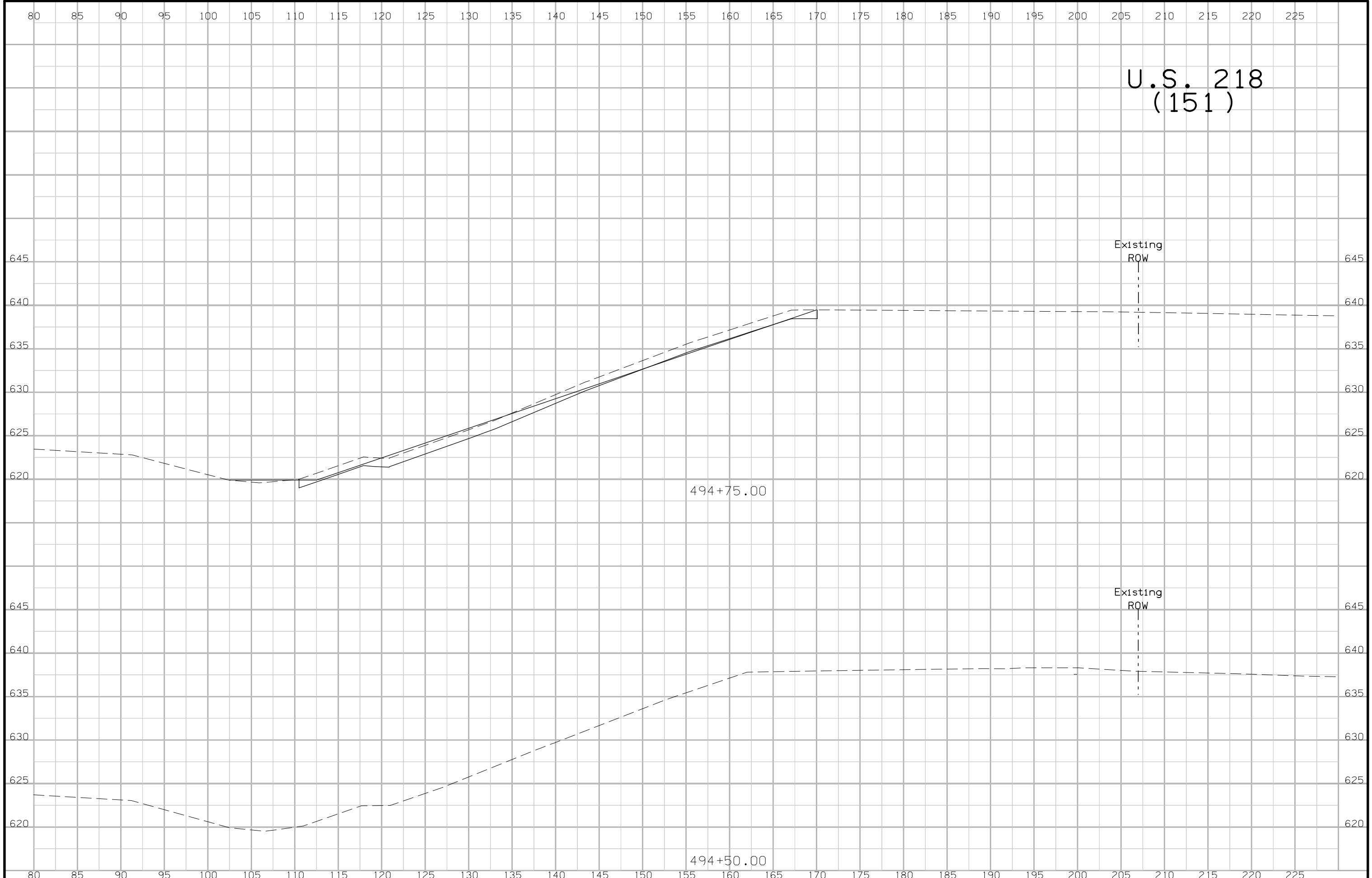

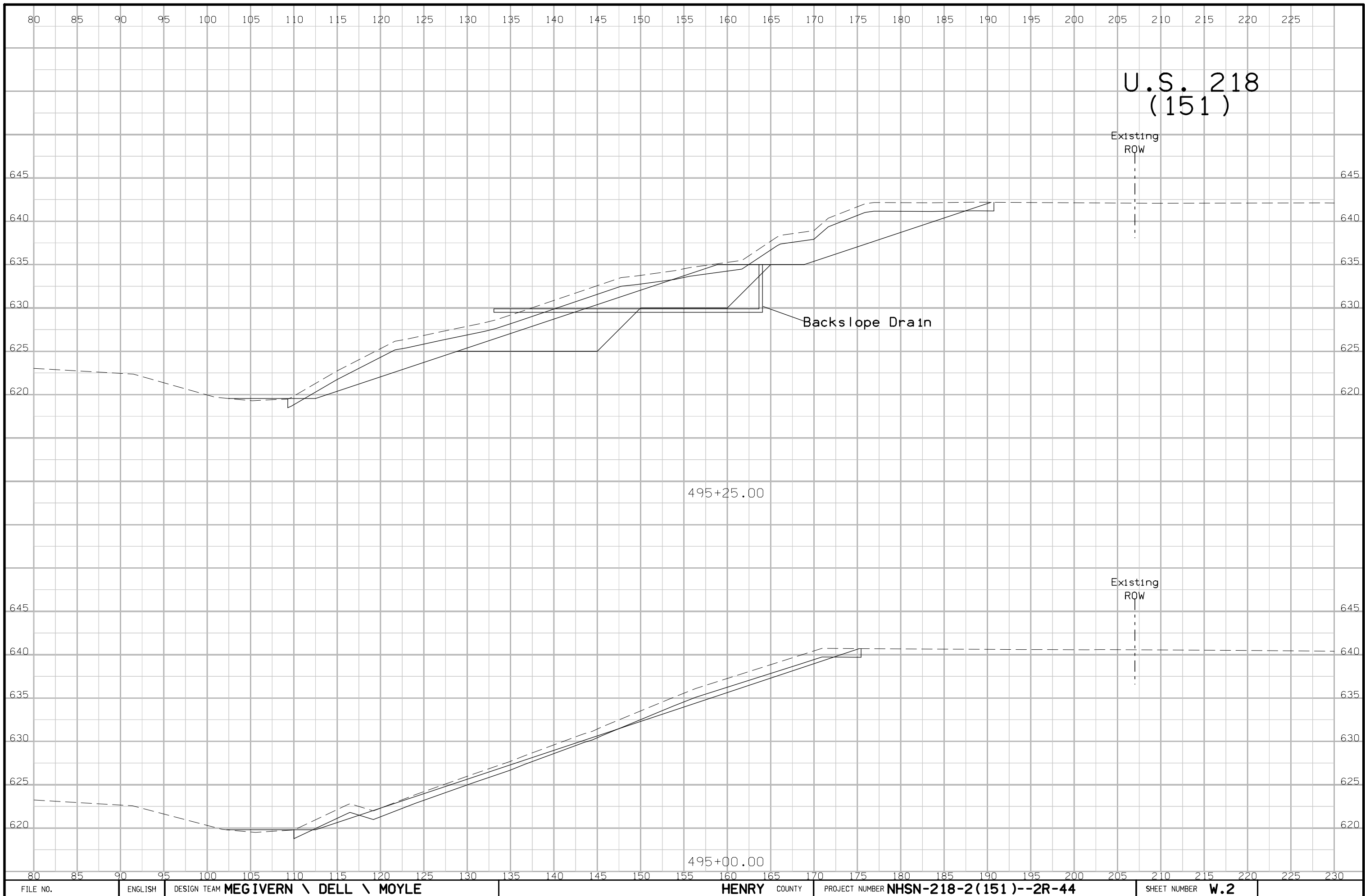

U.S. 218
(151)

Existing
ROW

Backslope Drain

495+25.00

Existing
ROW

495+00.00

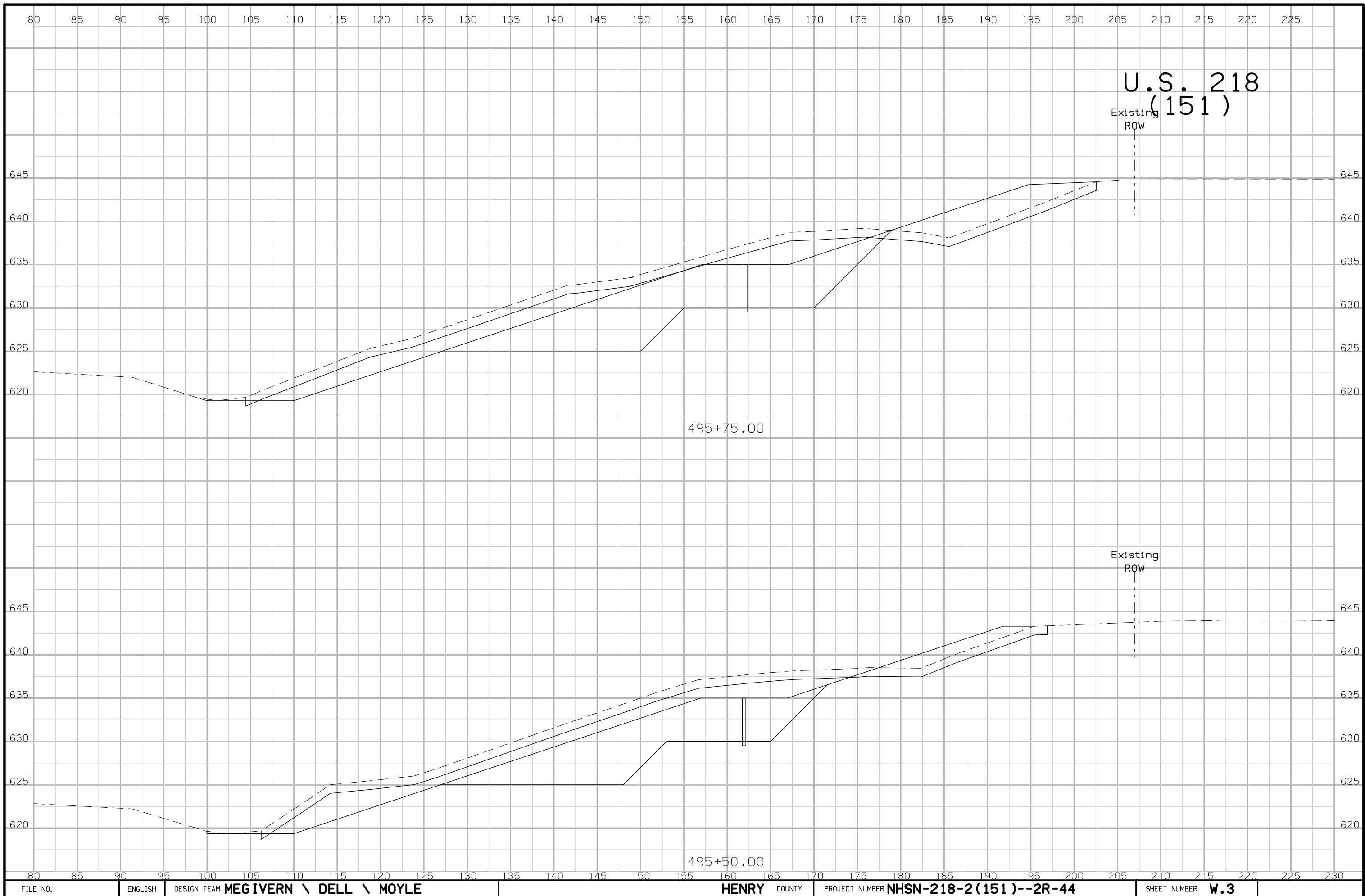

U.S. 218
(151)

Existing
ROW

495+75.00

Existing
ROW

495+50.00

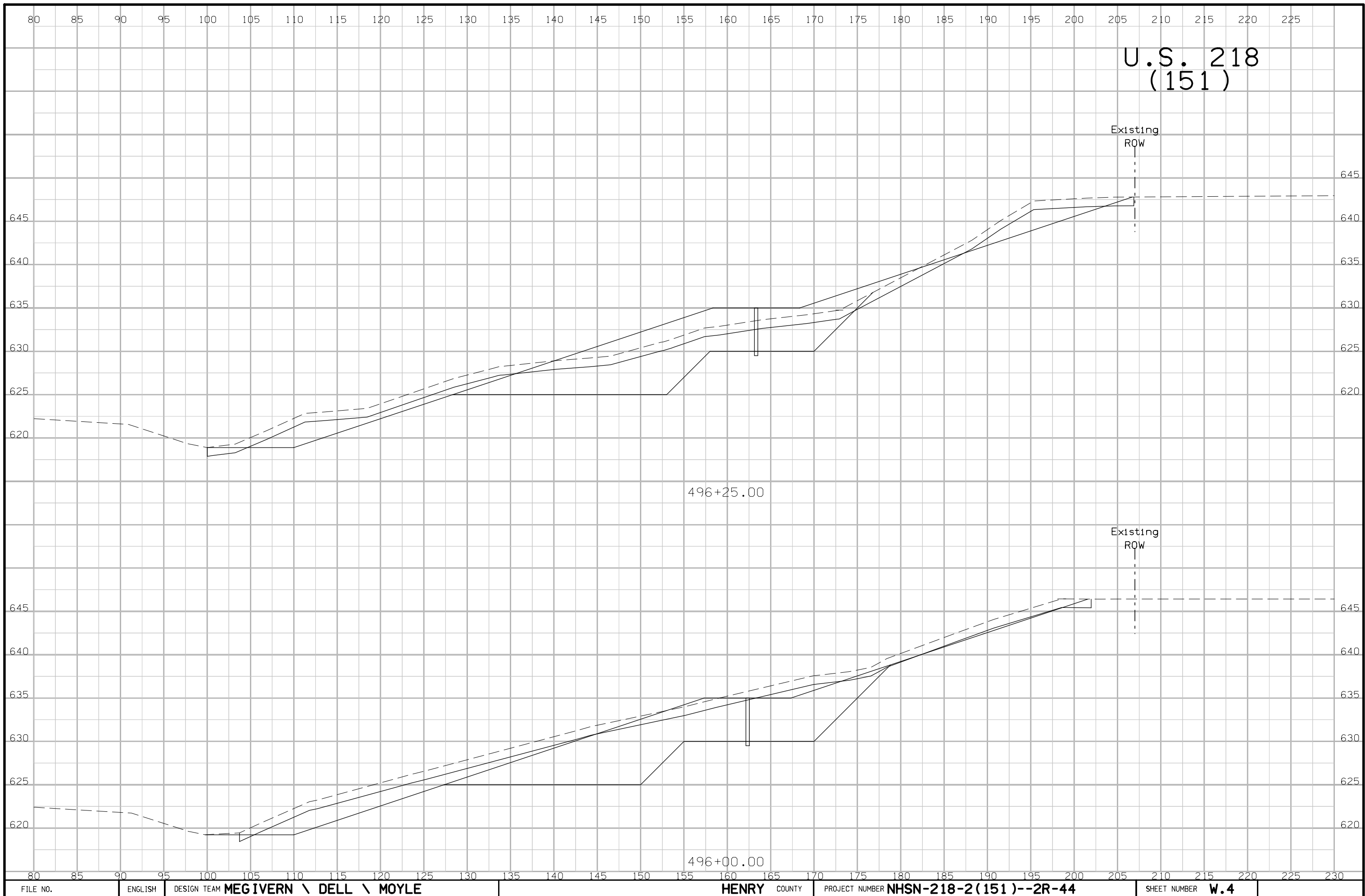



U.S. 218
(151)

Existing
ROW

496+75.00

Existing
ROW

496+50.00

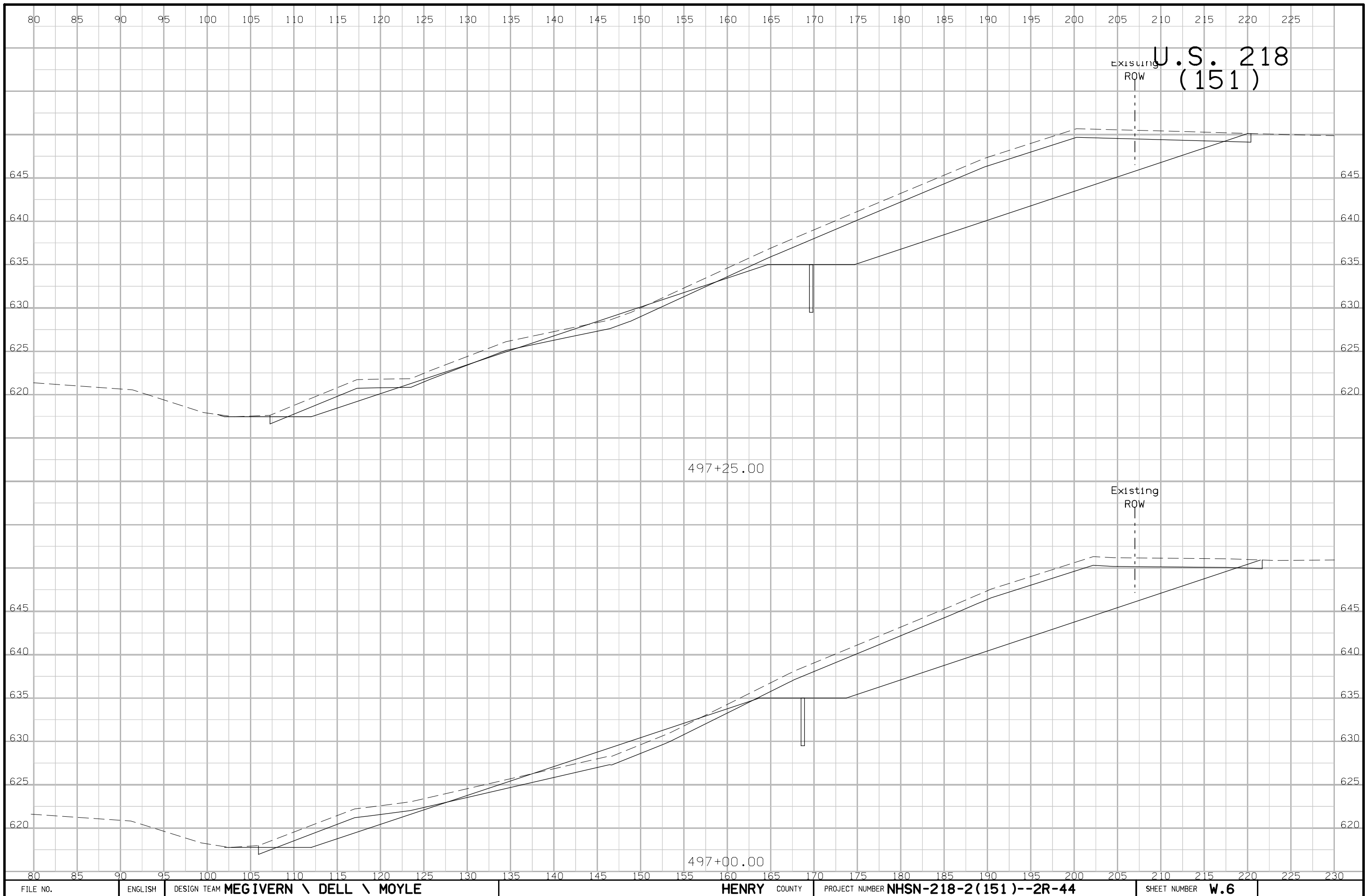

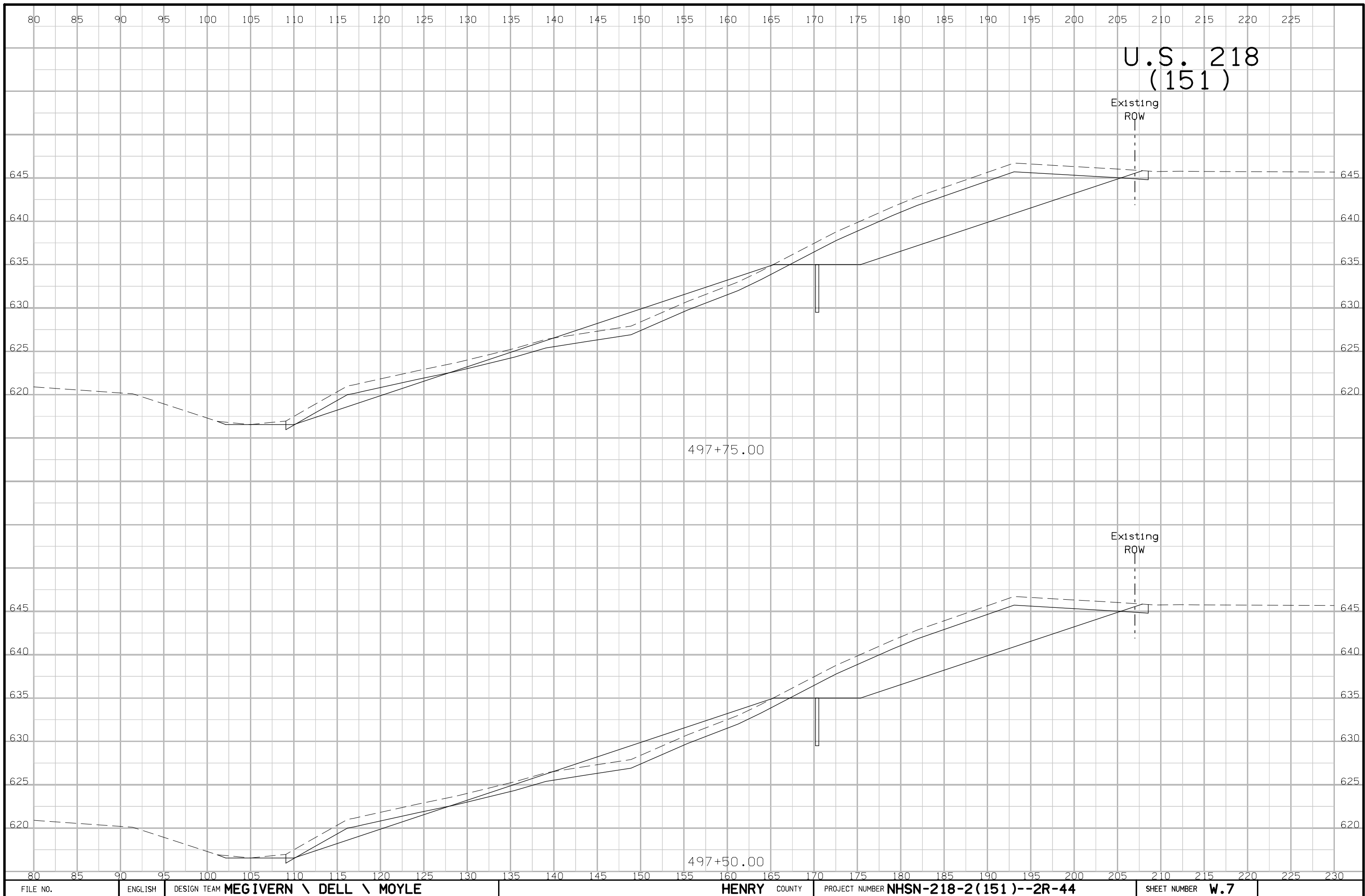

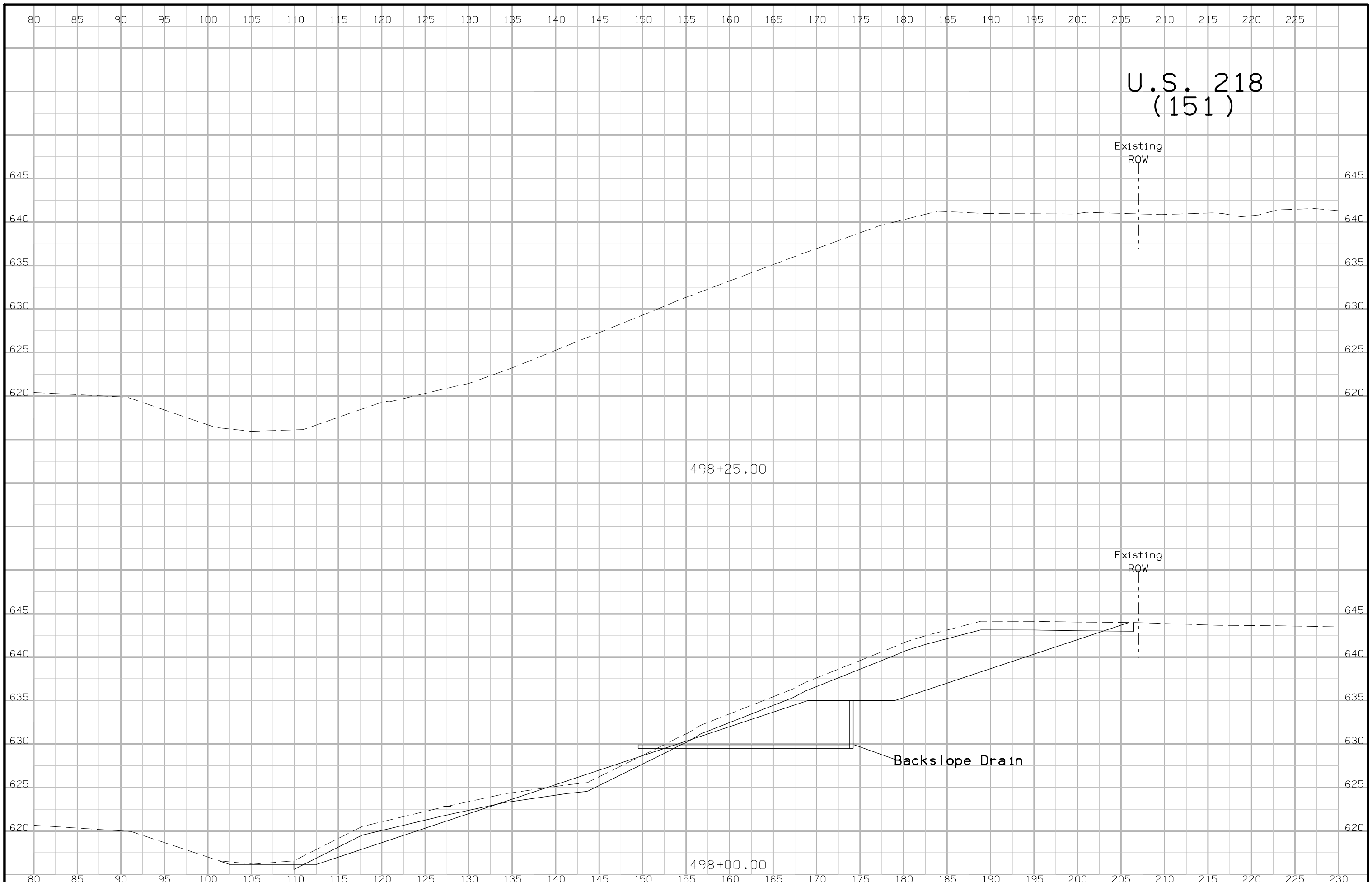

U.S. 218
(151)

Existing
ROW

498+25.00

Existing
ROW

Backslope Drain

498+00.00