



REVISIONS

TOTAL
16

PROJECT IDENTIFICATION NUMBER
23-64-330-020
PROJECT NUMBER
NHSN-330-2(099)--2R-64
R.O.W. PROJECT NUMBER

INDEX OF SHEETS	
No.	DESCRIPTION
A Sheets	Title Sheets
* A.1	Title Sheet/Location Map
* A.2 - 3	FE Questions
* A.3 - 4	Project Concept
B Sheets	Typical Cross Sections and Details
B.1	Typical Cross Sections and Details
D Sheets	Mainline Plan and Profile Sheets
* D.1	Plan & Profile Legend & Symbol Information Sheet
J Sheets	Traffic Control and Staging Sheets
J.1	Traffic Control Plan
W Sheets	Mainline Cross Sections
W.1 - 9	Mainline Cross Sections
	* Color Plan Sheets

PLANS OF PROPOSED IMPROVEMENT ON THE
PRIMARY ROAD SYSTEM
MARSHALL COUNTY
Ditch Improvement
At 250th St Intersection

SCALES: As Noted

Refer to the Proposal Form for list of applicable specifications.

Value Engineering Saves. Refer to Article 1105.14 of the Specifications.



Project Location
Ref. Loc. 18.87

INDEX OF SEALS		
SHEET NO.	NAME	TYPE
A.1	Jeremey Vortherms	Primary Signature Block

PRELIMINARY PLANS

Subject to change by final design.

D2 PLAN Date: 11/20/23

FIELD EXAM CHECKLIST

1 - Duration of project?

2 - Speed Limit

65 mph

3 - Speed Limit during construction

65 mph

4 - Is sight distance a problem?

N/A

5 - Patching quantities—full depth, partial depth, and surface.

N/A

6 - Does patching need to be done in the project area or do the construction limits need to be extended?
Who will provide locations of patches by milepost?

N/A

7 - Are rumble strips going to be placed with this project or a separate project?

N/A

8 - Leveling and strengthening locations and lengths (i.e. station to station).

N/A

9 - Areas of haul-outs.

Class 10 waste

10 - Any survey needed? (culvert extensions, safety dikes, right turn lanes, horizontal curves, ext...)

Yes ditch grades.

11 - Do any of the utilities need to be relocated (power/telephone poles) either permanently or temporarily for construction?

Sean Passick

12 - Names and addresses of affected utility companies.

Sean Passick

13 - Locations of entrances to be reshaped.

N/A

14 - Are there existing drainage problems?

Yes tile lines are silted in.

FIELD EXAM CHECKLIST

15 - Note any special features not shown on plan.

N/A

16 - Note condition of existing culverts.

17 - Names of affected special events.

18 - Locations of mailboxes to be relocated to a minimum of 8' from the pavement edge.

N/A

19 - Number and location of EF joints.

N/A

20 - Disposition of bridge handrail and guardrail, including posts.

N/A

21 - Inventory of existing guardrail.

N/A

22 - Remove & Reinstall Signs - District Maintenance or by the Contractor?

N/A

23 - Longitudinal joint repair locations (station to station).

N/A

24 - Locations and quantities of engineering fabric to be placed over random cracks.

N/A

25 - Tabulation of adjustment of fixtures.

N/A

26 - Clearing and grubbing quantities - by unit or by area?

N/A

27 - Resurfacing Projects - Is District Survey able to preserve Section Corners & Points?
If "no", then add these items under Construction Survey.

N/A

FIELD EXAM CHECKLIST

Contractor furnish borrow? (Yes) / (No)

N/A

Full depth patches to be PCC? (Yes) / (No)

N/A

Full depth PCC patches to be doveled? (Yes) / (No)

N/A

Soils to determine and provide tabulation of subdrains? (Yes) / (No)

Pollution Prevention Plan required? (Yes) / (No)

Field Office? (Yes) / (No)

Dustin?

Construction Survey and or Point Preservation by DOT or Contractor? See Dist. 1 Surveyor for this (DOT) / (Contractor).

N/A

Survey by Office of Design? (Yes) / (No)

Pavement markings for turn lanes as determined by the District? (Yes) / (No)

N/A

Any RWIS or Traffic Recorder Sites within project limits? (Yes) / (No)

N/A



FINAL PROJECT CONCEPT STATEMENT

IA 330 and 250th Street Ditch Improvements (Reference Location 18.90)

Marshall County
NHSN-330-2(099)—2R-64
PIN: 23-64-330-020

District 1 Office

Benjamin Adey, P.E.
515-239-1194

June 22, 2023

I. PROJECT AREA



A concept field review will not be held for this project.

LISTING OF PROJECT REVISIONS

Date **Marshall County**
 NHSN-330-2(099)--2R-64
 PIN: 23-64-330-020
 Page 2

Description of Revisions

1. Existing Conditions

The existing ditch in the northwest quadrant of the IA 330 and 250th St. intersection has silted in over time which has caused tile outlets in the ditch to be buried approximately 4 feet deep.



2. Proposed Concept

The existing ditch will be excavated and reshaped with no new fill being added to the ditch. The new ditch grade will match the as-built ditch grade from when the existing south bound lanes were originally constructed. In addition, the existing tile outlets will be relocated to the ROW line. Approximately 700 feet of ditch from 250th St. to the 12' x 8' RCB at station 712+08 will need to be reshaped.

3. Cost Estimate and Proposed Funding Sources

The cost of the proposed improvements is estimated at \$250,000. The project is funded with E&C funds.

4. Cost Estimate

Subdrain Outlets, DR-305 – 2 EA @ \$2,500 EA	\$5,000
Excavation, Class 10, Waste – 2,500 CY @ \$25/CY	\$62,500
Erosion Control	\$40,000
Mobilization	\$10,000
Traffic Control	\$10,000
Contingency (20%)	\$50,000
Total-	\$177,500

LISTING OF PROJECT REVISIONS

Date **Marshall County**
 NHSN-330-2(099)--2R-64
 PIN: 23-64-330-020
 Page 3

Description of Revisions

5. Proposed Schedule

D00 Pre-Design Concept	06/09/2023
D01 Survey Plan and Photogrammetry	06/09/2023
D02 Design Field Exam	07/03/2023
TE0 Desktop Review	07/14/2023
U00 Preliminary Utility Review	07/14/2023
W00 Preliminary Wetlands Review	07/14/2023
H00 Cultural Resources Assessment	08/04/2023
D06 Final Grade Plans	08/01/2023
L01 Letting - Grade	10/17/2023

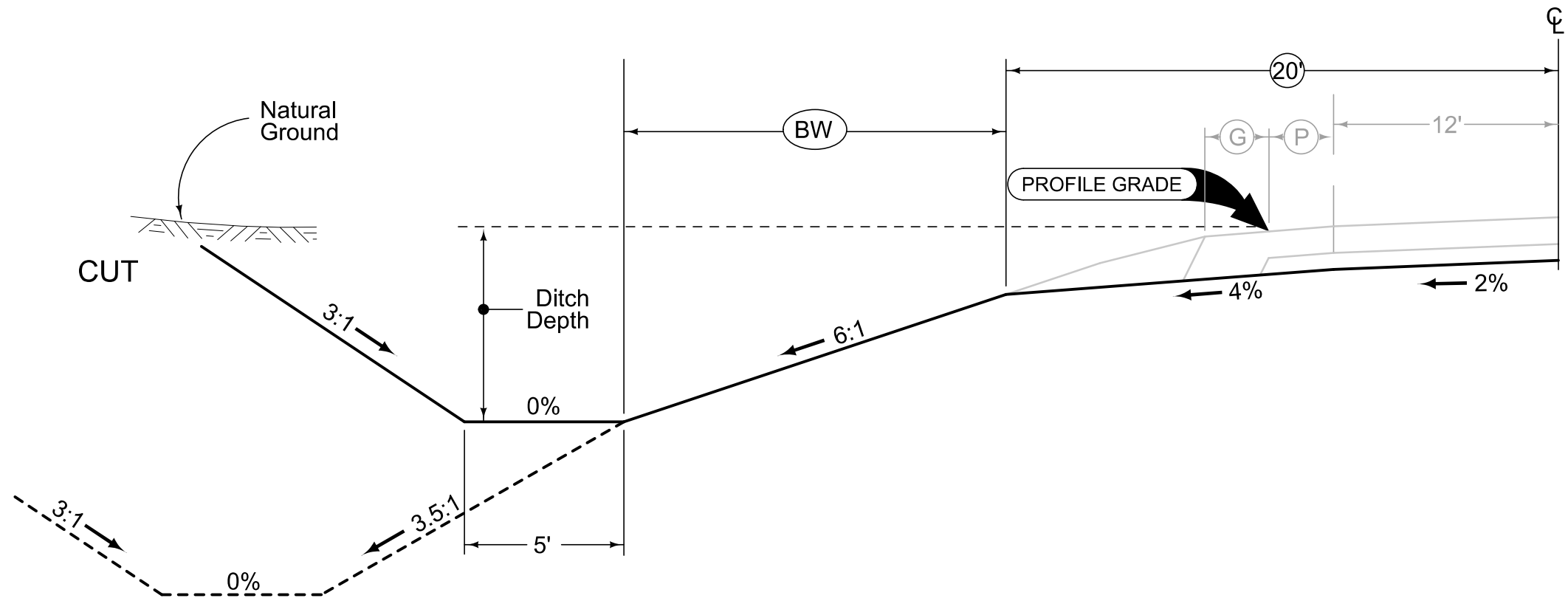

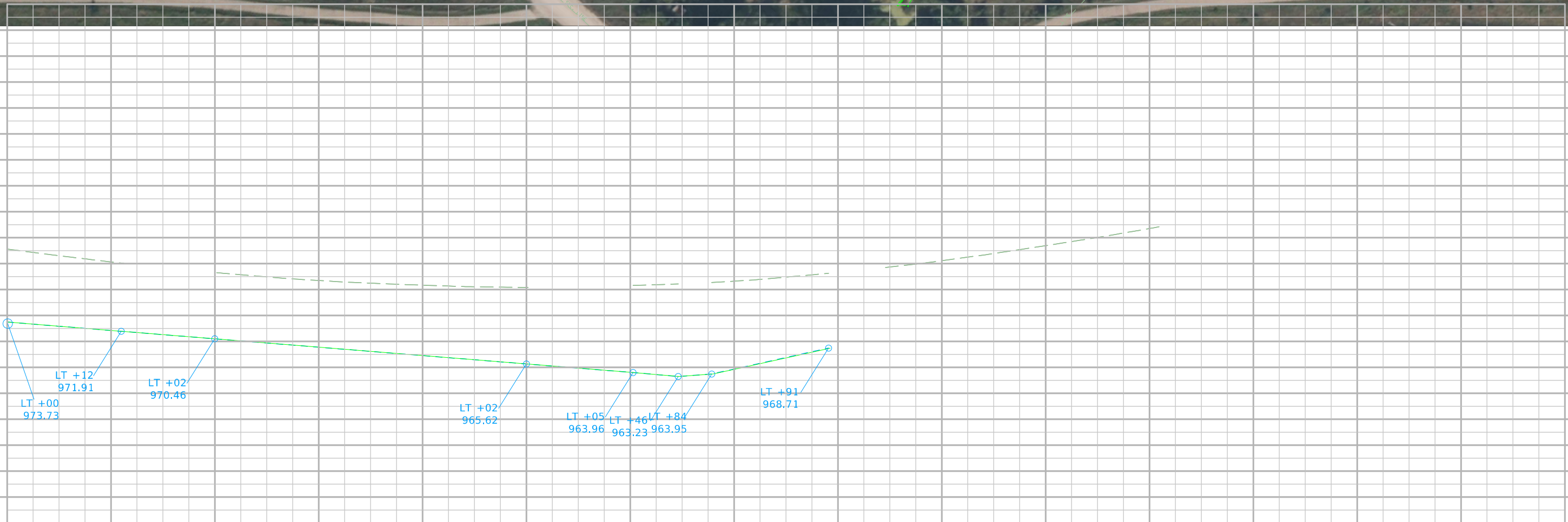

108-23A
08-01-08

TRAFFIC CONTROL PLAN

Traffic shall be maintained on IA 330 and all other side roads at all times.

108-25
10-21-14

511 TRAVEL RESTRICTIONS

Route	Direction	County	Location Description	Feature Crossed	Object Type	Maint. Bridge No., Structure ID, or FHWA No.	Type of Restriction	Existing Measurement	Construction Measurement	Construction Measurement as Signed	Projected As Built Measurement	Remarks
			None expected.									

ML - IA 330

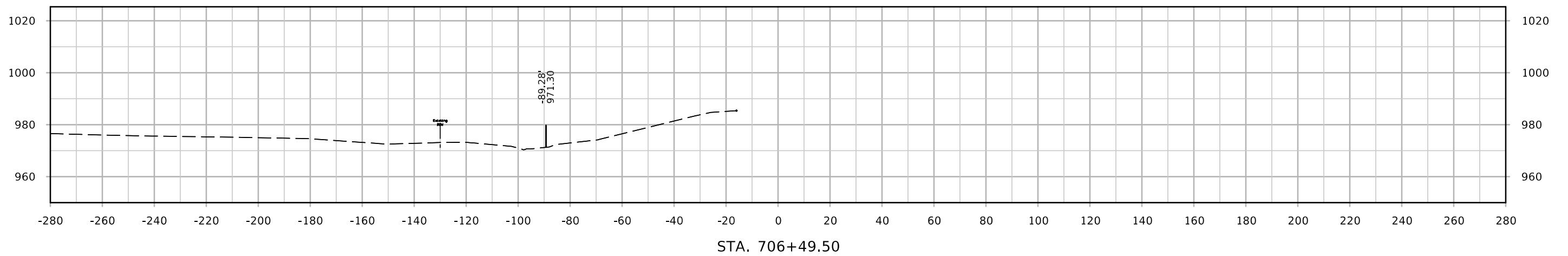
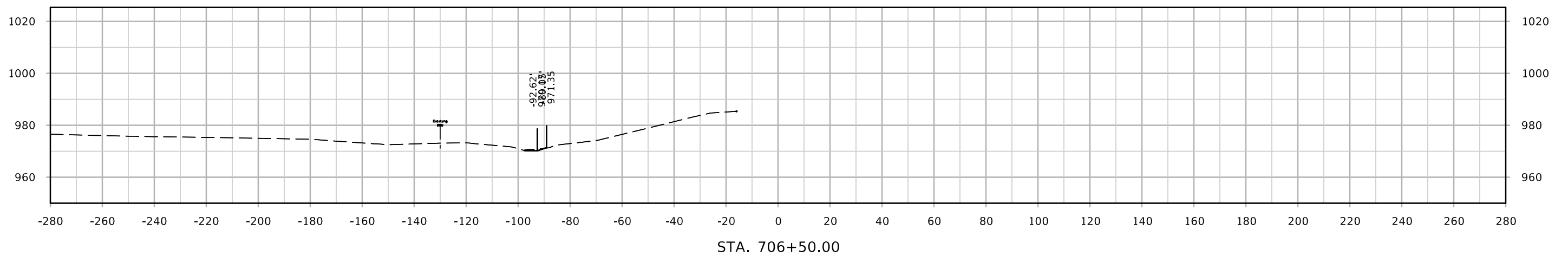
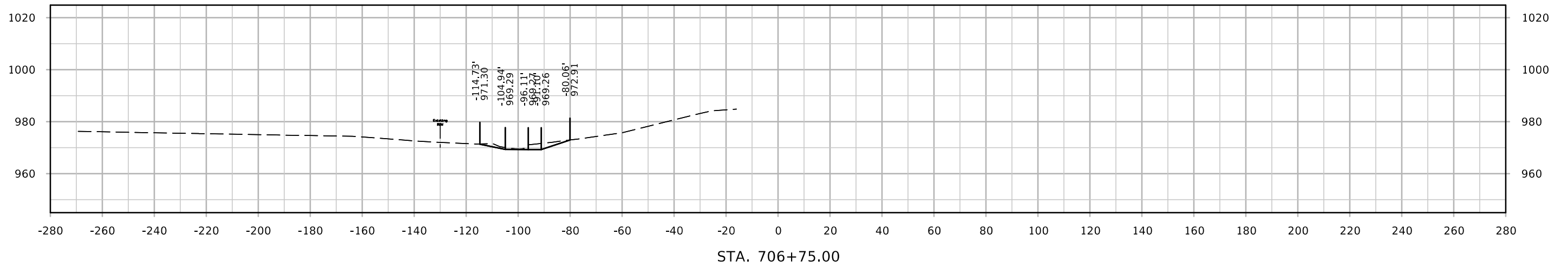

ML - IA 330

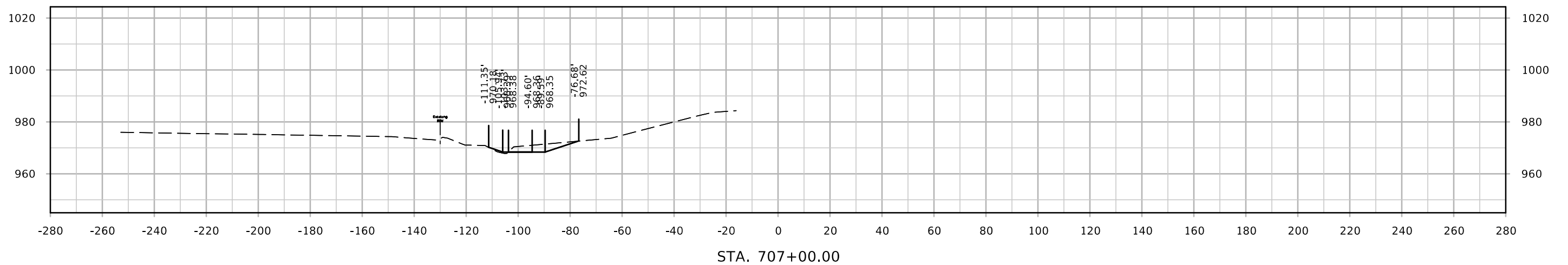
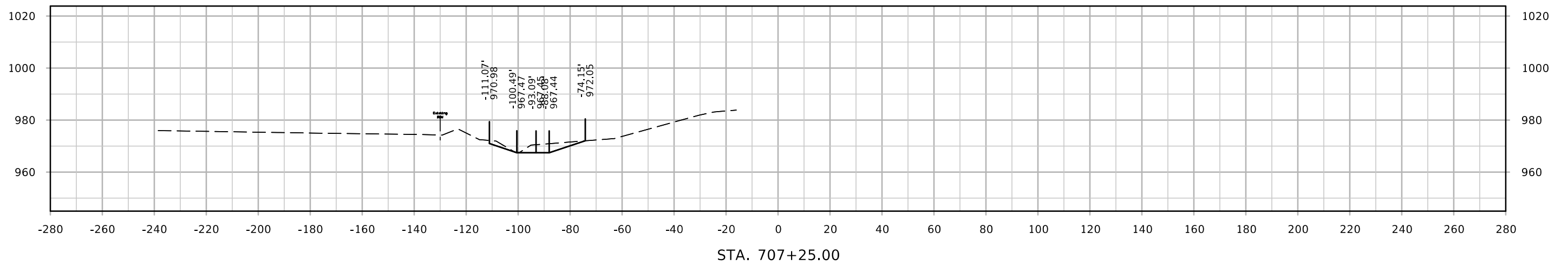
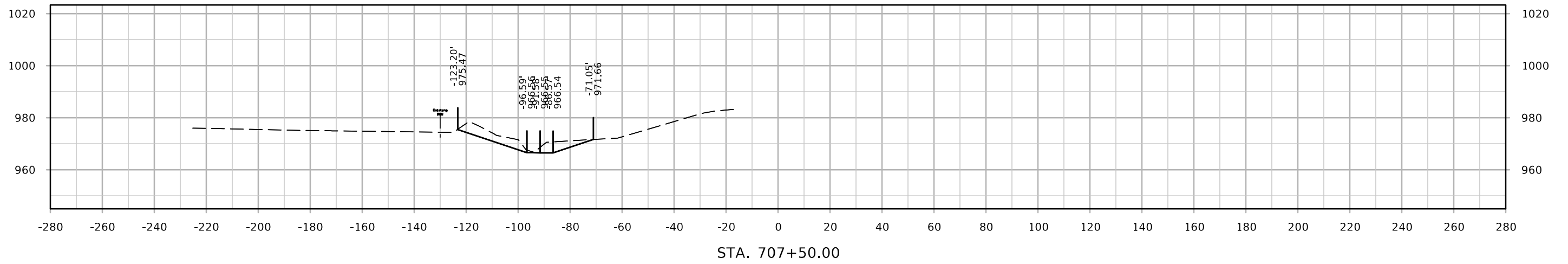

ML - IA 330

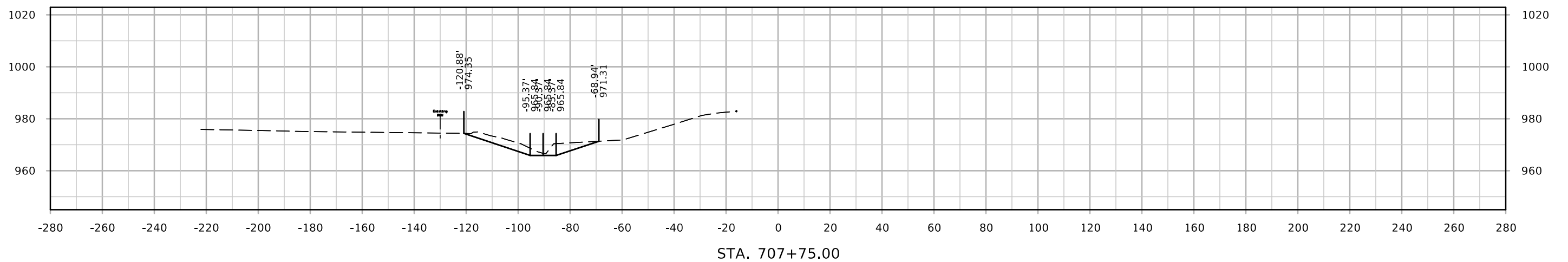
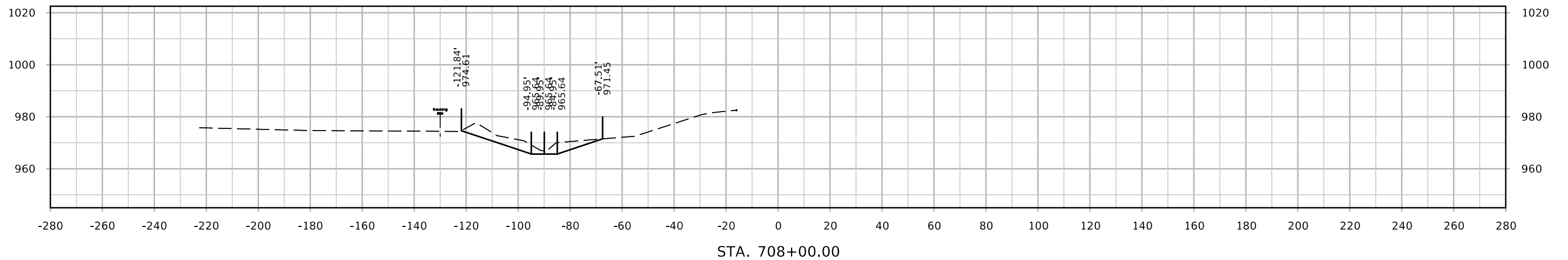
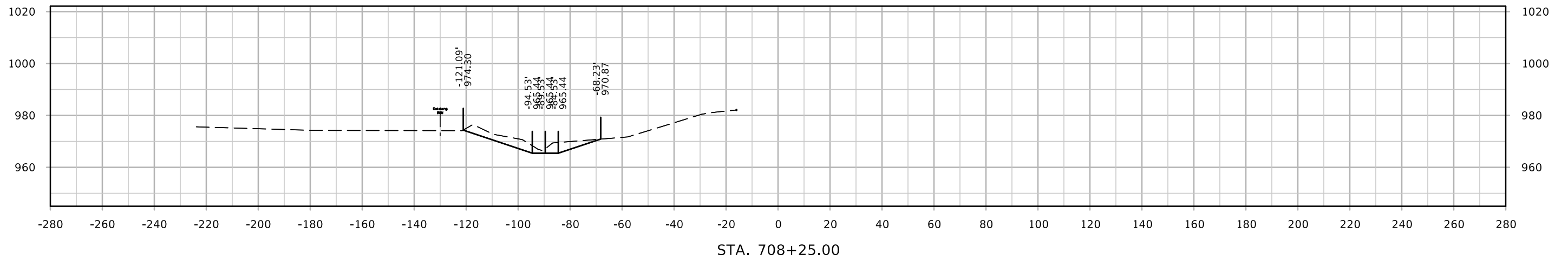

ML - IA 330

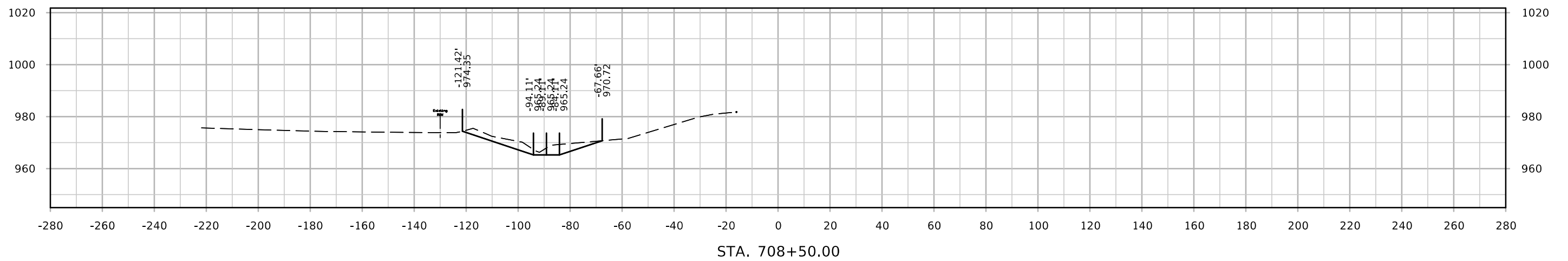
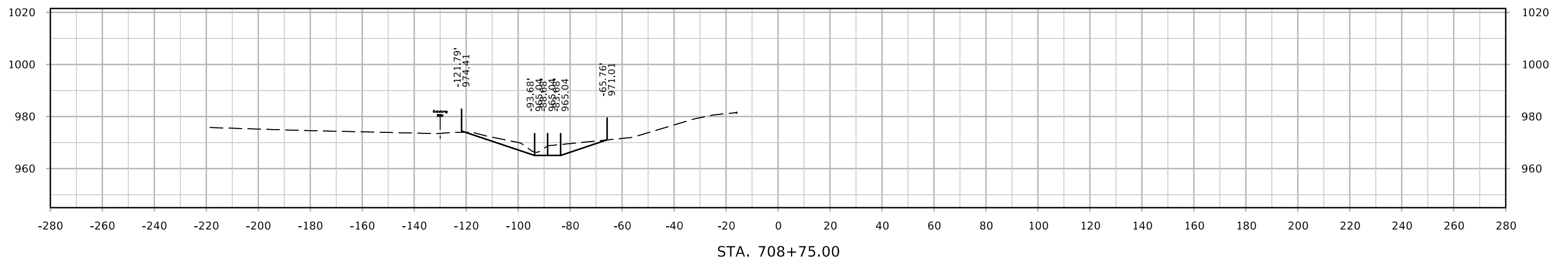
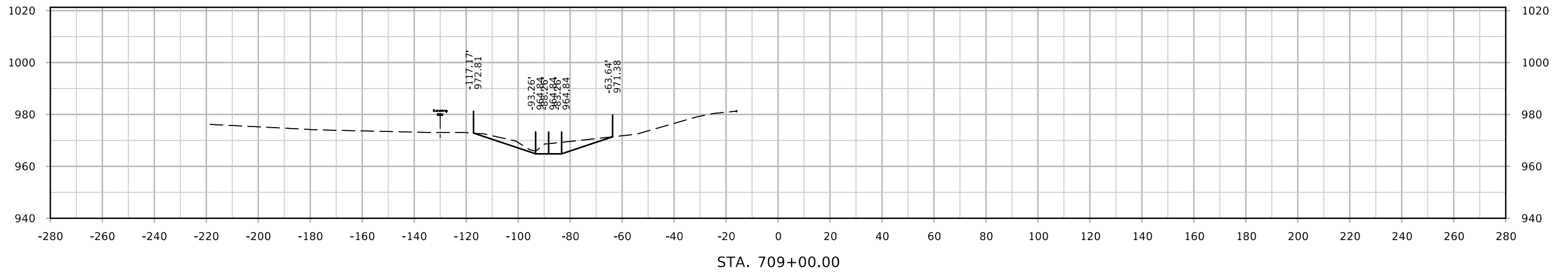

ML - IA 330

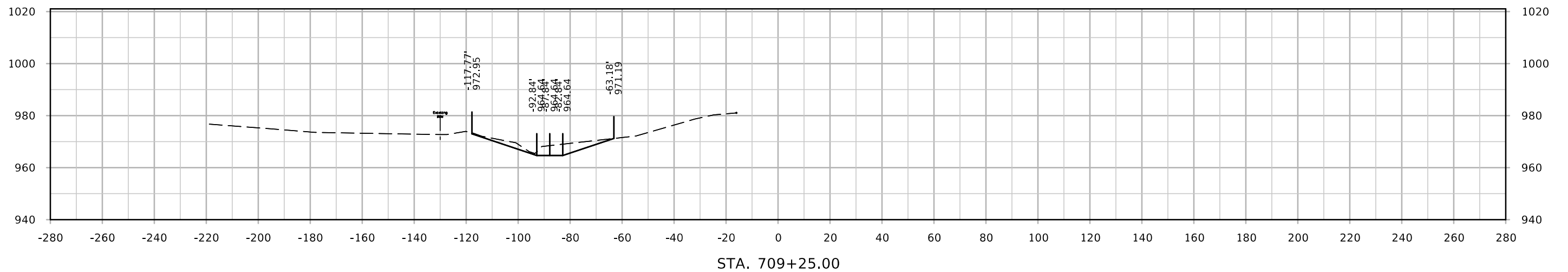
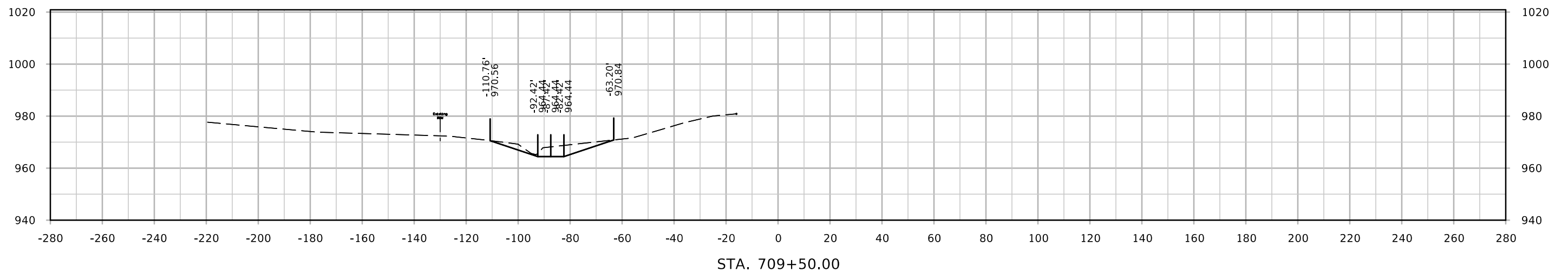
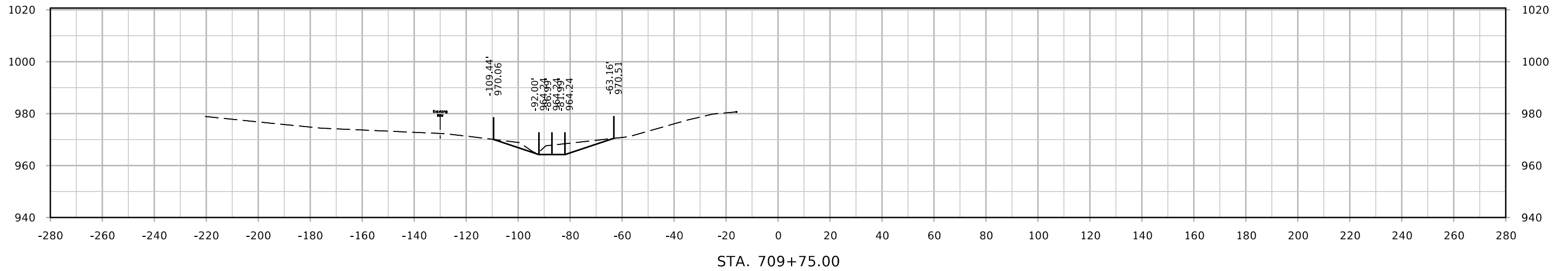

ML - IA 330

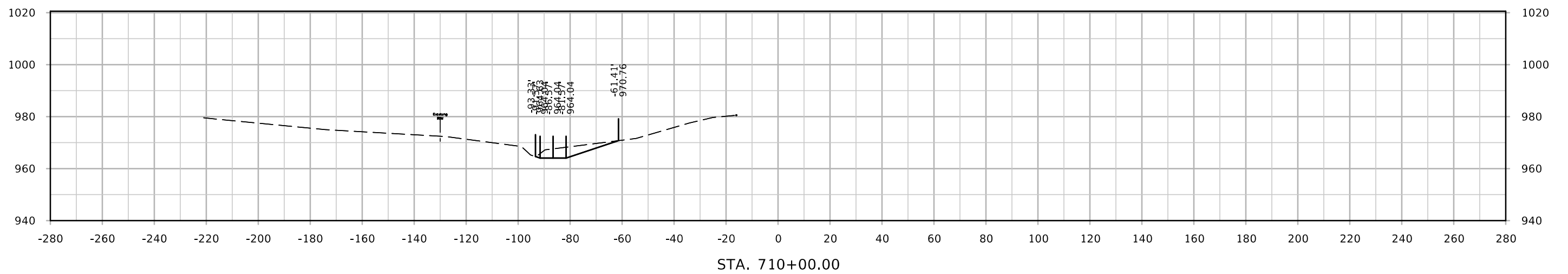
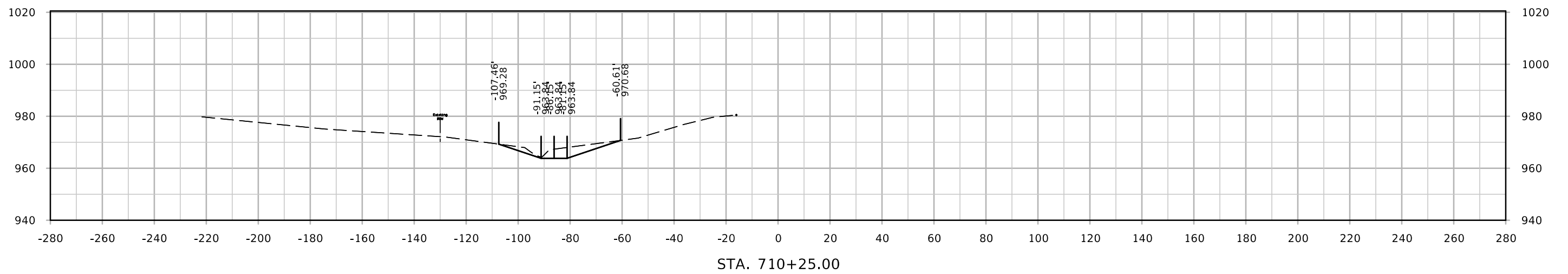
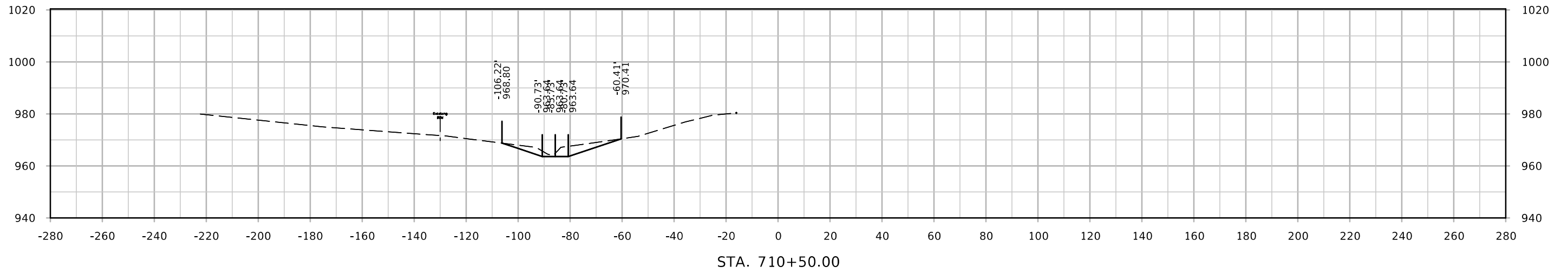

ML - IA 330

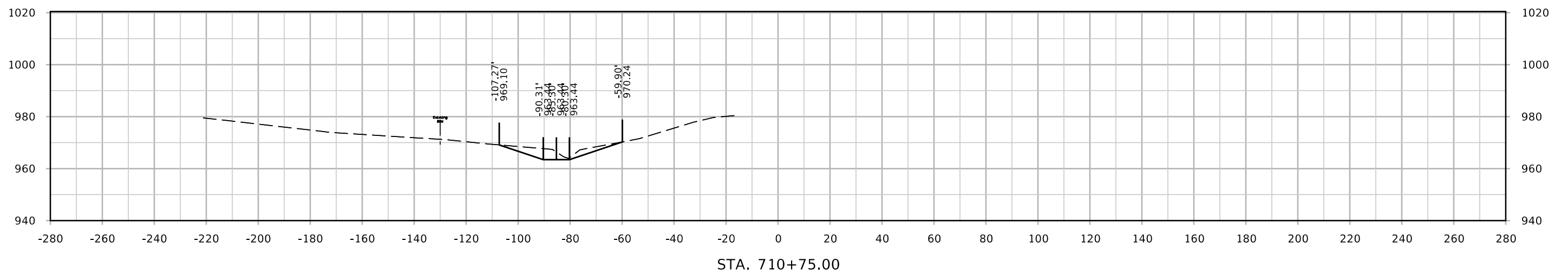
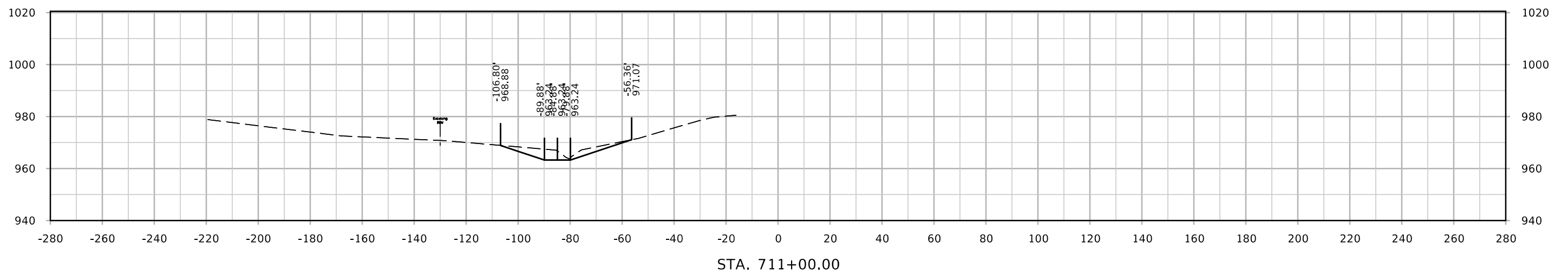
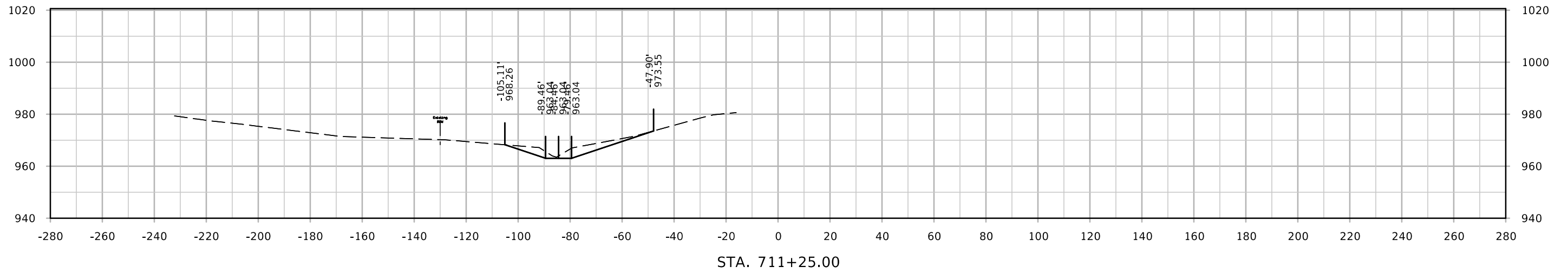

ML - IA 330

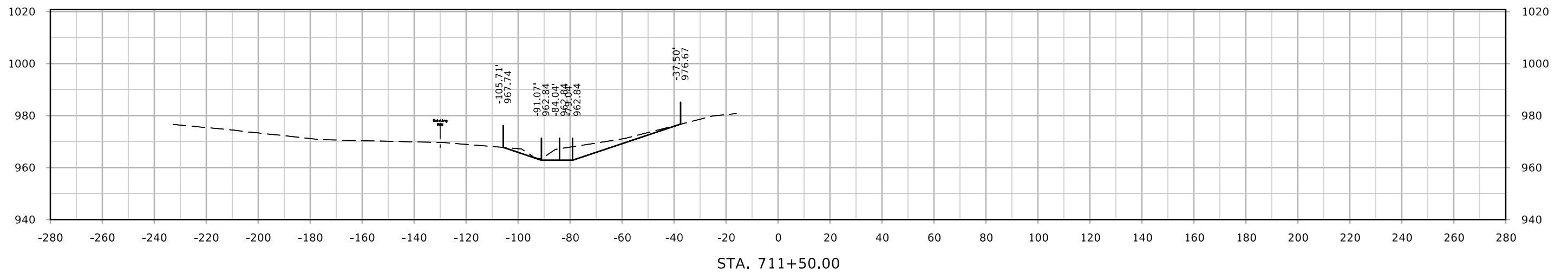
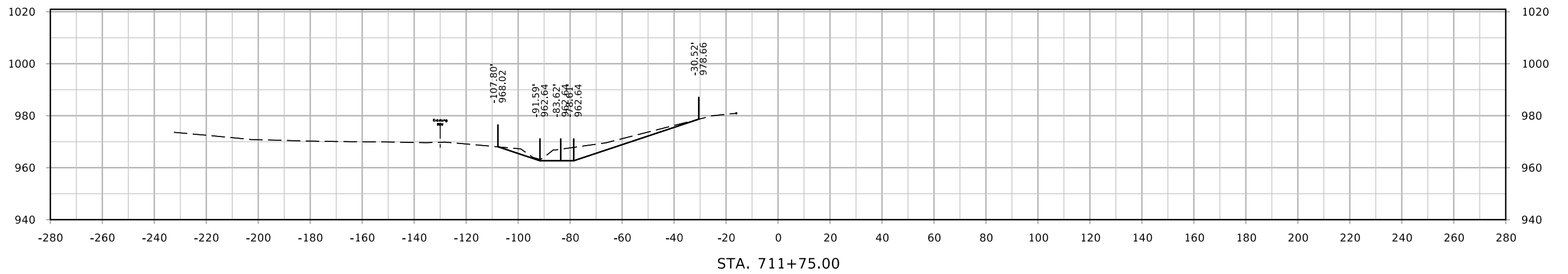
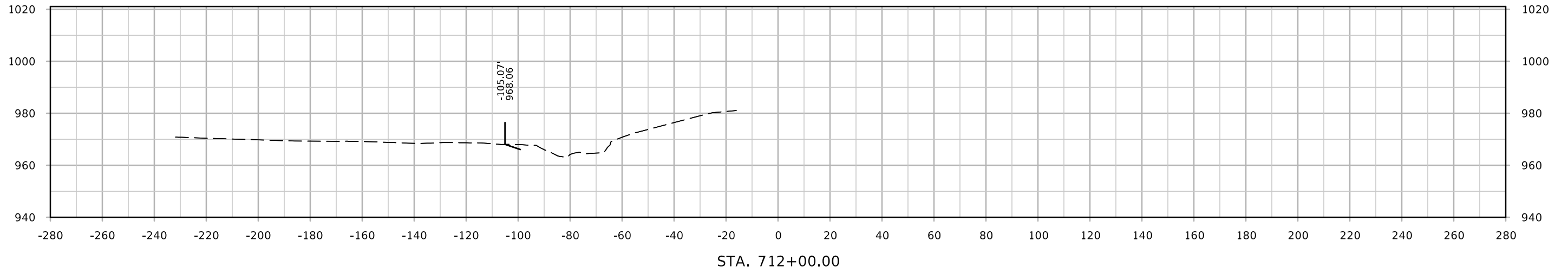

ML - IA 330

