

The existing signs adjacent to IA 141 will need to be removed and replaced.

Traffic volumes during construction are expected to be high enough to require special construction scheduling during peak hours. The contractor will be expected to accommodate two eastbound lanes during morning peak hours (6-9 a.m.) and two westbound lanes during afternoon peak hours (3-6 p.m.). One travel lane in each direction is required at all other times. Since a drop-off greater than 10 inches is prohibited at the edge of a travel lane at all times, the inside shoulders will only be removed in sections that can be replaced within one 21-hr. period. This will require night work. See Stage 1 detail below:

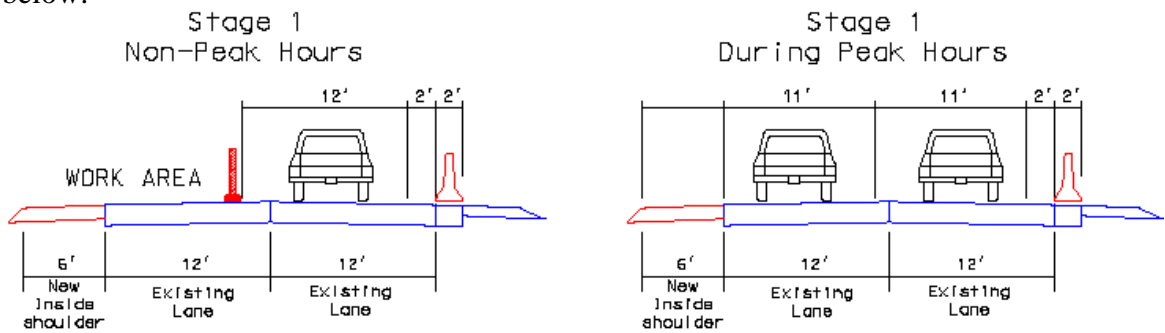

When inside shoulders are complete, traffic will be shifted to the inside to allow maximum space for construction activities on the outside. During this stage, two 11 foot traffic lanes will be provided in both directions and temporary barrier rail will be installed along the outside of the existing lane (see below). Temporary signals and temporary crash cushions will be installed at the intersections with SE 37<sup>th</sup> St., SE 19<sup>th</sup> St. and SE 11<sup>th</sup> Street. There will be access allowed at SE 28<sup>th</sup> Street, requiring a temporary crash cushion at the end of the TBR installation. See Stage 2 detail below.

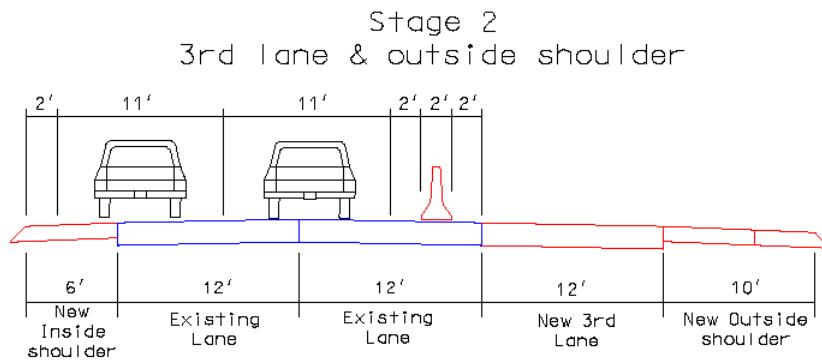

There will be short term closures at intersections and ramps while paving is completed with the contractor providing temporary access.

It appears right of way will be required.