

CLAY COUNTY

PCC CURB AND GUTTER
RRP-018-2(133)--48-21

LETTING DATE
Apr 19, 2022



PROJECT LOCATION
MP 80.41

PLANS OF PROPOSED IMPROVEMENT ON THE
PRIMARY ROAD SYSTEM
CLAY COUNTY
PCC CURB AND GUTTER

CP RR Crossing 0.05 mi N of 7th St in Spencer

SCALES: As Noted

Refer to the Proposal Form for list of applicable specifications.

Value Engineering Saves. Refer to Article 1105.14 of the Specifications.



REVISIONS

TOTAL

6

PROJECT IDENTIFICATION NUMBER

21-21-018-030

PROJECT NUMBER

RRP-018-2(133)--48-21

R.O.W. PROJECT NUMBER

NHSN-018-2(134)--2R-21

INDEX OF SHEETS

No.	DESCRIPTION
A Sheets	Title Sheets
A.1	Title Sheet & Location Map Sheet
B Sheets	Typical Cross Sections and Details
B.1	Typical Cross Sections and Details
D Sheets	Mainline Plan and Profile Sheets
* D.1	Plan View Information Sheet
J Sheets	Traffic Control and Staging Sheets
* J.1	Traffic Control Plan
U Sheets	500 Series, Mod.Stds. and Detail Sheets
U.1	Removals Detail Sheets
X Sheets	Cross Sections
X.1	Cross Sections
	* Color Plan Sheets

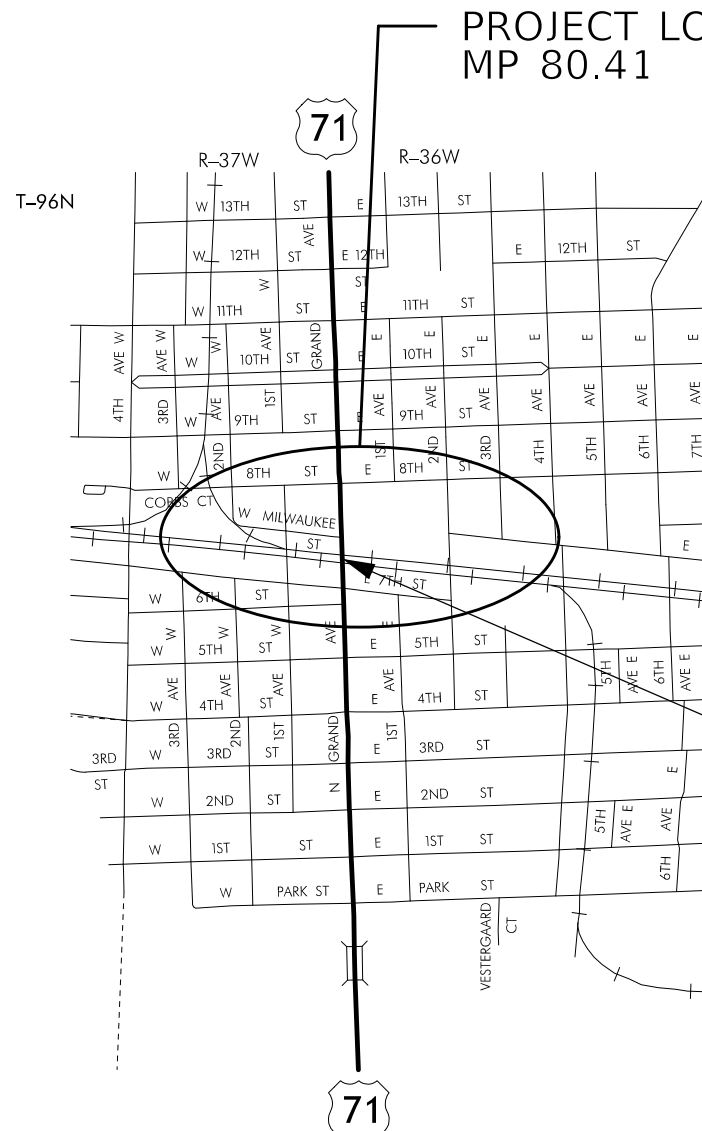

RR CROSSING # 385716S

PART OF THE
HIGHWAY AND STREET MAP
OF

SPENCER
IOWA

SCALE IN MILES

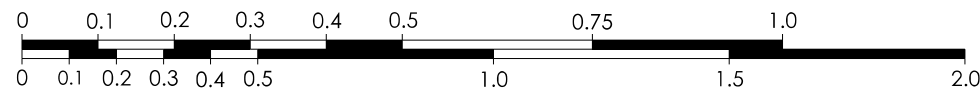

SCALE IN KILOMETERS



DESIGN DATA URBAN

2020 AADT	13,200	V.P.D.
2040 AADT	15,840	V.P.D.
2040 DHV	--	V.P.H.
TRUCKS	4	%
Total Design ESALs	--	

INDEX OF SEALS

SHEET NO.	NAME	TYPE
A.1	JASON M. KLEMME	Primary Signature Block
X	X	X

ROADWAY DESIGN

PRELIMINARY PLANS

Subject to change by final design.
 JASON M. KLEMME
 Printed or Typed Name
 My license renewal date is December 31, 20 23

Pages or sheets covered by this seal:
A.1, B.1-B.4, C.1-C.9, J.1, S.1-S.16

Design Rates	
Item	Rate
Surface Course	147 lbs./cu. ft.
Intermediate Course	147 lbs./cu. ft.
Milling	145 lbs./cu. ft.
Tack Coat	0.05 gal./sq. yd.

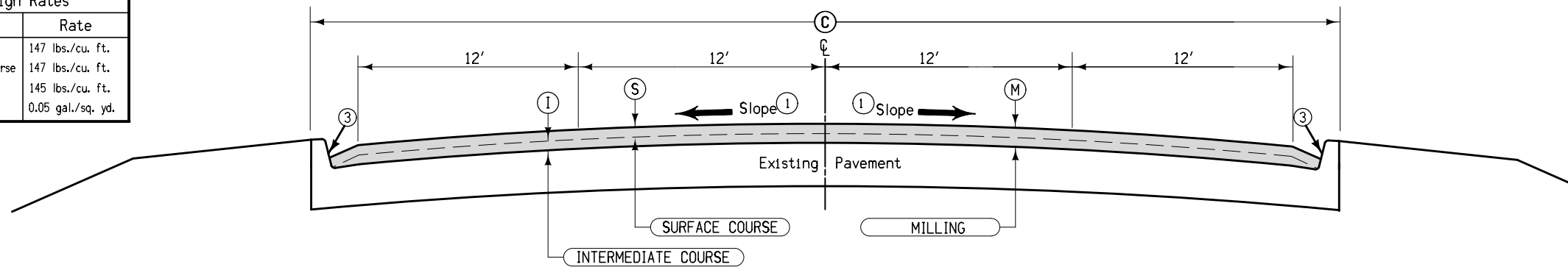

- ① Match finished slope to existing pavement, except that the maximum allowable slope is 3.0 %, minimum allowable slope is 2.0 %. Section may be modified as directed by the Engineer through areas of special shaping.
Refer to tabulation listing of superelevated curves and Standard Road Plans for additional requirements through superelevated curves.
- ② Tack Coat estimated for 2 applications. Includes sand seal application for both sides 6-in. wide at HMA joint with PCC curb.
- ③ 6" Standard Curb. Refer to Typical 6145B on Sheet B.2 for HMA placement next to curb.

Location		(M)	(I)	(S)	(C)	Resurfacing Quantities		Per Station		Milling S.Y.	Remarks
Road Identification	Station To Station	Inches	Inches	Inches	Feet	Tack Coat Gallons	Asphalt Binder Tons	Hot Mix Asphalt (Tons) Surface	Intermediate		
US 18	136+26.34 - 136+84.59	3.0	1.5	1.5	53	53.33	6.25	90.00	88.20	310.67	STOP AT RR TRACK APPROACH
US 18	137+37.09 - 138+50.13	3.0	1.5	1.5	53	53.33	6.25	90.00	88.20	602.88	RESUME AFTER RR TRACK APPROACH

**TYPICAL CROSS SECTION
HMA RESURFACING AND PAVEMENT
SCARIFICATION IN CURBED SECTION**

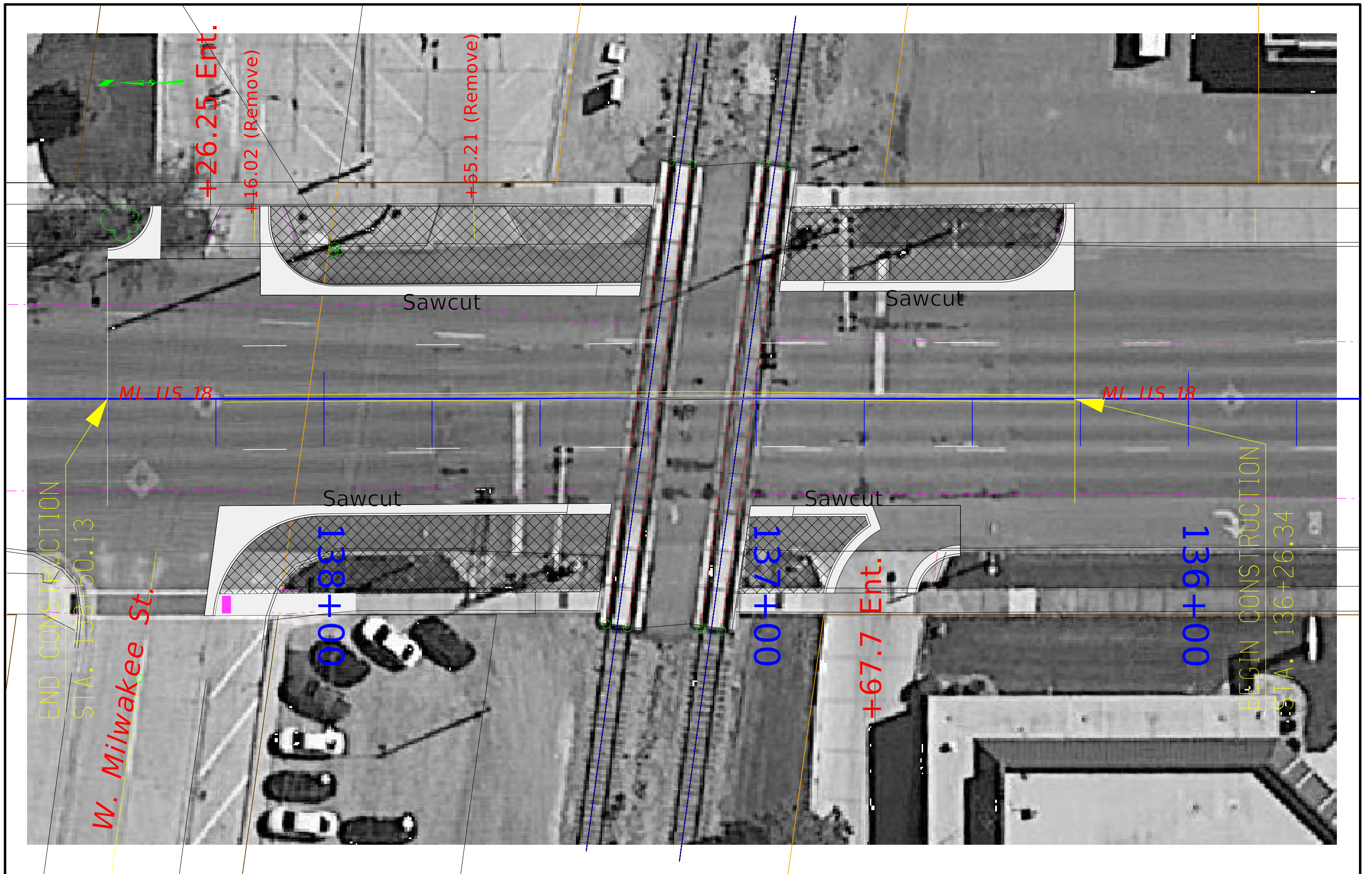

TRAFFIC CONTROL PLAN

1. Through traffic will be maintained on the project at all times.
2. Traffic control on this project shall be found in accordance with the TC series of Standard Road Plans found in Tab. 105-4 on Sheet C.1 and/or appropriate Detail Sheets included in the plans. For additional complementary information, refer to part VI of the Manual on Uniform Traffic Control Devices and the current Standard Specifications.
3. The contractor shall coordinate traffic control with other projects in the area.
4. "Rough Road" signs shall be erected in advance of scarified areas in accordance with Article 2214.05 of Standard Specifications.

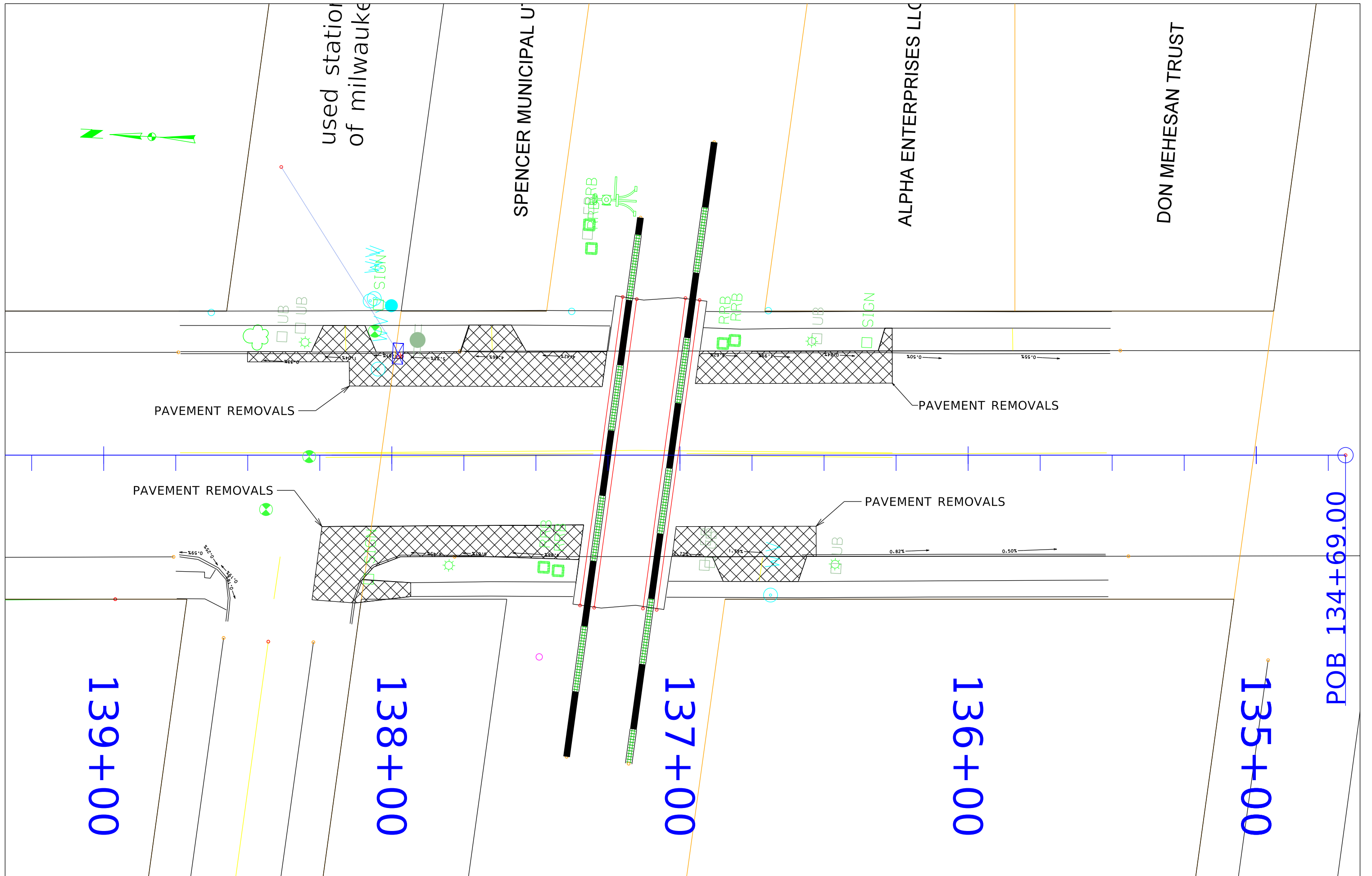

139+00

138+00

137+00

136+00

135+00

POB 134+69.00

Preliminary US 18

