

Lee County  
STPN-002-9(41)--2J-56  
PIN: 19-56-002-020

**LOCATION MAP:**

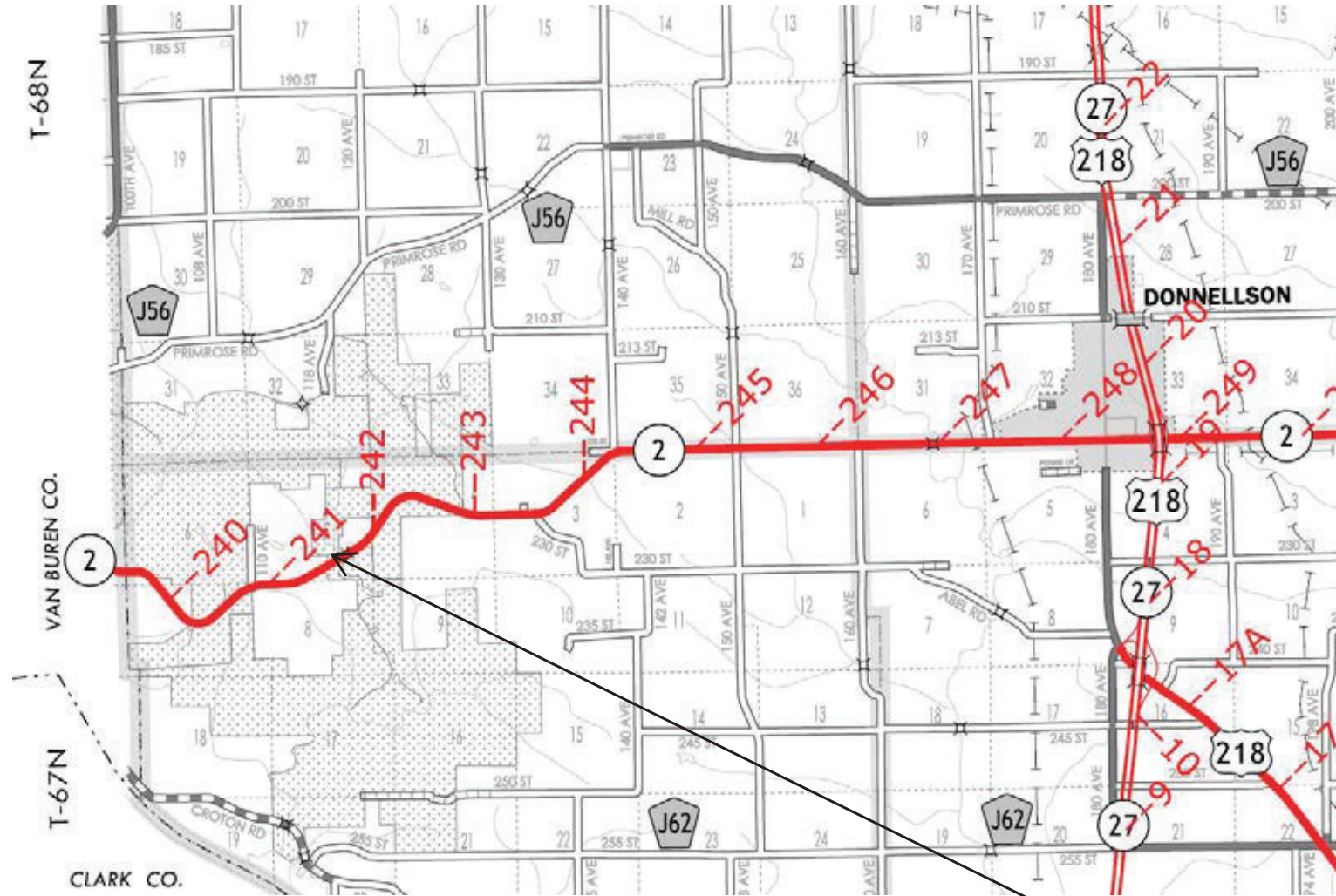

IA 2 MM 241.6

NO ACCESS RIGHTS ARE TO BE ACQUIRED ON THIS PROJECT.



SE 1/4 SW 1/4  
SEC. 5-67-07



①  
BOB A. & NANCY L. HEATON

24" x 43'  
H.D.P.E.

92+65  
±115'±Ex.Cor

93+20  
±95'

93+75  
±56'±Ex.Cor

91+00 92+00 93+00 94+00

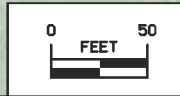

<b>Right of Way Design Information</b>	
<b>THIS SHEET INCLUDED FOR INFORMATION ONLY</b>	
ROW Team: CUVA /CARMAN	
ROW #: STPN-002-9(42)--2J-56	
Plan Date: 01/05/2021	
Color Legend:	
	Property Lines
	Temporary Easement
	Permanent Acquisition



# IA 2

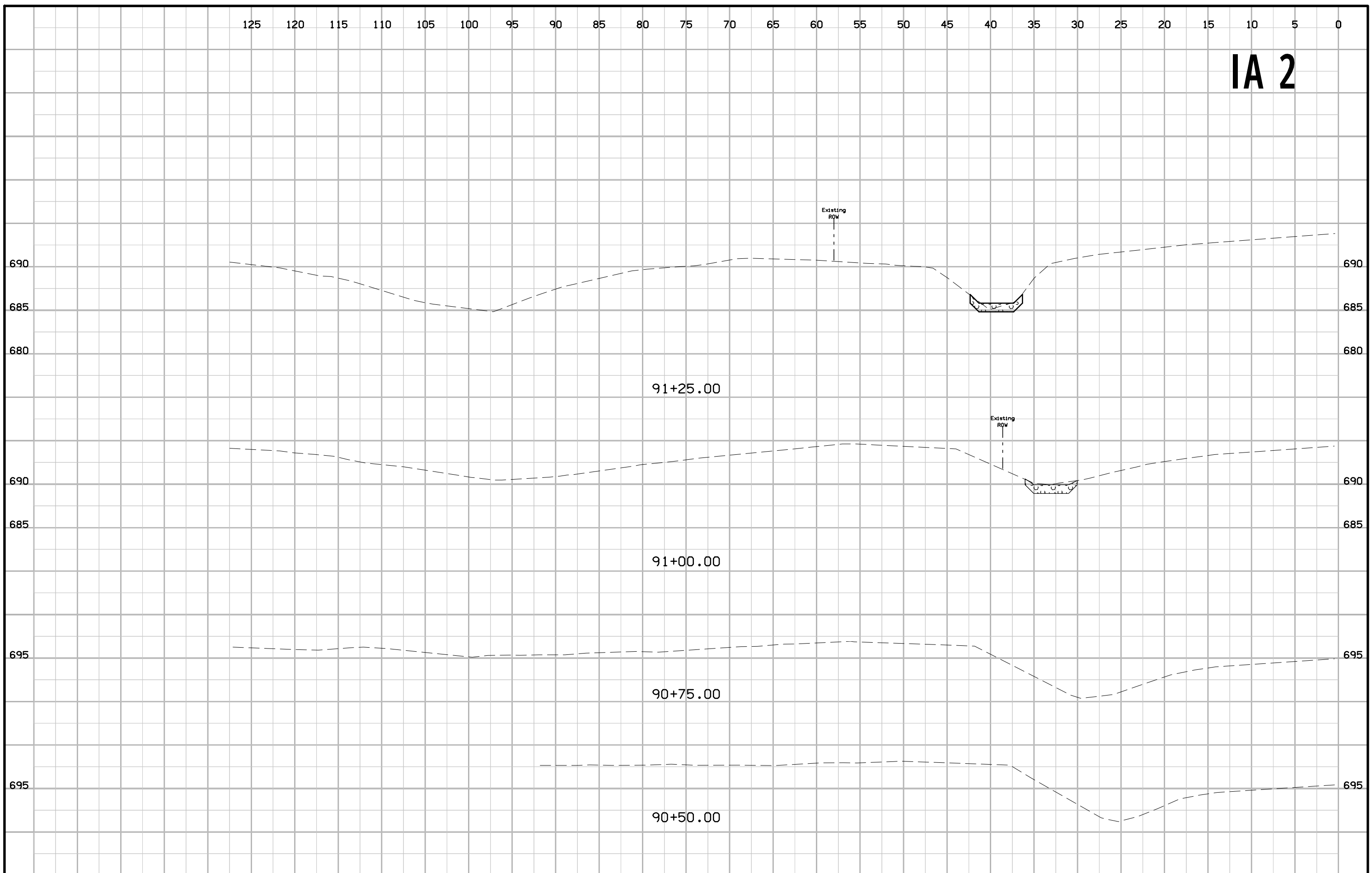



# IA 2

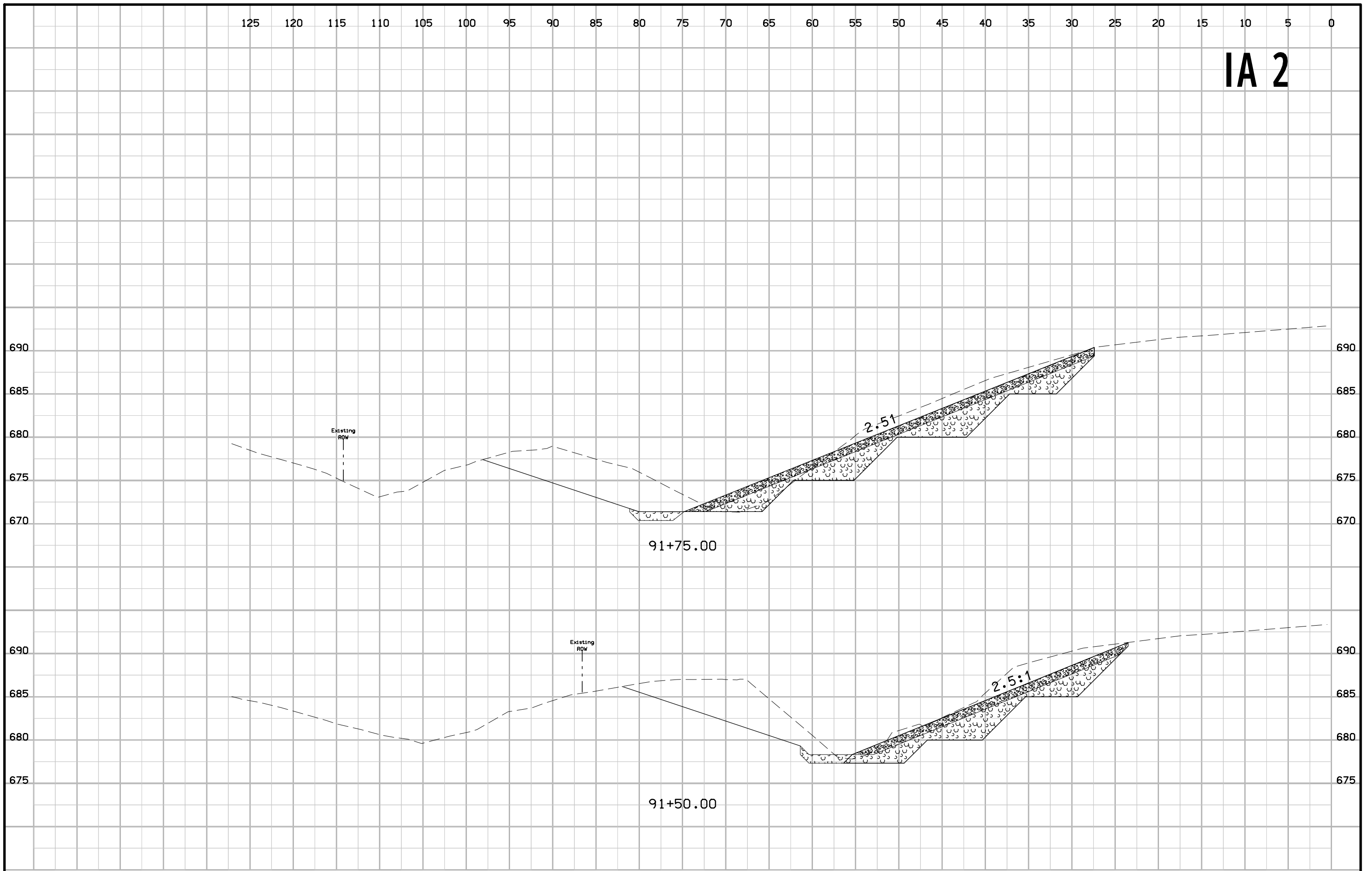

# IA 2

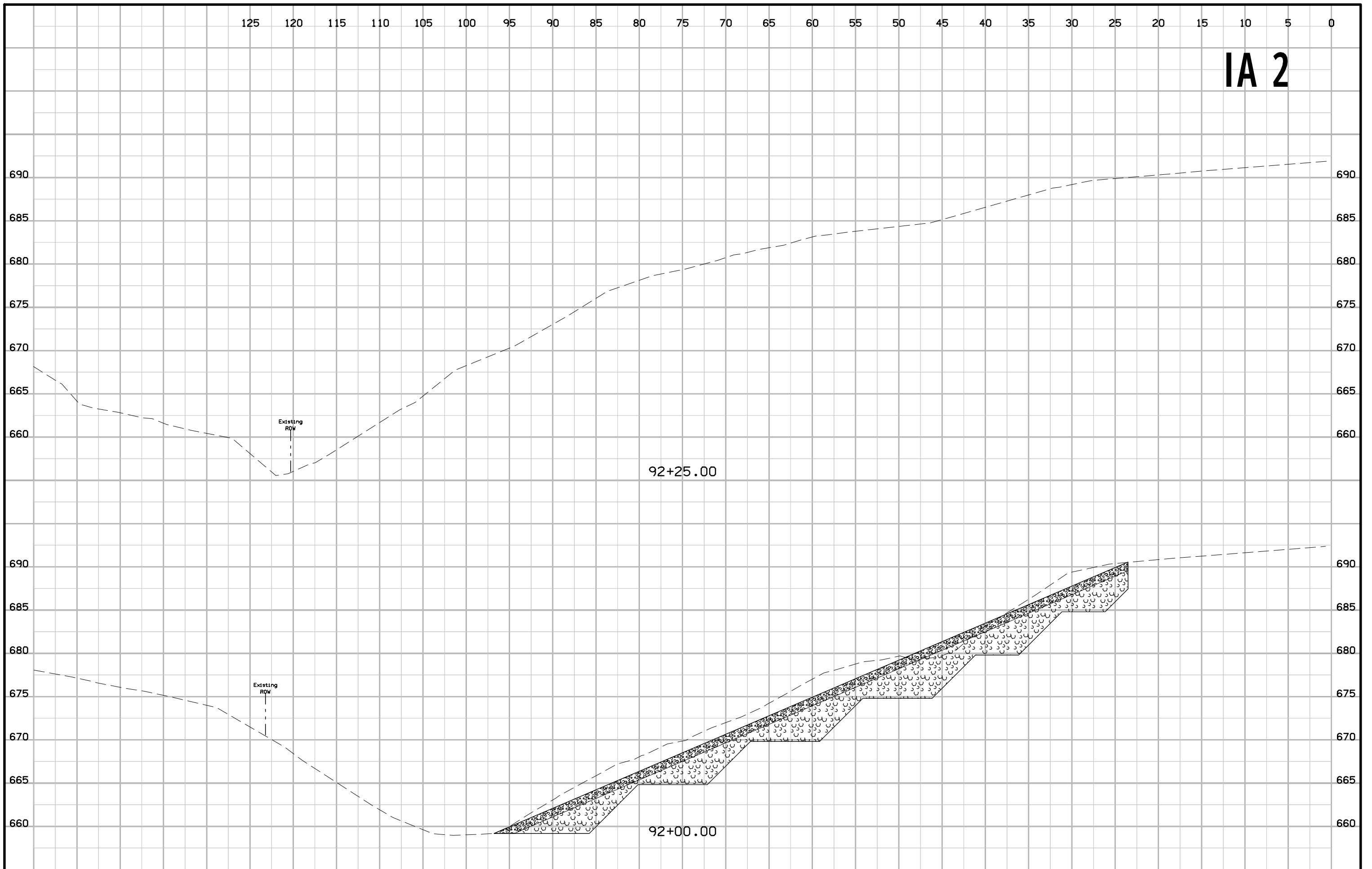

92+25.00

92+00.00



# IA 2

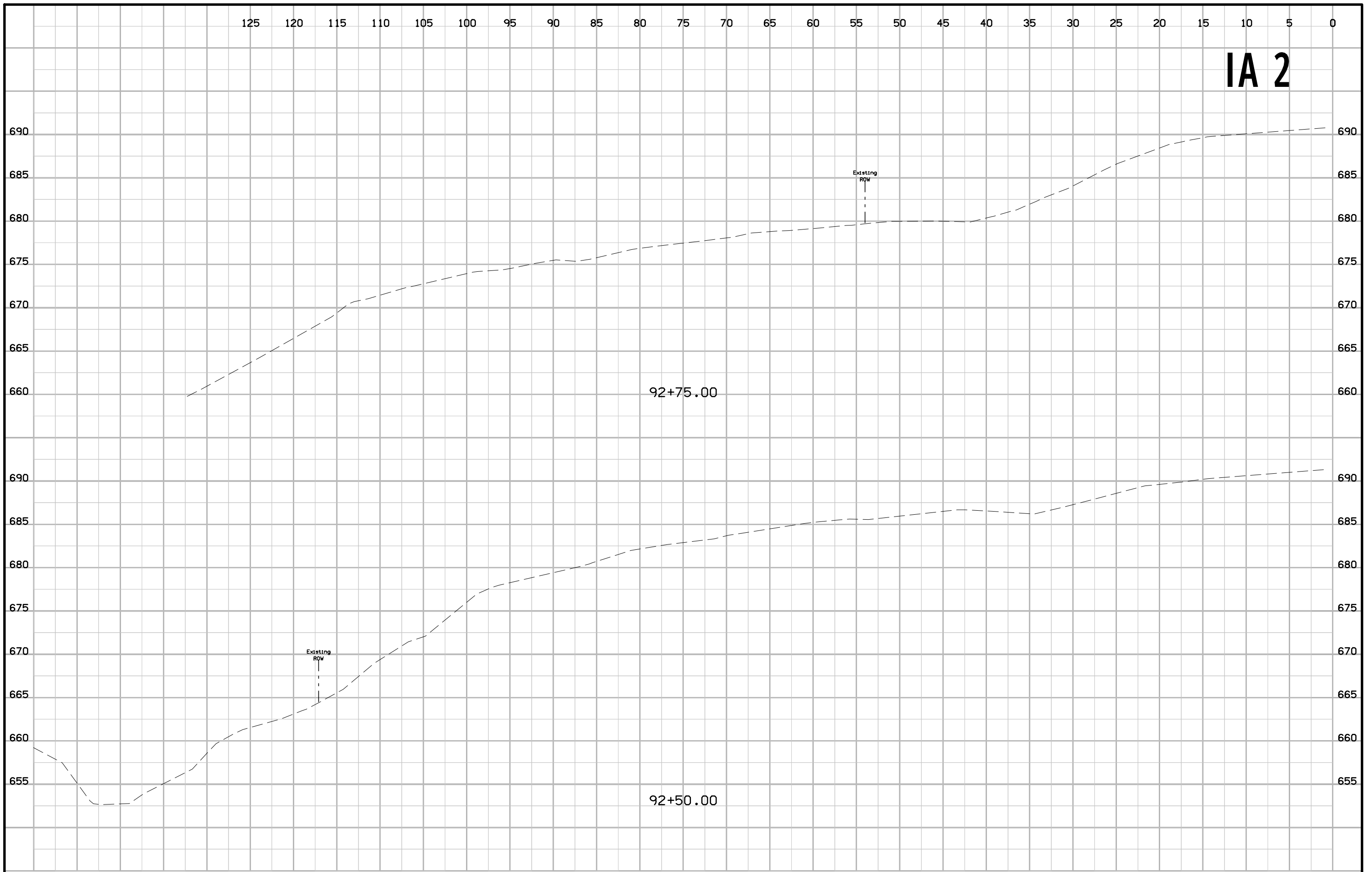

# IA 2

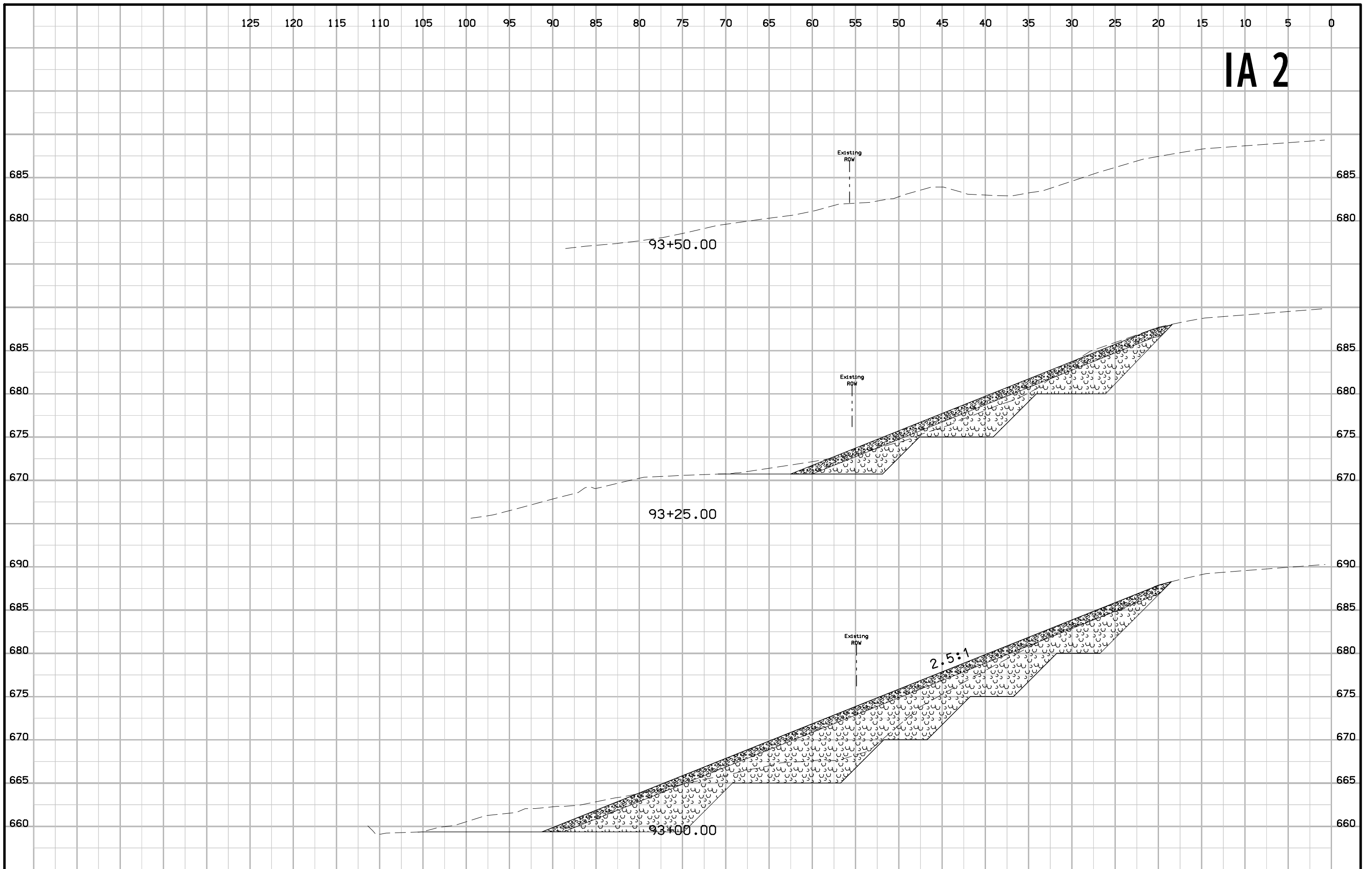



125 120 115 110 105 100 95 90 85 80 75 70 65 60 55 50 45 40 35 30 25 20 15 10 5 0

IA 2

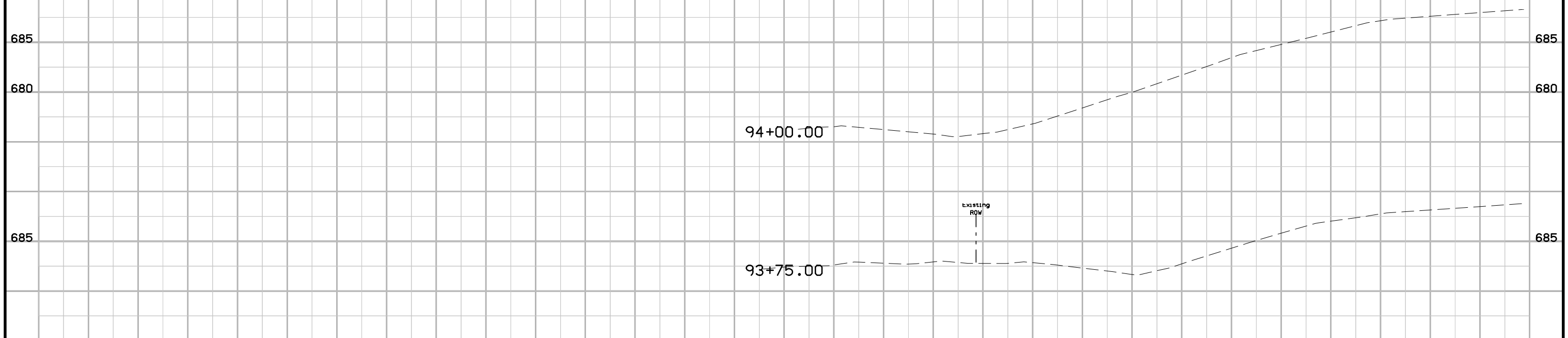

125 120 115 110 105 100 95 90 85 80 75 70 65 60 55 50 45 40 35 30 25 20 15 10 5 0