

EMMET COUNTY

STPN-004-6(40)--2J-32
RCB Culvert Extension - Twin Box

LETTING DATE
May 21 2024



REVISIONS

TOTAL
17

PROJECT IDENTIFICATION NUMBER
32-0046-040
PROJECT NUMBER
STPN-004-6(40)--2J-32
R.O.W. PROJECT NUMBER
STPN-004-6(36)--2J-32

PLANS OF PROPOSED IMPROVEMENT ON THE
PRIMARY ROAD SYSTEM
EMMET COUNTY
RCB Culvert Extension - Twin Box
 0.24 mi E of 390th Ave to
 0.54 mi E of 390th Ave

SCALES: As Noted

INDEX OF SHEETS	
No.	DESCRIPTION
A Sheets	Title Sheets
A.1	Title Sheet
A.2	Location Map Sheet
D Sheets	Mainline Plan Sheets
* D.1 - 2	IA 4
W Sheets	Mainline Cross Sections
* W.1 - 13	Mainline Cross Sections
	* Color Plan Sheets

Refer to the Proposal Form for list of applicable specifications.

Value Engineering Saves. Refer to Article 1105.14 of the Specifications.



For Project Location Map
Refer to Sheet No. A.2

DESIGN DATA RURAL	
2023 AADT	930 V.P.D.
2043 AADT	1,116 V.P.D.
2043 DHV	-- V.P.H.
TRUCKS	13.4 %
Total Design ESALs	--

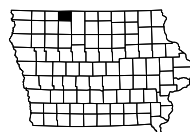

PRELIMINARY PLANS

Subject to change by final design.

D5 PLAN - Date: 8/25/23

PROJECT LOCATION
 STA. 322+00 to 331+00
 MP 144.32 to 144.49

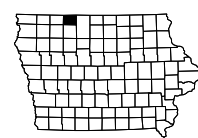
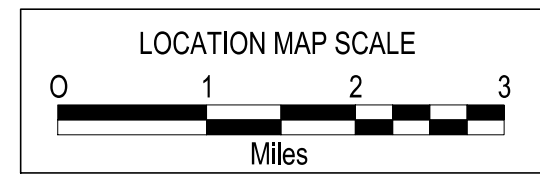
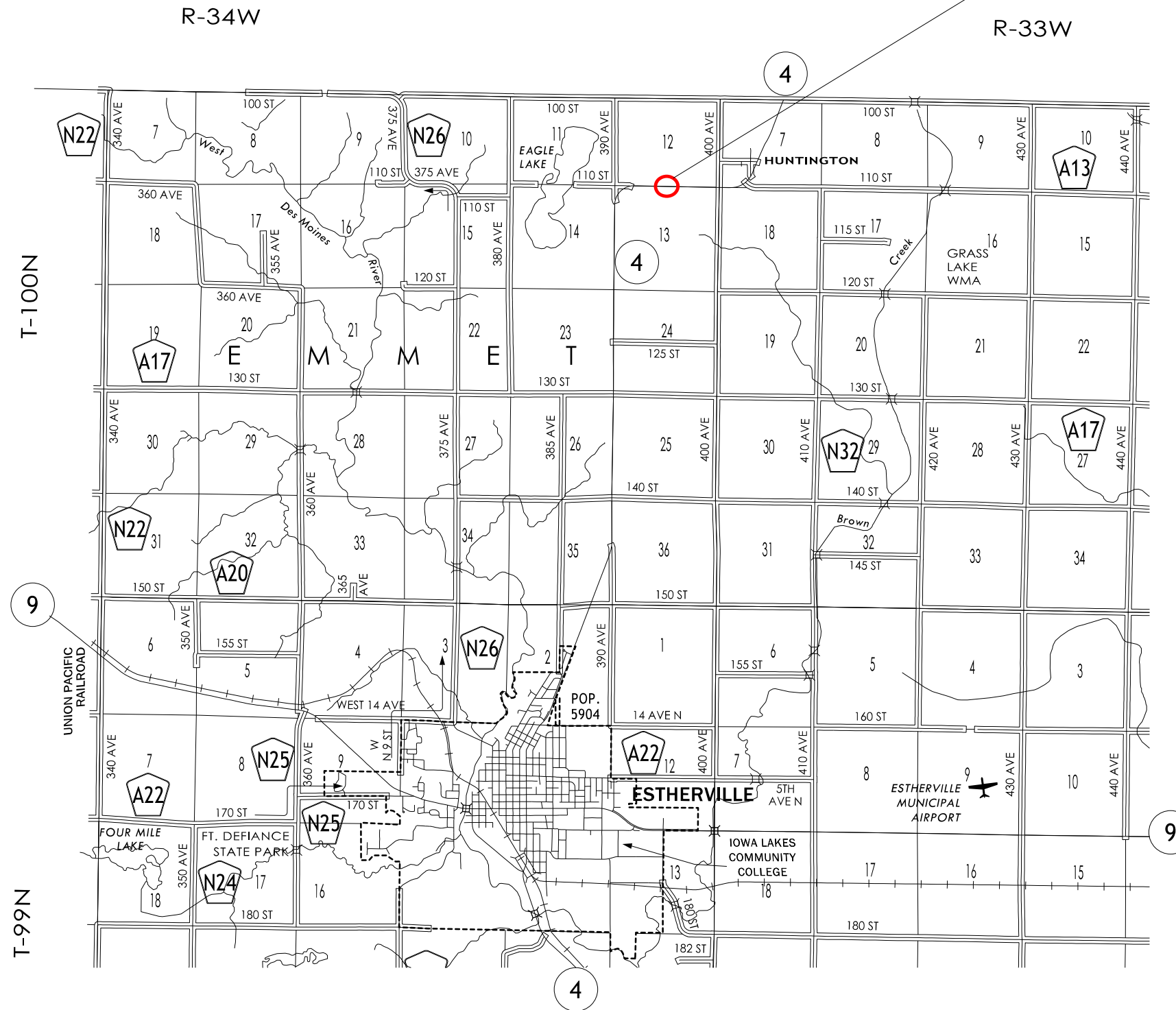



325+00

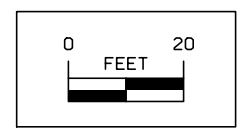
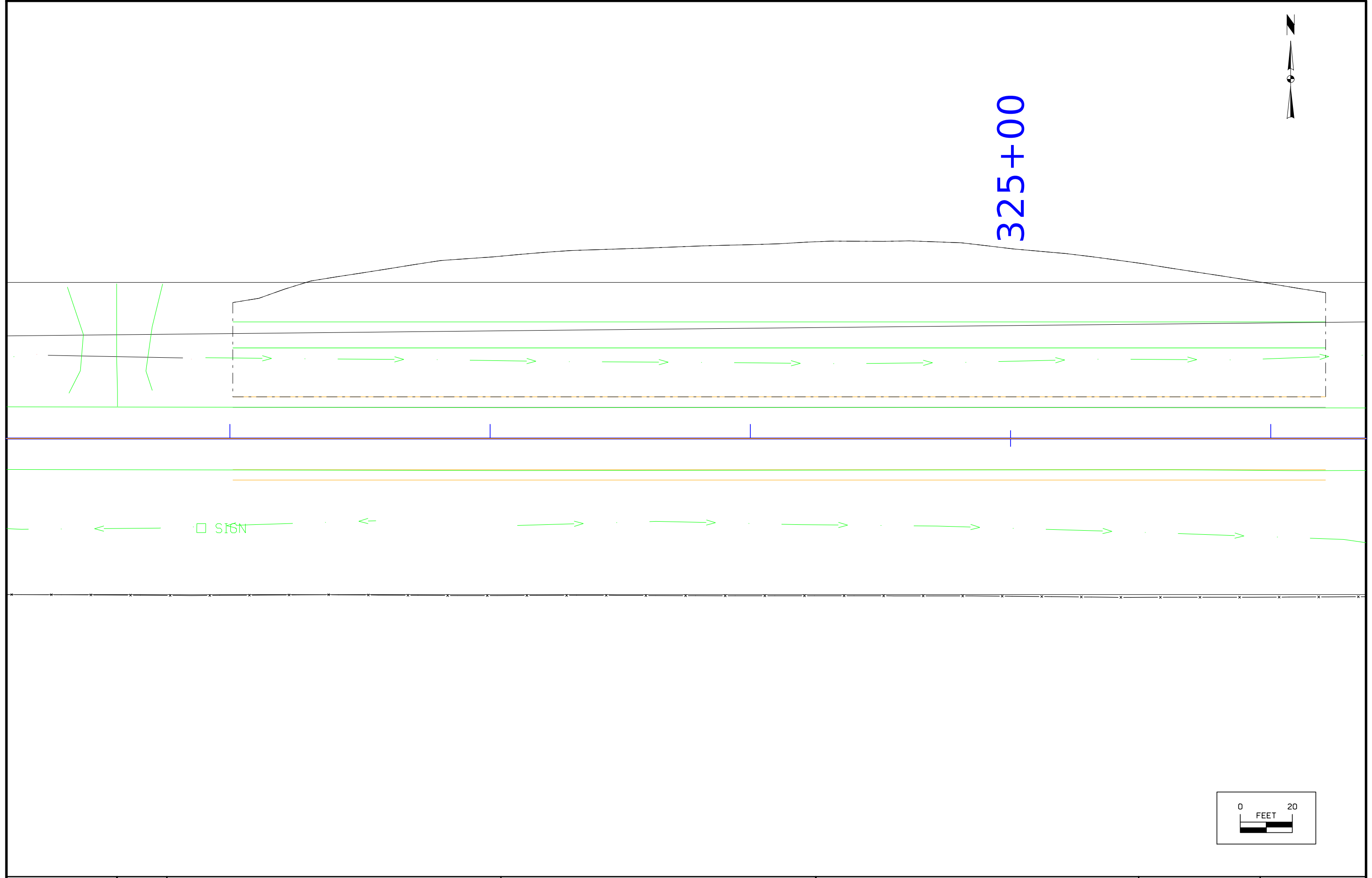

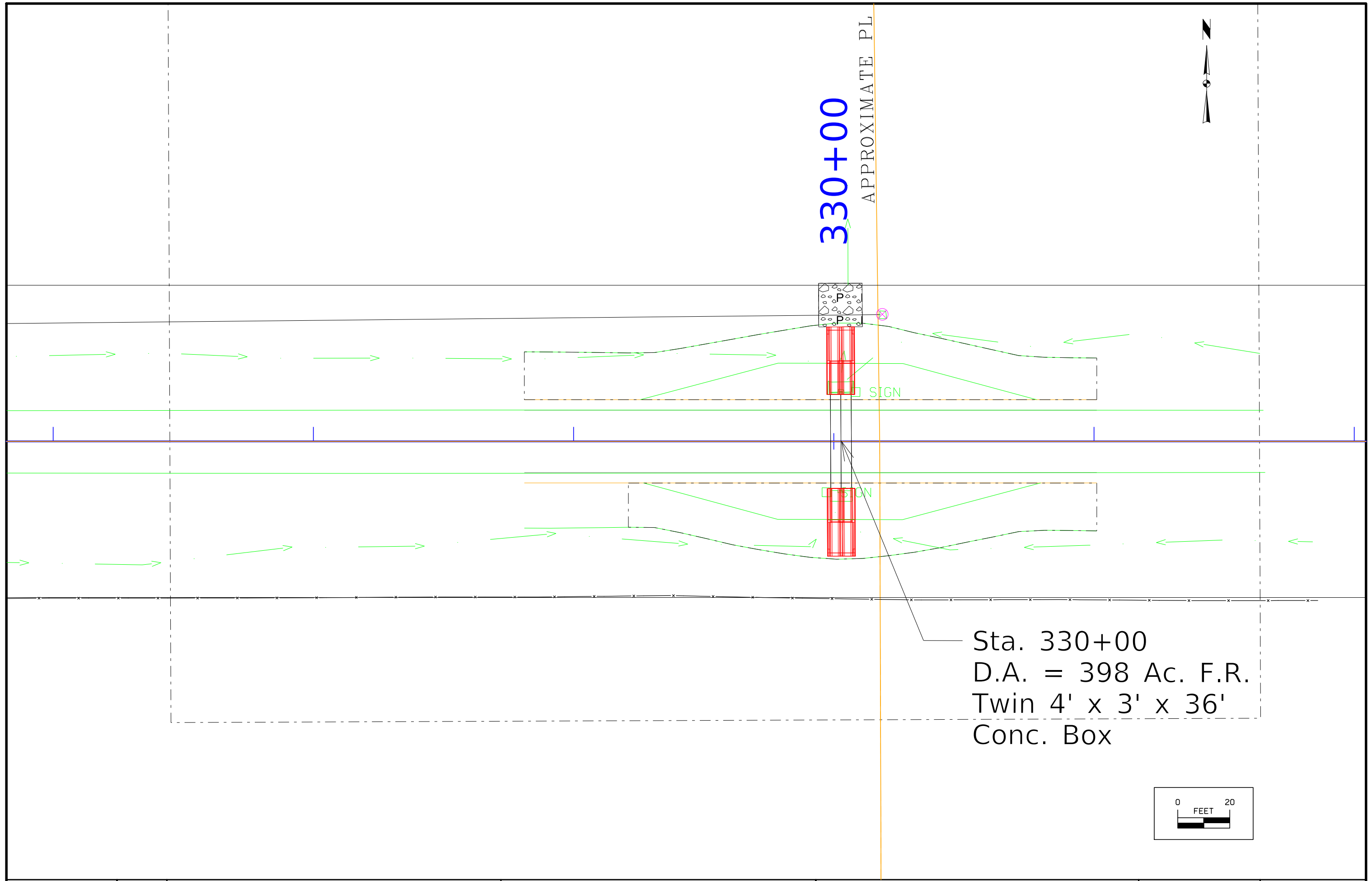

Control Point:

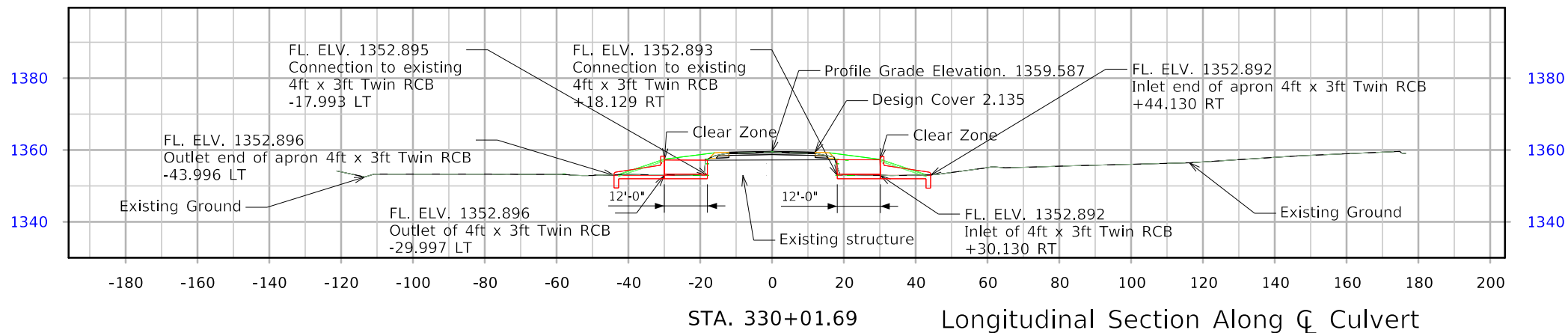

Hydraulic Data

Drainage Area = 398 Acres
Q₅₀ = 329 cfs

Location

IA 4
T-100N R-33W
Section 12 and 13
Emmet Township
Emmet County
Asset ID No. 900575
Latitude 43.4887123°
Longitude -94.8078737°

Traffic Estimate

2023 AADT	930	V.P.D.
2043 AADT	1,116	V.P.D.
20?? DHV	-	V.P.H.
TRUCKS	13.4	%
Total Design ESALs	-	

Sta. 330+00.00
Build 4'-0" x 3'-0" x
12' Rt and 12' Lt
Twin RCB Extension
Skew 0°
Length LT 12'
Length RT 12'
F.L. LT 1352.89
F.L. RT 1352.89
DA 398 (F.R.)
DES # 0124

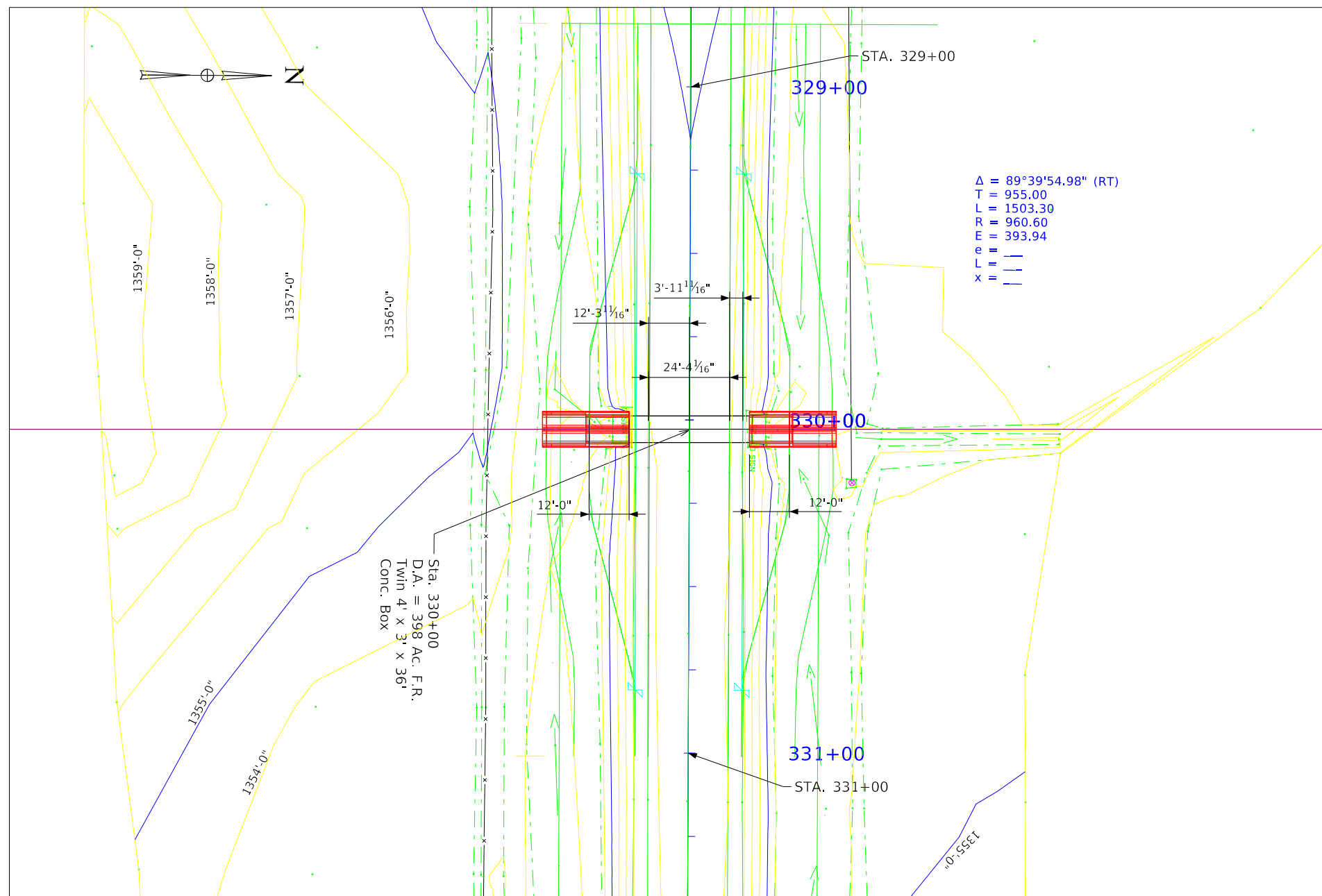

Situation Plan

Hydraulic Design

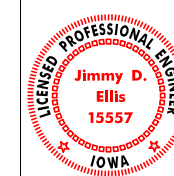

I hereby certify that this engineering document was prepared by me or under my direct personal supervision and that I am a duly licensed Professional Engineer under the laws of the State of Iowa.

Signature: *Jimmy D. Ellis* Date: XX-XX-XXXX
Printed or Typed Name: Jimmy D. Ellis
My license renewal date is December 31, 2024

Pages or sheets covered by this seal: XXXX

Utilities Note:

Utilities shown on this sheet are for information only. See Road Design sheets for utility information.

General Utility Symbols:

- E - Electric Line
- G - Gas Line
- SAN. - Sanitary Sewer
- T - Telephone Line
- W - Water Line
- FO - Fiber Optic Line
- GHP - Gas High Pressure
- ST S - Storm Sewer
- TV - TV
- - Power Poles

Design For 0 Degree
**4' x 3' Twin RCB
Culvert Extension**
Situation Plan
STA. 330+00 (IA 04) Turn-In Date: Jan 2025
Emmet County
IOWA DEPARTMENT OF TRANSPORTATION
Design No. 0124 Design Sheet No. 1 of 1 FHWA/Asset 900575

