

EMMET COUNTY

STPN-004-6(40)--2J-32
RCB Culvert Extension - Twin Box

LETTING DATE
May 21 2024



PLANS OF PROPOSED IMPROVEMENT ON THE
PRIMARY ROAD SYSTEM
EMMET COUNTY
RCB Culvert Extension - Twin Box
0.24 mi E of 390th Ave to
0.54 mi E of 390th Ave

SCALES: As Noted

INDEX OF SHEETS	
No.	DESCRIPTION
A Sheets	Title Sheets
A.1	Title Sheet
A.2	Location Map Sheet
D Sheets	Mainline Plan Sheets
* D.1 - 2	IA 4
W Sheets	Mainline Cross Sections
* W.1 - 10	Mainline Cross Sections
	* Color Plan Sheets

H Sheets

Refer to the Proposal Form for list of applicable specifications.

Value Engineering Saves. Refer to Article 1105.14 of the Specifications.



For Project Location Map
Refer to Sheet No. A.2

DESIGN DATA RURAL			
2023	AADT	930	V.P.D.
2043	AADT	1,116	V.P.D.
2043	DHV	--	V.P.H.
	TRUCKS	13.4	%
	Total		
	Design ESALs	--	

REVISIONS

TOTAL

17

PROJECT IDENTIFICATION NUMBER

32-0046-040

PROJECT NUMBER

STPN-004-6(40)--2J-32

R.O.W. PROJECT NUMBER

STPN-004-6(36)--2J-32

PRELIMINARY PLANS

Subject to change by final design.

Revised D5 PLAN
Date: 01/03/24

FILE NO.

ENGLISH

DESIGN TEAM District 3

EMMET COUNTY

PROJECT NUMBER STPN-004-6(40)--2J-32

SHEET NUMBER A.1

SYSTEMTIME SYSTEMDATE USERNAME DGNSPEC

PROJECT LOCATION
 STA. 322+00 to 331+00
 MP 144.32 to 144.49

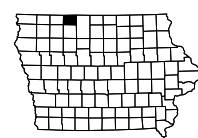
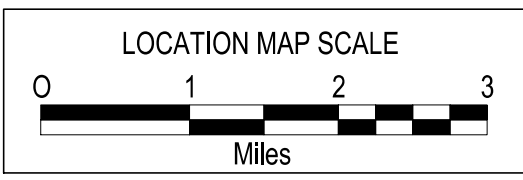
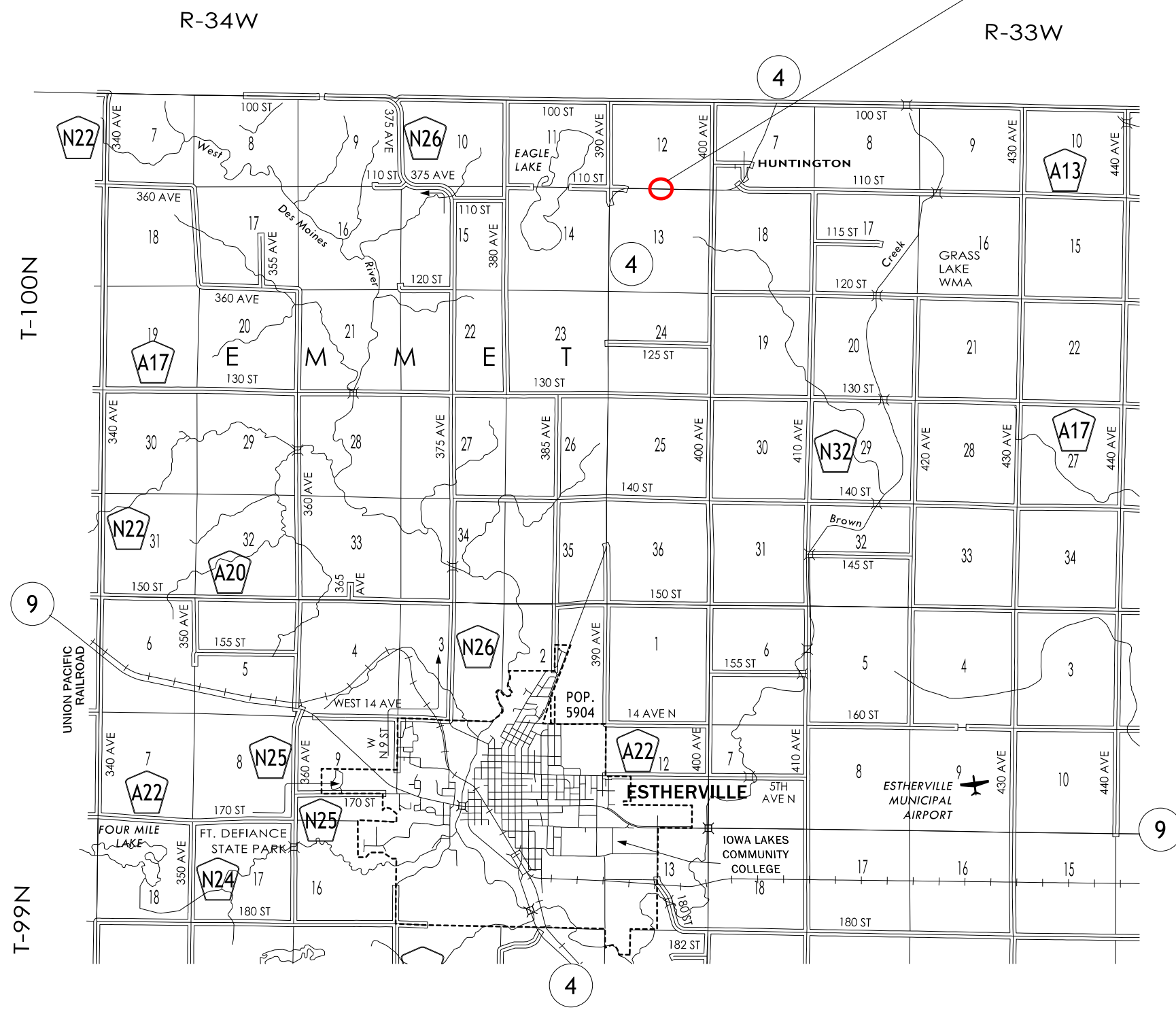

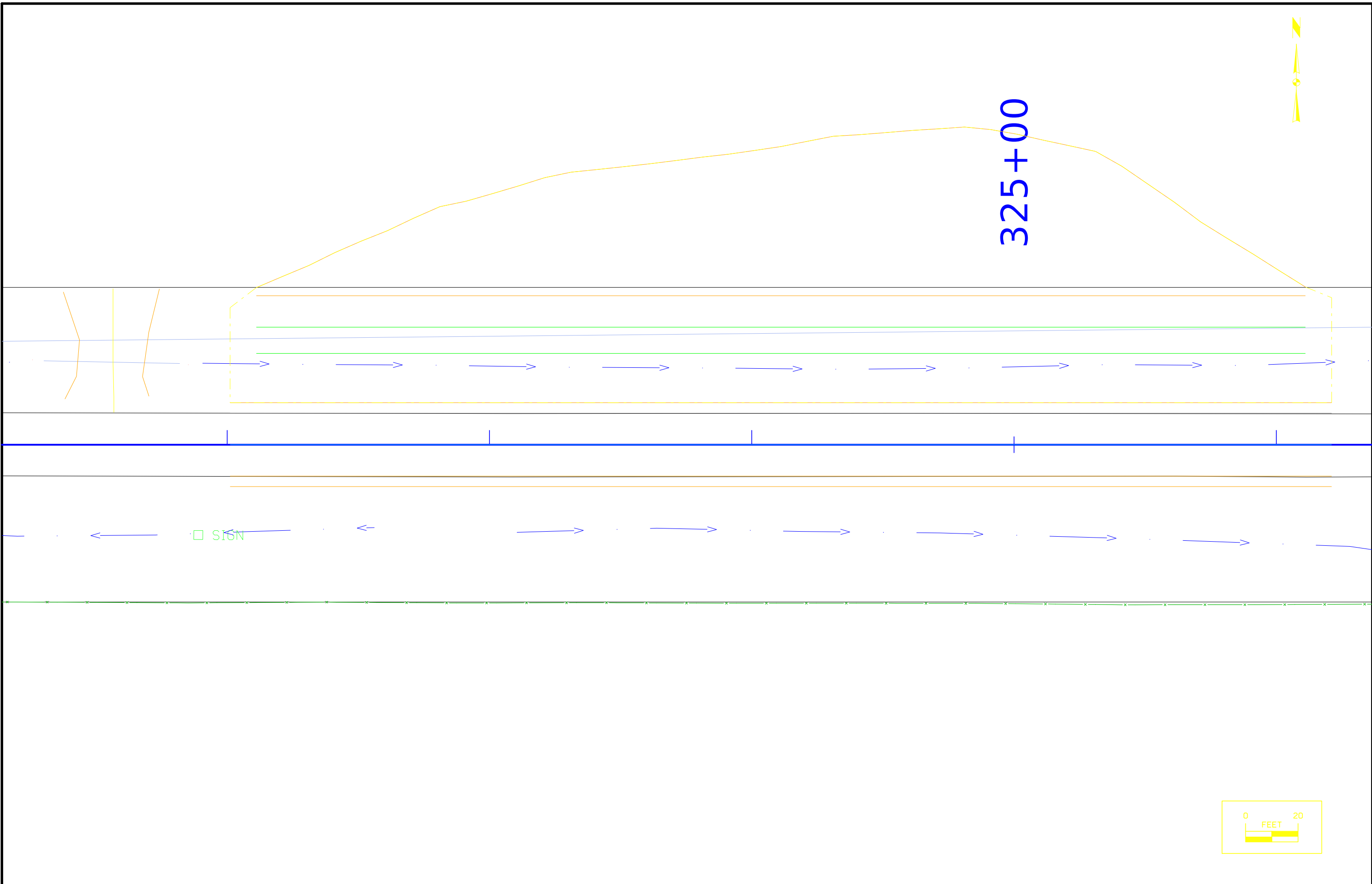

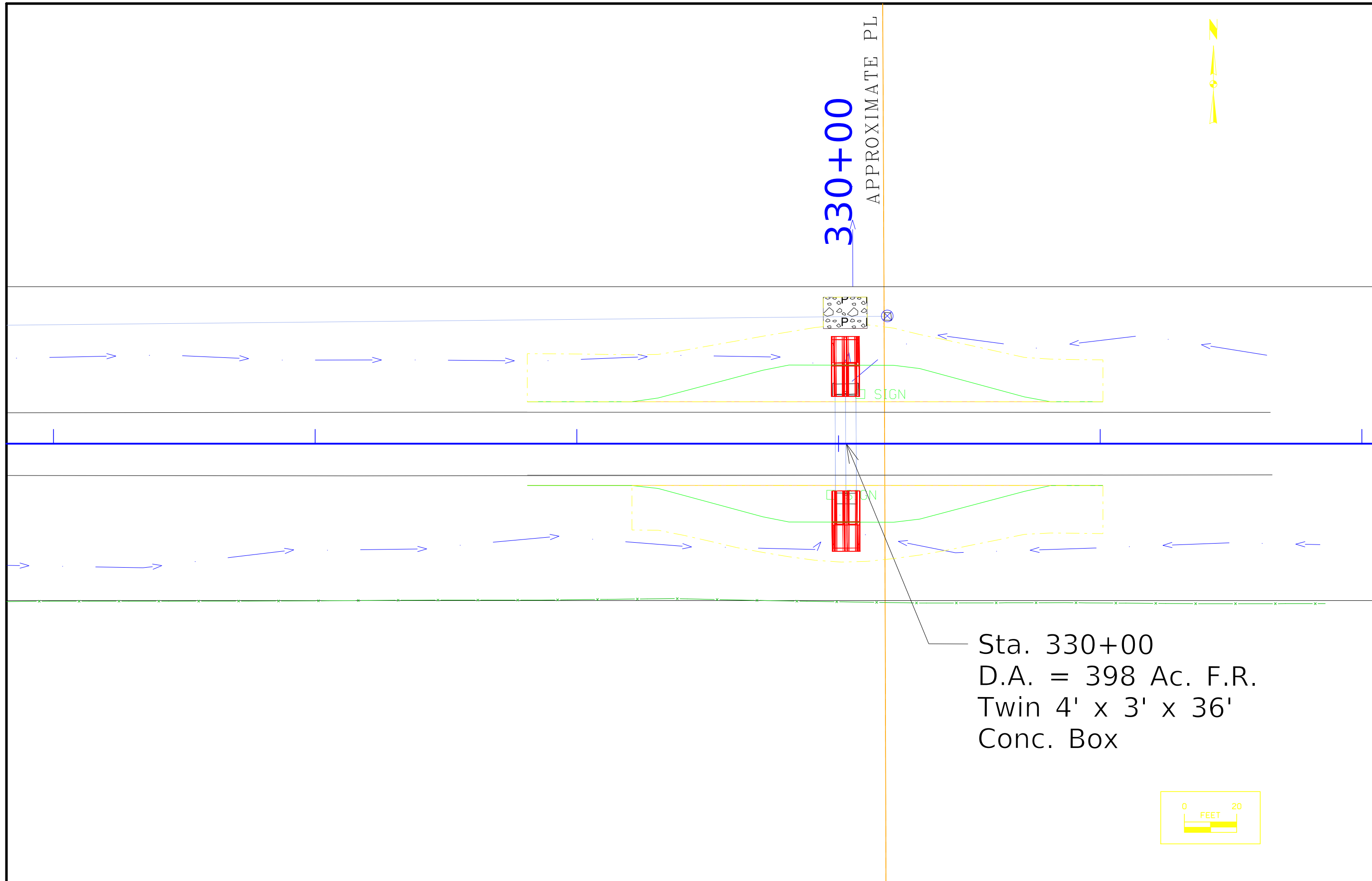

Sta. 330+00
 D.A. = 398 Ac. F.R.
 Twin 4' x 3' x 36'
 Conc. Box

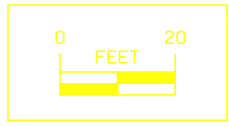

1

Judy K. Christensen
Jackie L. Christensen

TEMPORARY EASEMENT FOR
SNOW BORROW

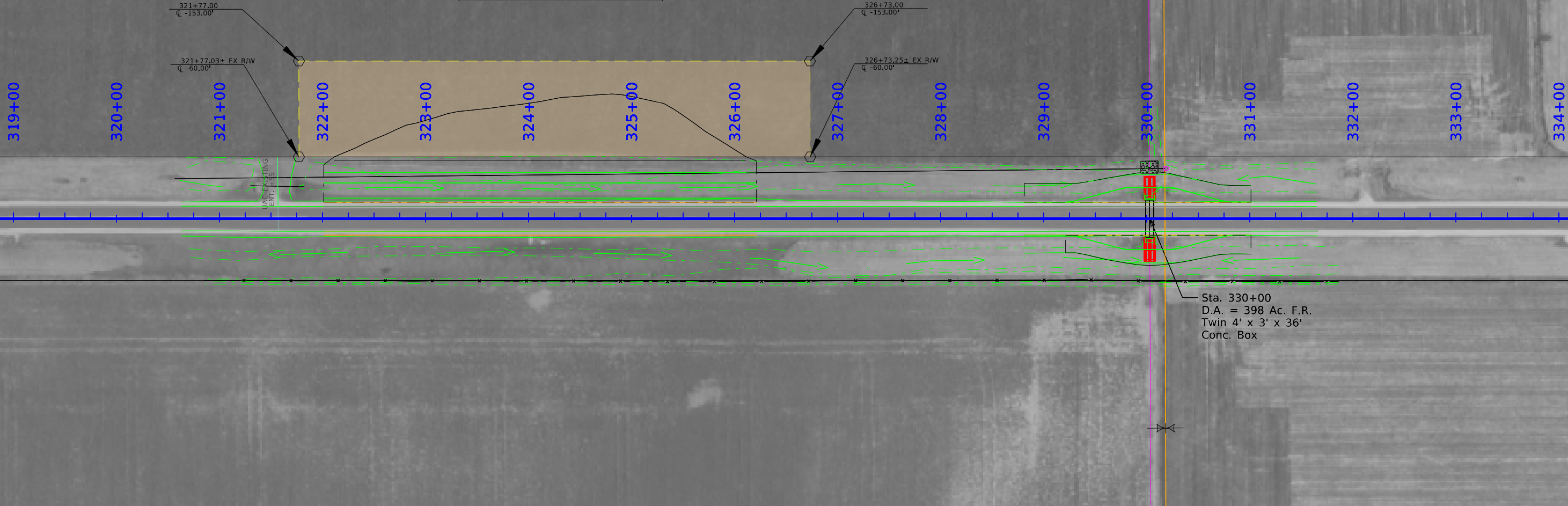

Sta. 330+00
D.A. = 398 Ac. F.R.
Twin 4' x 3' x 36'
Conc. Box

Right of Way Design Information	
THIS SHEET INCLUDED FOR INFORMATION ONLY	
ROW Team: Larson / Hinrichsen	
ROW #: STPN-004-6(36)--2J-32	
Plan Date: 11/10/2023	
Color Legend:	
	Property Lines
	Temporary Easement
	Permanent Acquisition

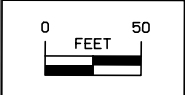

Control Point:

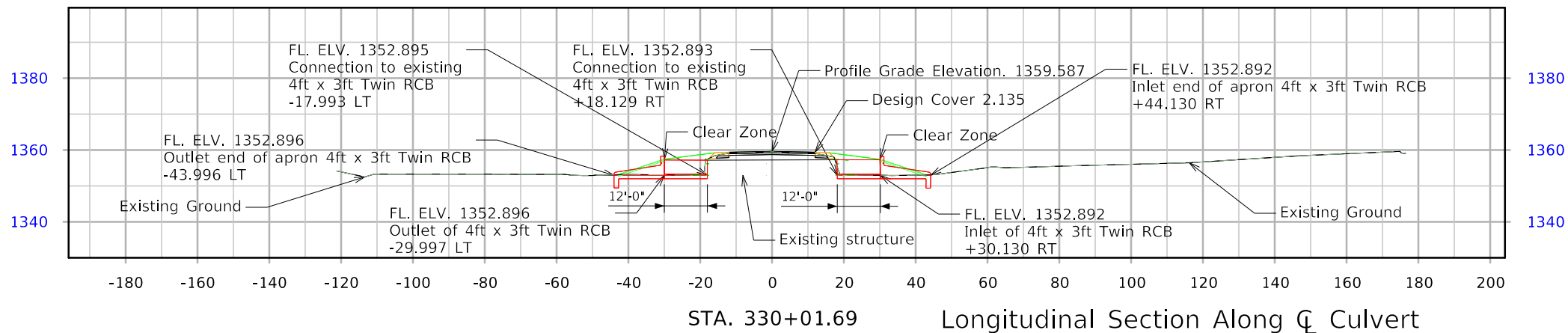

Hydraulic Data

Drainage Area = 398 Acres
 $Q_{50} = 329$ cfs

Location

IA 4
 T-100N R-33W
 Section 12 and 13
 Emmet Township
 Emmet County
 Asset ID No. 900575
 Latitude 43.4887123°
 Longitude -94.8078737°

Traffic Estimate

2023 AADT	930 V.P.D.
2043 AADT	1,116 V.P.D.
20?? DHV	- V.P.H.
TRUCKS	13.4 %
Total Design ESALs	-

Sta. 330+00.00
 Build 4'-0" x 3'-0" x
 12' Rt and 12' Lt
 Twin RCB Extension
 Skew 0°
 Length LT 12'
 Length RT 12'
 F.L. LT 1352.89
 F.L. RT 1352.89
 DA 398 (F.R.)
 DES # 0124

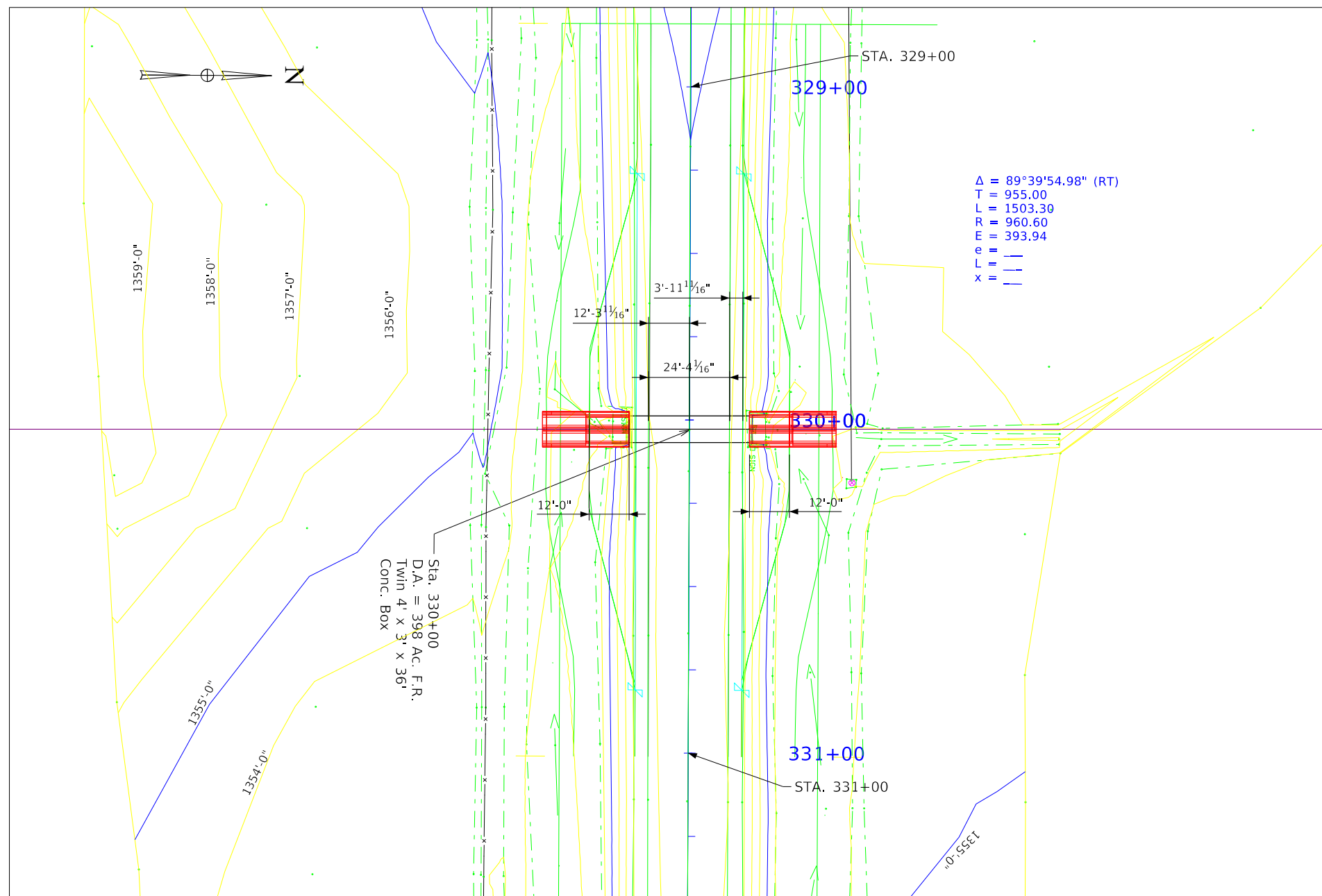

Situation Plan

Hydraulic Design

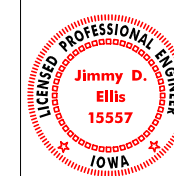

I hereby certify that this engineering document was prepared by me or under my direct personal supervision and that I am a duly licensed Professional Engineer under the laws of the State of Iowa.

Signature: *Jimmy D. Ellis* Date: XX-XX-XXXX
 Printed or Typed Name: Jimmy D. Ellis
 My license renewal date is December 31, 2024

Pages or sheets covered by this seal: XXXX

Utilities Note:

Utilities shown on this sheet are for information only. See Road Design sheets for utility information.

General Utility Symbols:

- E - Electric Line
- G - Gas Line
- SAN. - Sanitary Sewer
- T - Telephone Line
- W - Water Line
- FO - Fiber Optic Line
- GHP - Gas High Pressure
- ST S - Storm Sewer
- TV - TV
- - Power Poles

Design For 0 Degree
**4' x 3' Twin RCB
 Culvert Extension**
 Situation Plan
 STA. 330+00 (IA 04) Turn-In Date: Jan 2025
Emmet County
 IOWA DEPARTMENT OF TRANSPORTATION
 Design No. 0124 Design Sheet No. 1 of 1 FHWA/Asset 900575

IA 4 Preliminary D05

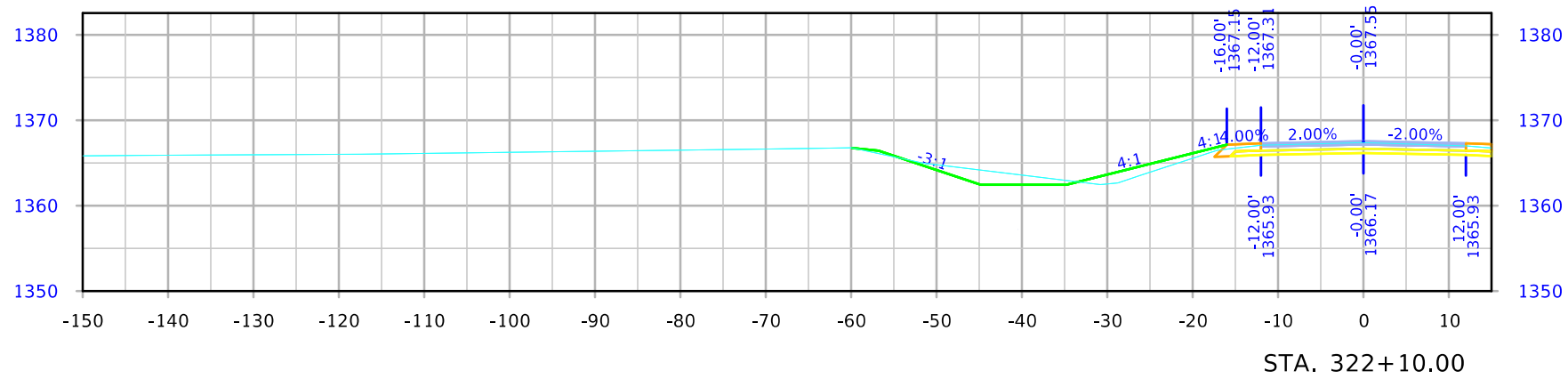
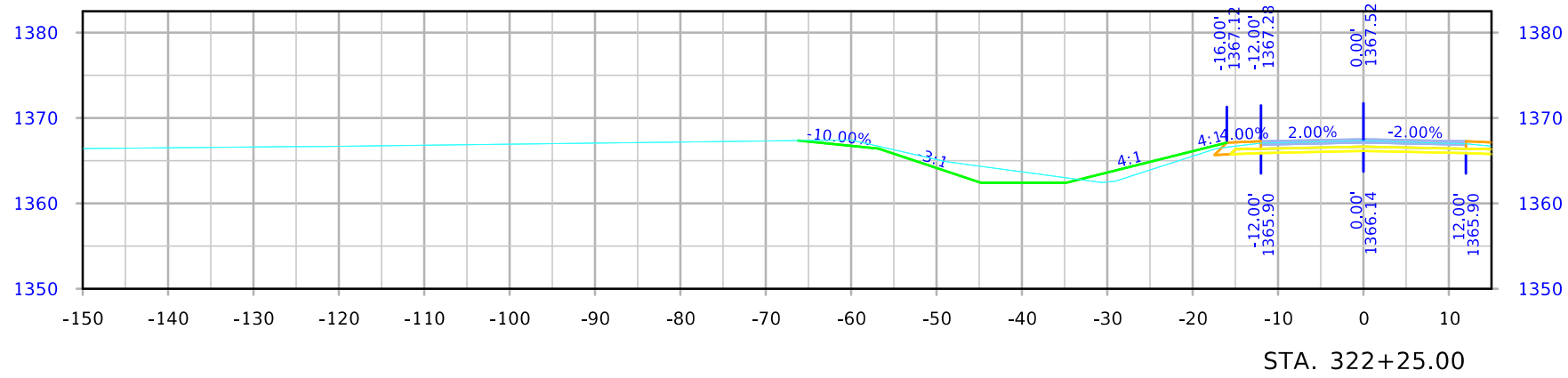
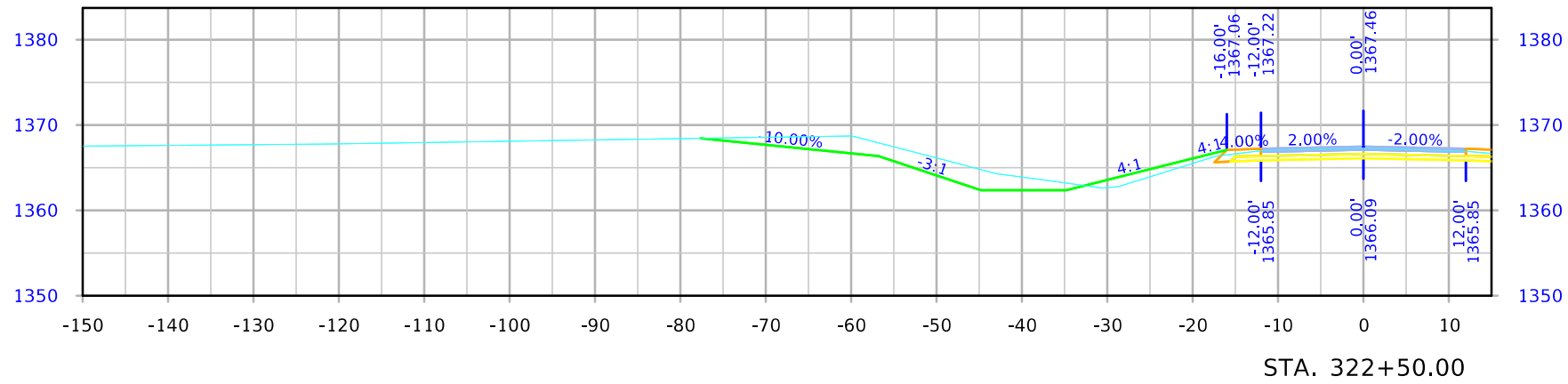

IA 4 Preliminary D05

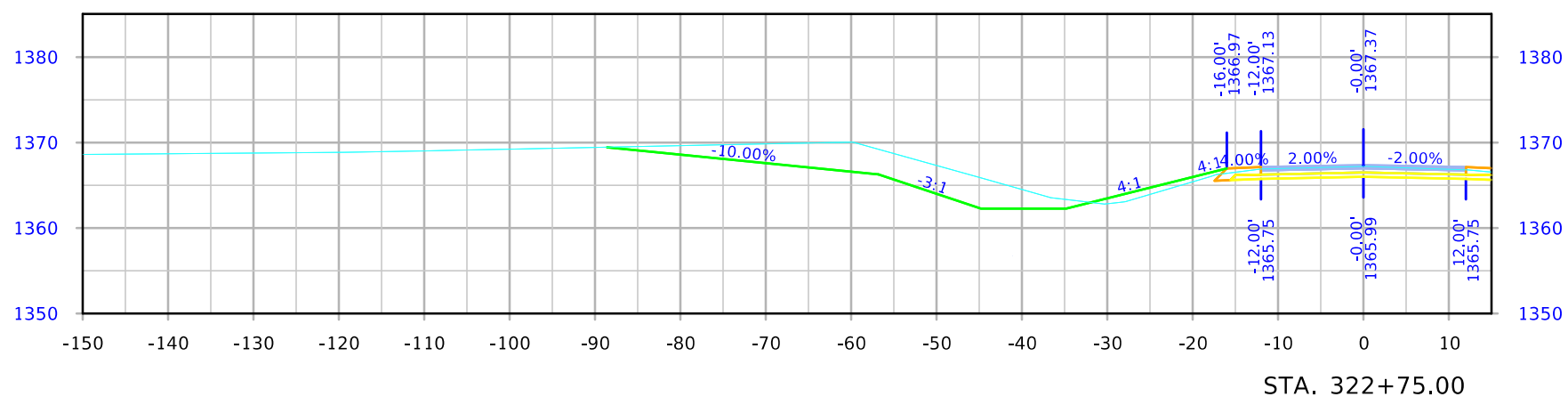
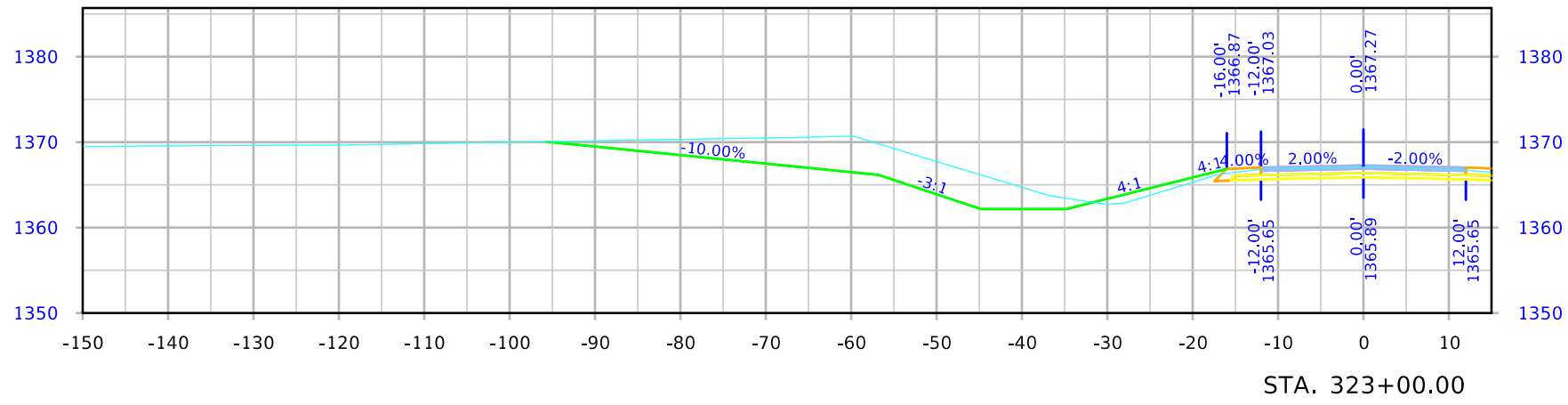
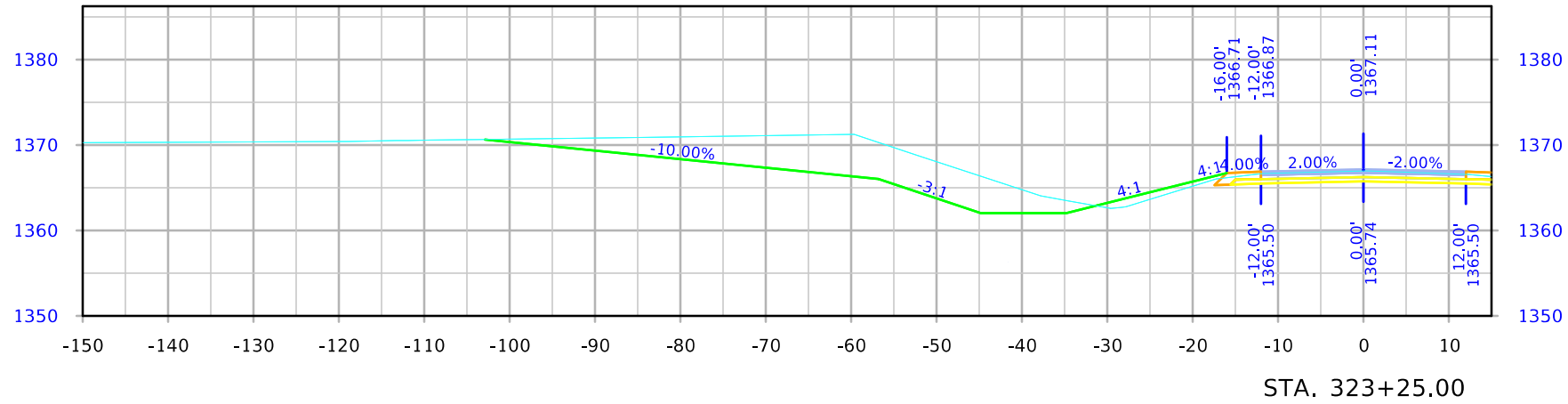

IA 4 Preliminary D05

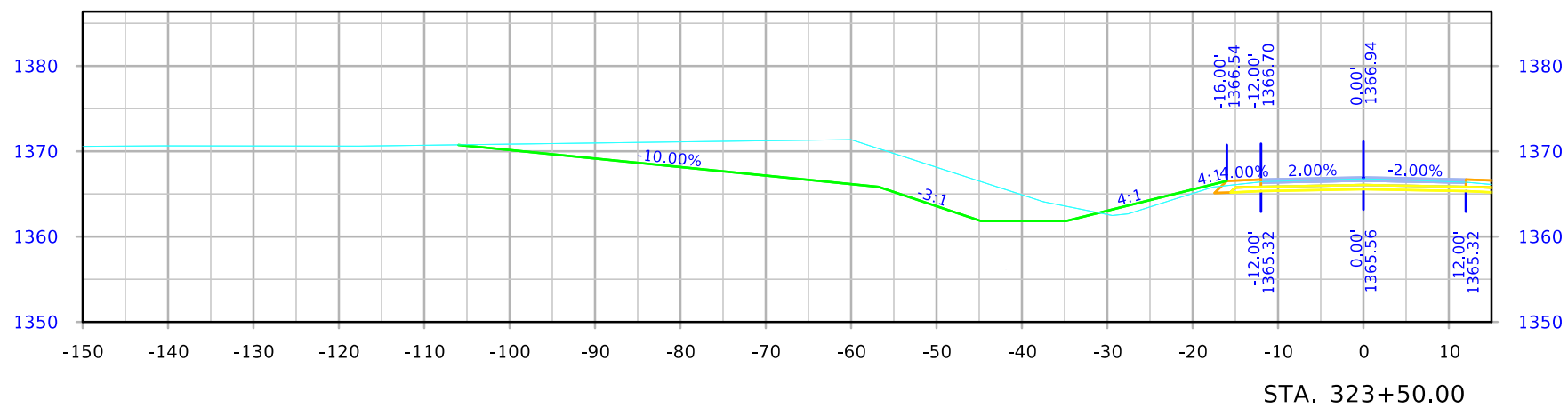
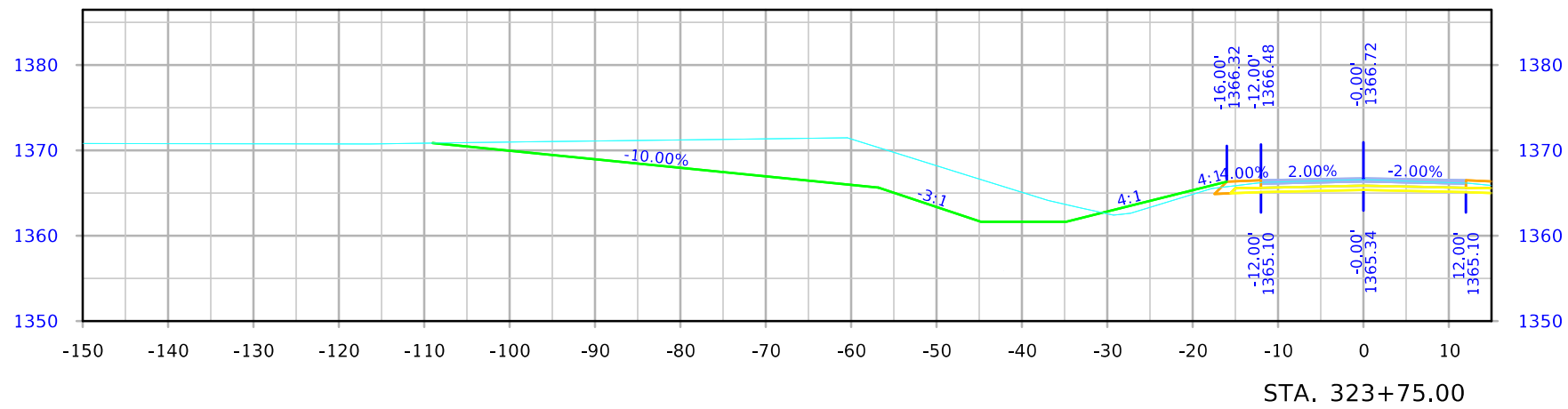
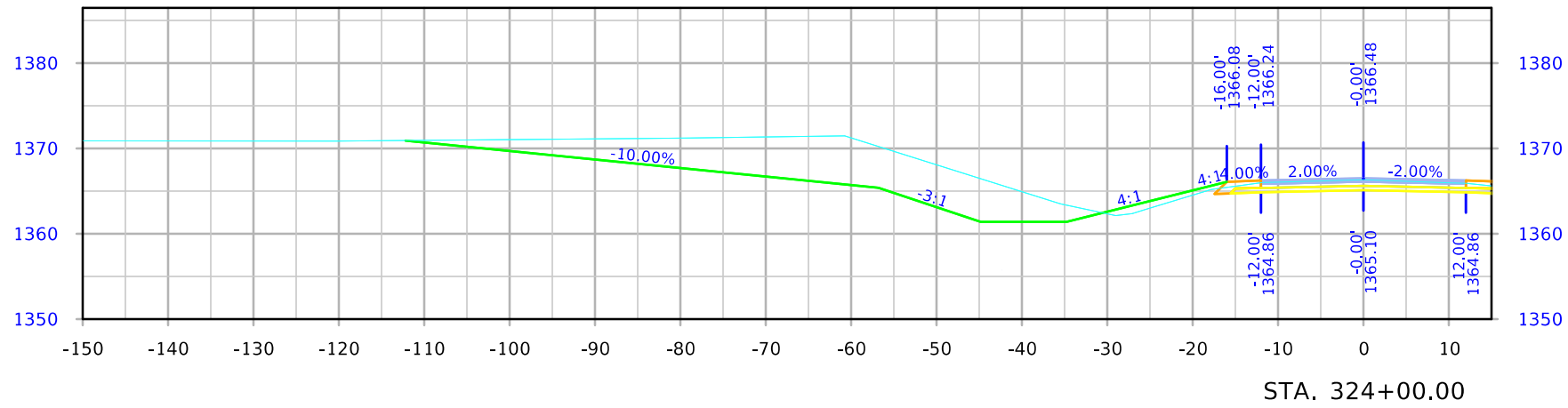

IA 4 Preliminary D05

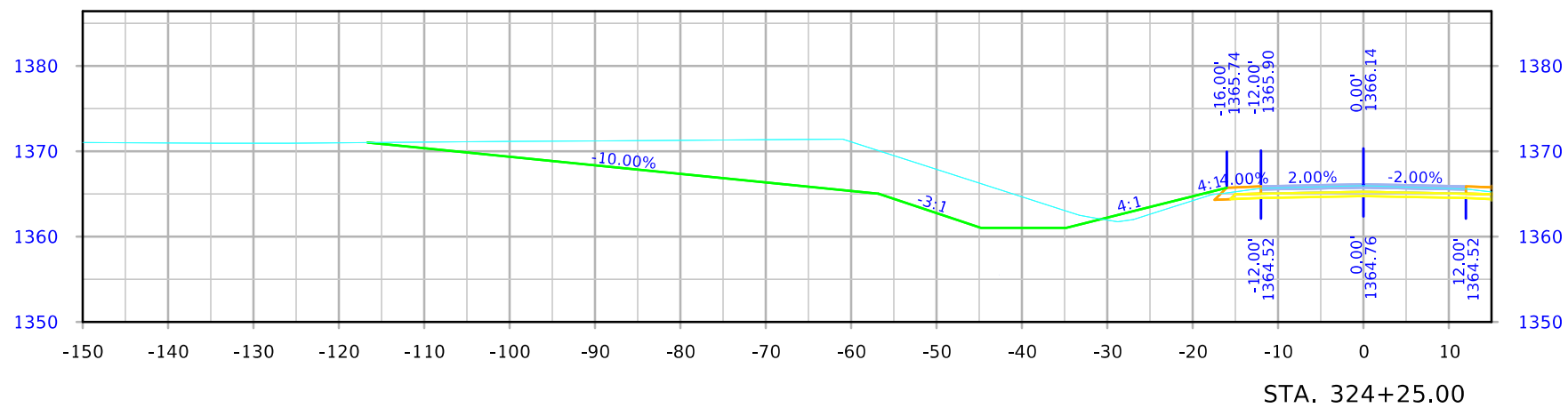
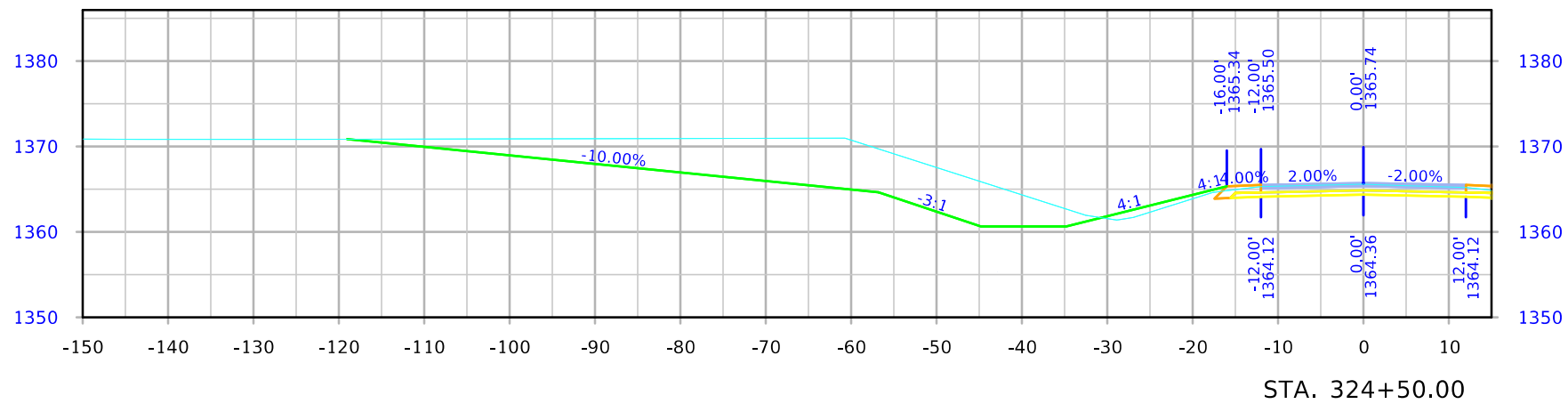
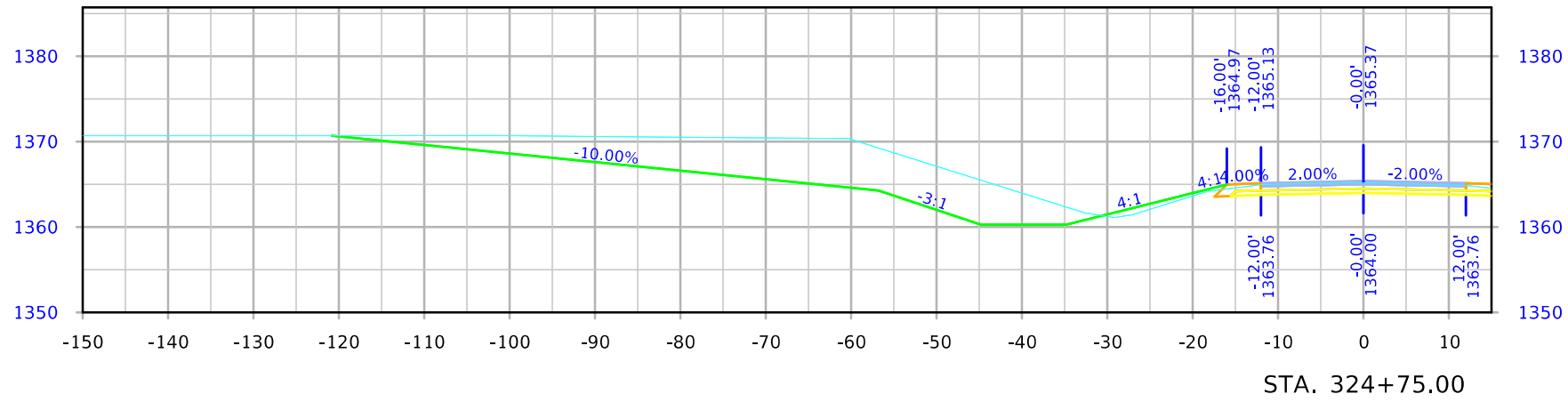

IA 4 Preliminary D05

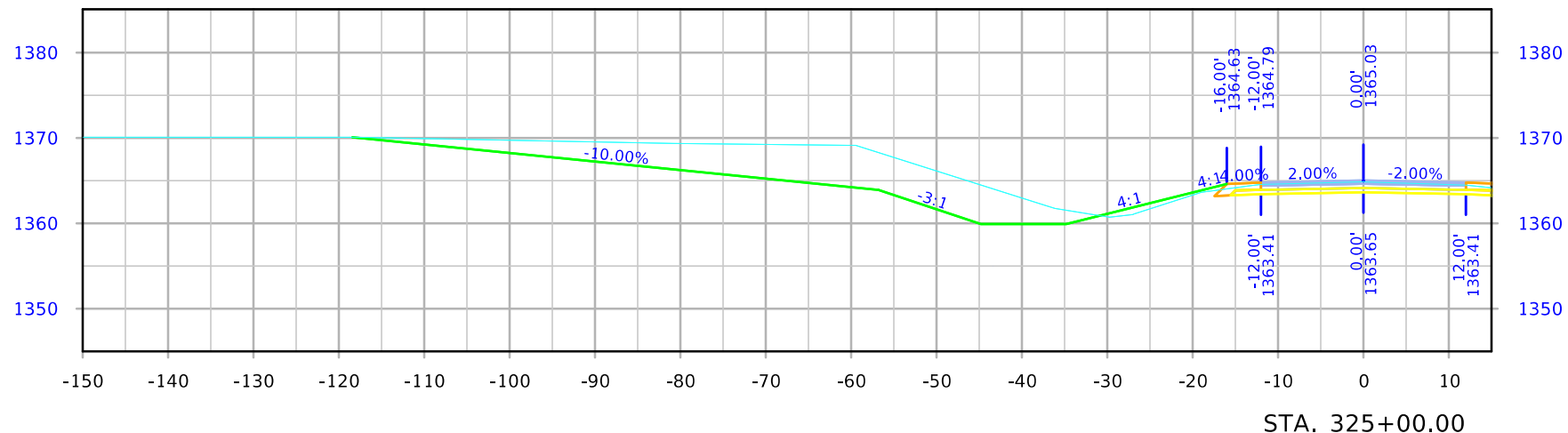
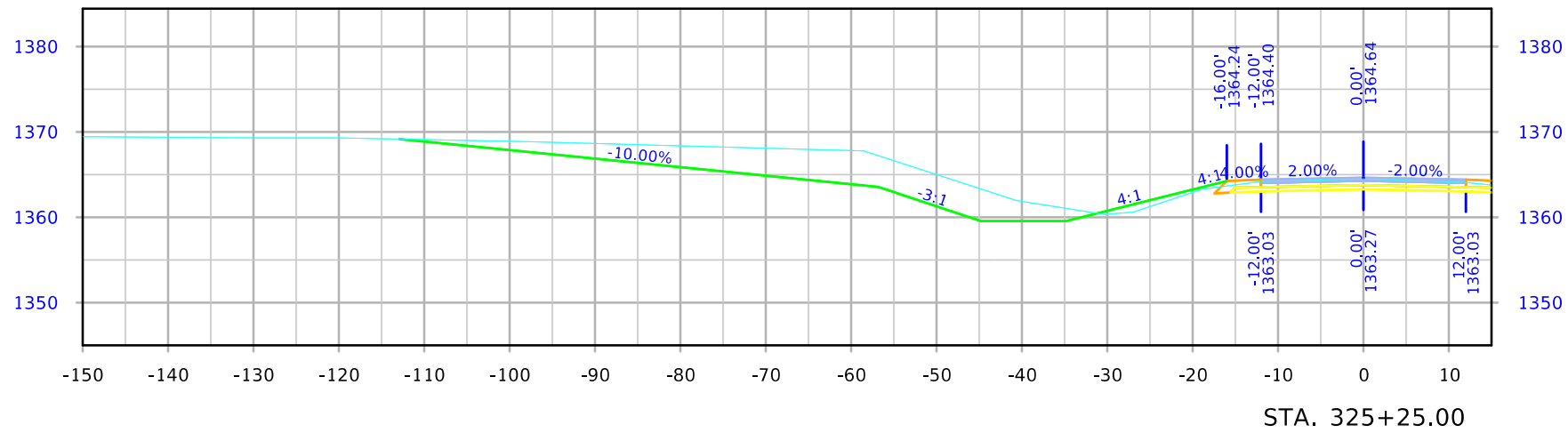
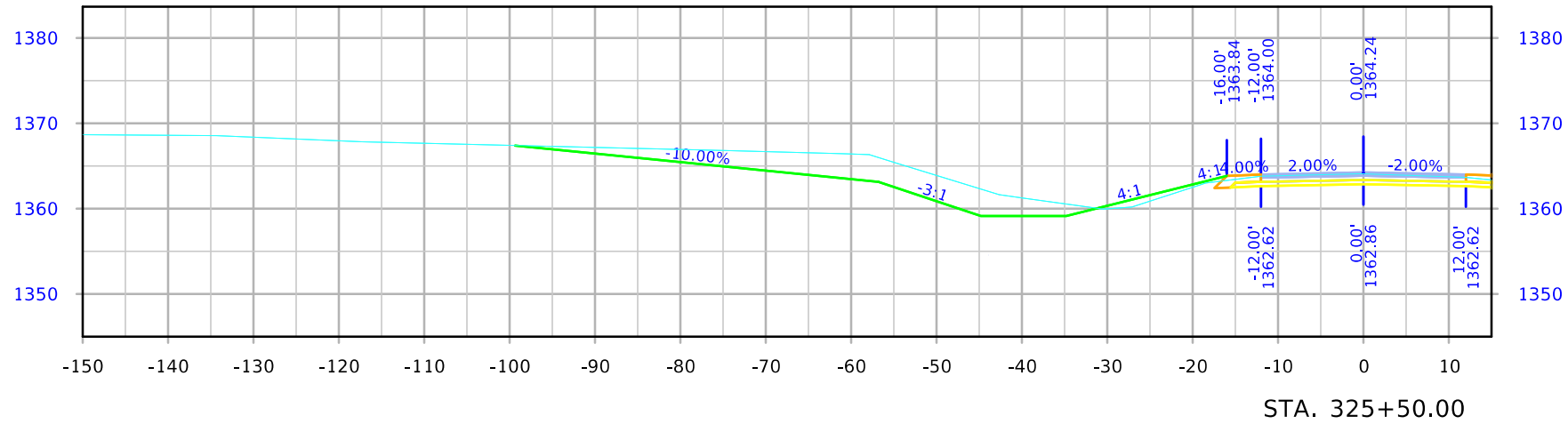

IA 4 Preliminary D05

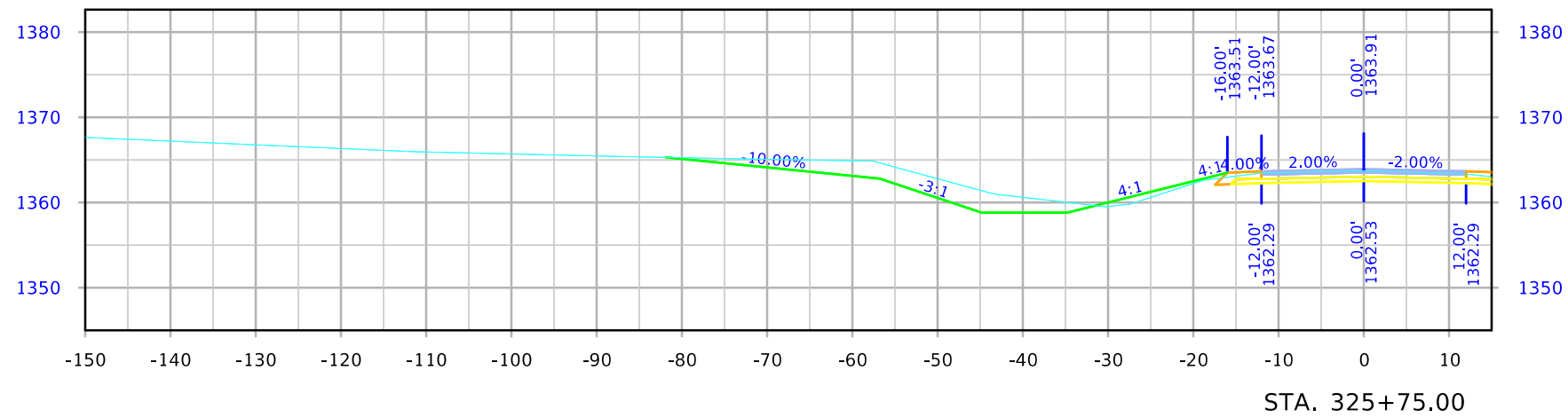
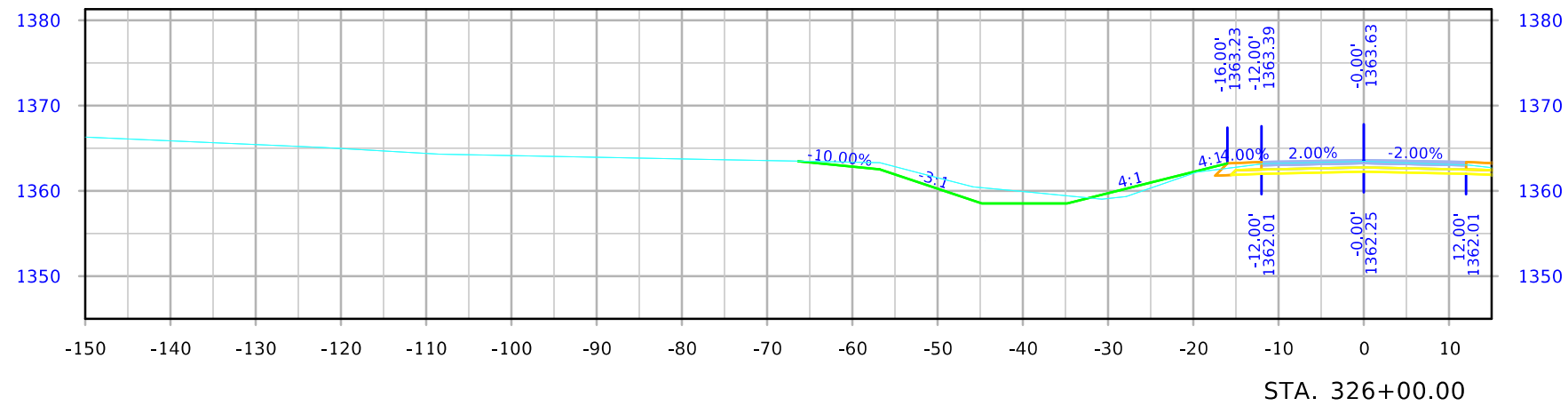
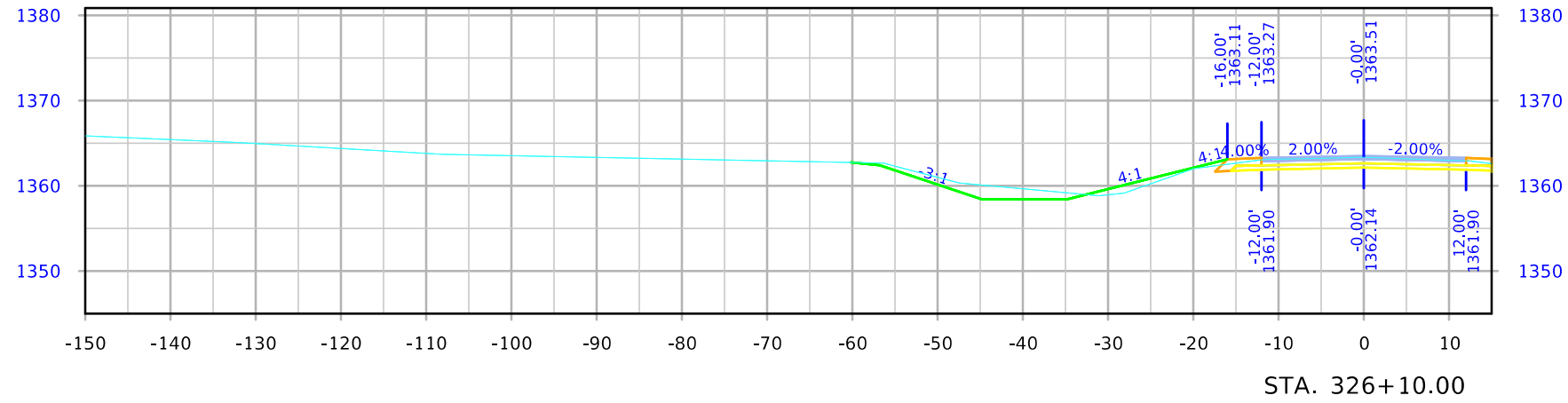

Preliminary IA 4 D05

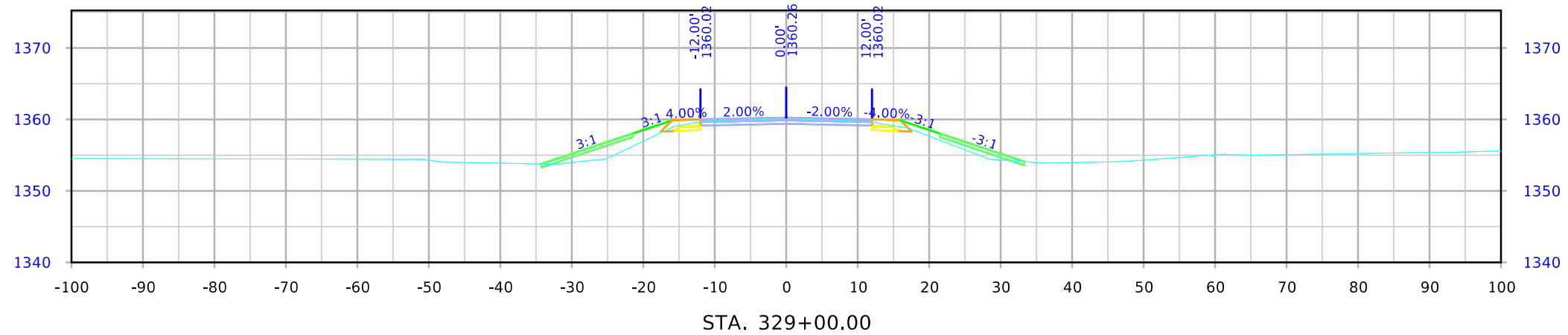
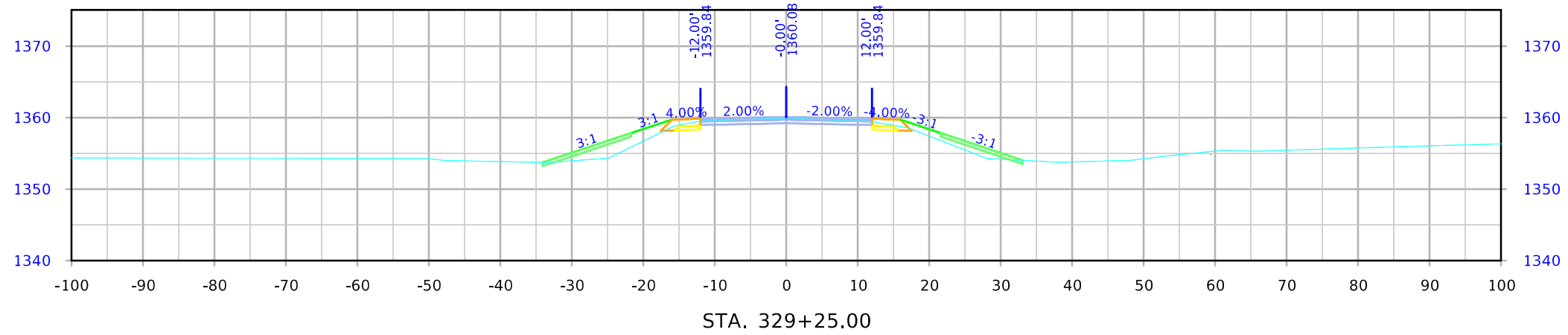

Preliminary IA 4 D05

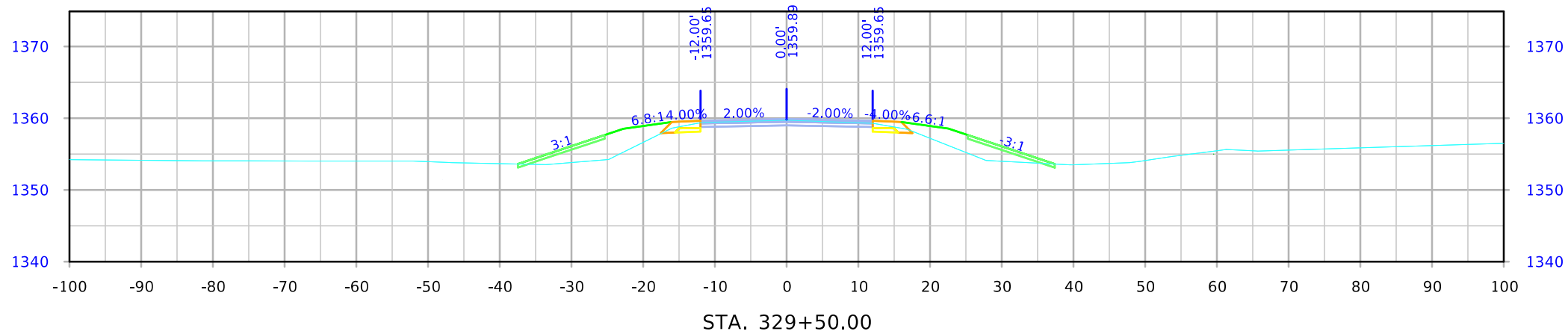
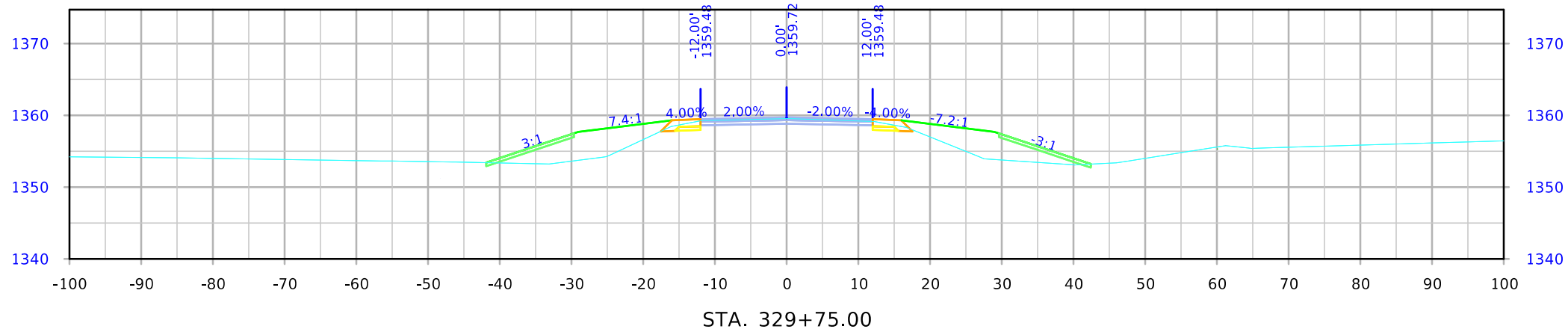
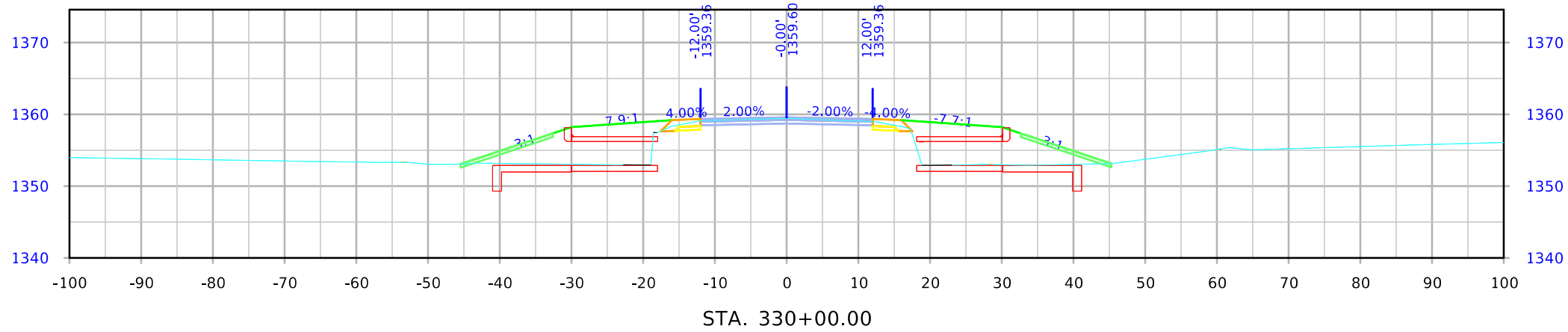

Preliminary IA 4 D05

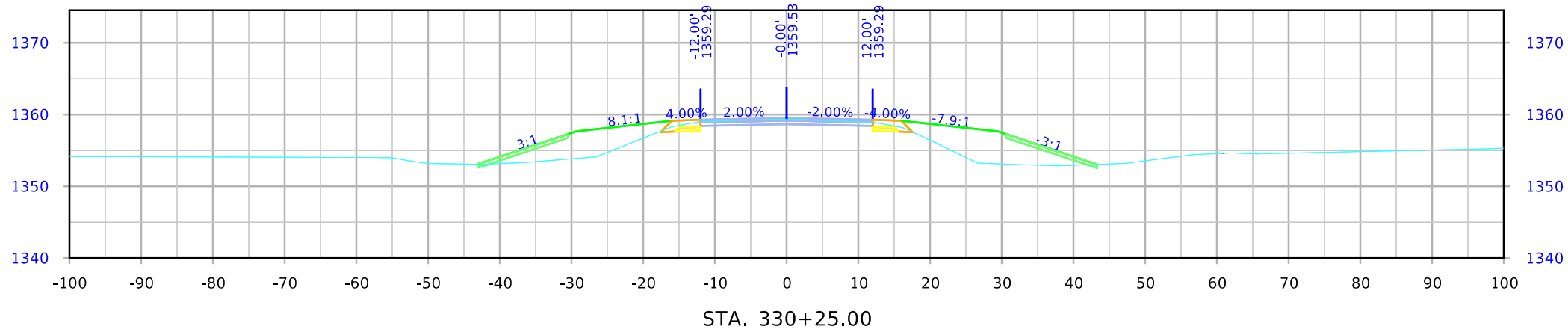
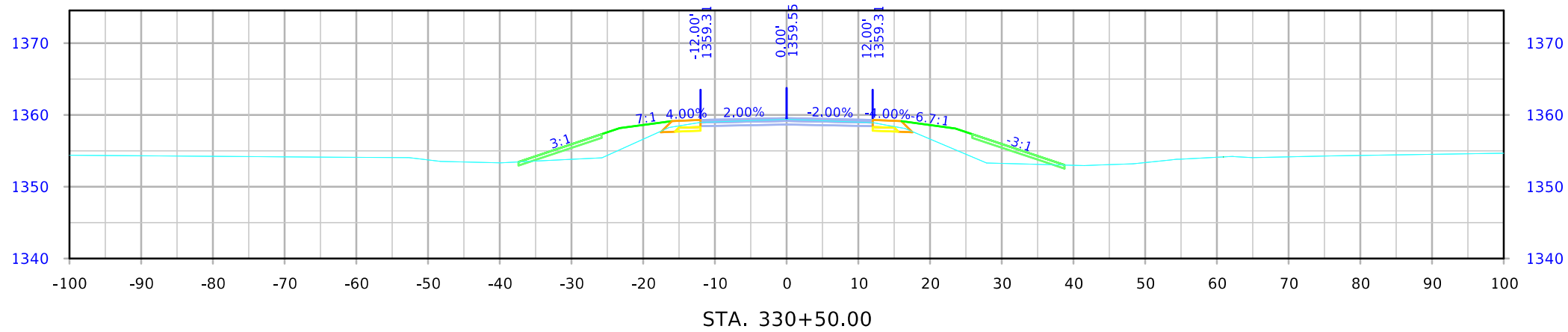
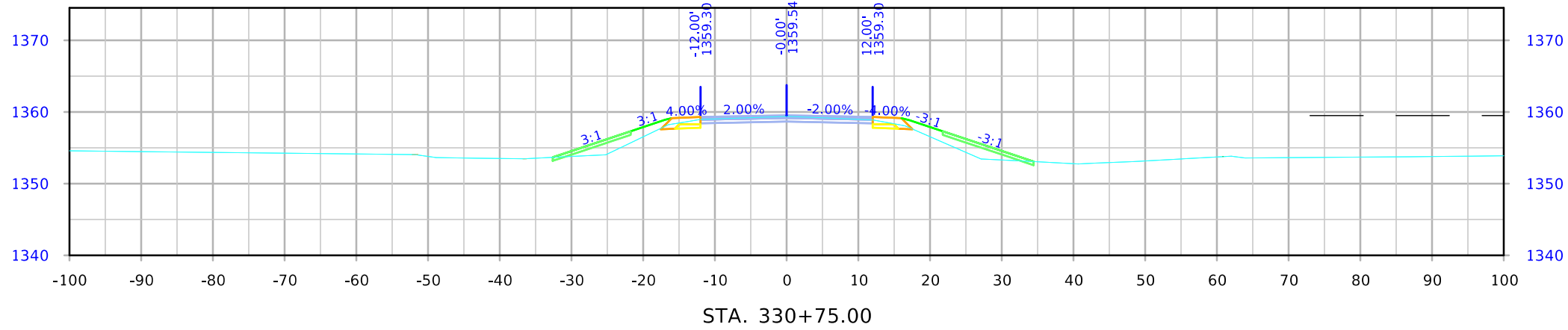

Preliminary IA 4 D05

